



**THE DATASHEET OF
CLS62NP-100NC**



Type: CLS62
◆ Product Description

- 7.3×7.1mm Max.(L×W), 2.5mm Max. Height.
- Inductance Range: 10 μ H~39mH, Rated current range: 37mA~700mA
- In addition to the typical versions of parameters shown here, custom designs are available to meet your exact requirements.

◆ Feature

- Magnetically shielded construction.
- Ideally used in power supply of DSC, DVC, Note PC .
- RoHS Compliance

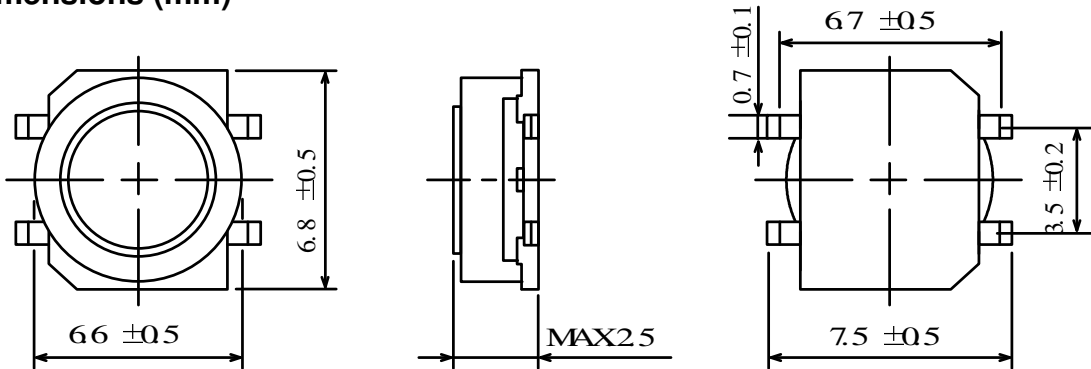
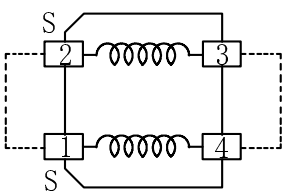
◆ Dimensions (mm)

◆ Schematics (Bottom)

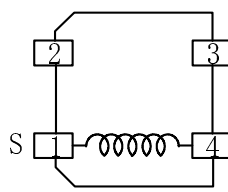
10 μ H~22 μ H
270 μ H~390 μ H



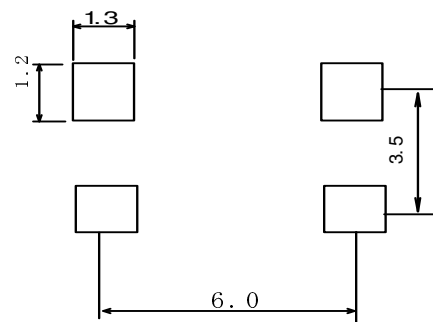

27 μ H~220 μ H
470 μ H~3.9mH

“ S ” indicates winding start.

◆ Land Pattern (mm)

Looking for pricing, stock, or lifecycle information?

Click below to explore more details on WIN SOURCE:

-  [View CLS62NP-100NC on WIN SOURCE](#)
-  [Sumida America Components Inc. Information](#)

Optimize Your Supply Chain with WIN SOURCE Solutions

-  Global Sourcing Solution
-  Obsolete Management
-  Cost Control Management
-  Shortage Management
-  Alternative Solution
-  Excess Inventory Management