



**THE DATASHEET OF
901-10003**



NOTES:

1. MATERIAL & FINISH:
 BODY = BRASS, GOLD PLATED
 CONTACT = BERYLLIUM COPPER, GOLD PLATED
 INSULATOR = PTFE

2. DO NOT SCALE THIS DRAWING.

901-10003

DRAWING NO.

REV

THIRD ANGLE PROJ.



A

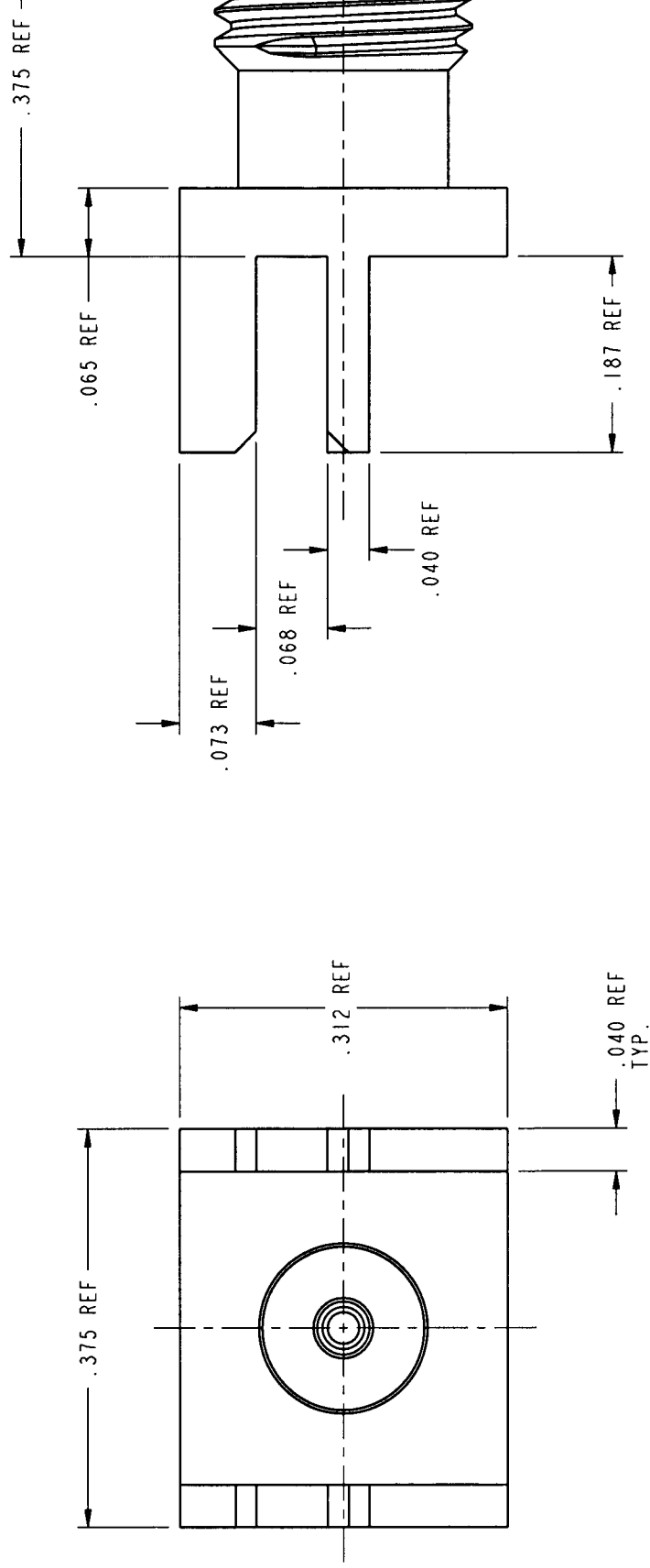

UNLESS OTHERWISE SPECIFIED, DIMENSIONS ARE IN INCHES AND TOLERANCES ARE:
 2 PLACE DECIMAL ±.015 (0,381 mm)
 3 PLACE DECIMAL ±.005 (0,127 mm)
 ANGLES ± 1°

NOTICE - These drawings, specifications, or other data (1) are, and remain the property of Amphenol Corp. (2) must be returned upon request; and (3) are confidential and not to be disclosed to any person other than those to whom they are given by Amphenol Corp. The furnishing of these drawings, specifications, or other data by Amphenol Corp., or to any other person to anyone for any purpose is not to be regarded by implication or otherwise in any manner licensing, granting rights or permitting such holder or any other person to manufacture, use or sell any product, process or design, patented or otherwise, that may in any way be related to or disclosed by said drawings, specifications, or other data.

MATERIAL

REFERENCE
 EAR 967064-1
 GEN# ASSYF34_SMA
 EAR 111-962299 & 102-967531-0
 615X-1143-100

DRAWN

C. McGRATH

DATE

26-Apr-00

ENGINEER

P. BRENZEL

DATE

26-Apr-00

APPROVED

DATE

5/2/00

CAD FILE

I:\SMA\901-10003

Looking for pricing, stock, or lifecycle information?

Click below to explore more details on WIN SOURCE:

[View 901-10003 on WIN SOURCE](#)

[Amphenol-RF Division Information](#)

Optimize Your Supply Chain with WIN SOURCE Solutions

- ✓ Global Sourcing Solution
- ✓ Obsolete Management
- ✓ Cost Control Management
- ✓ Shortage Management
- ✓ Alternative Solution
- ✓ Excess Inventory Management