

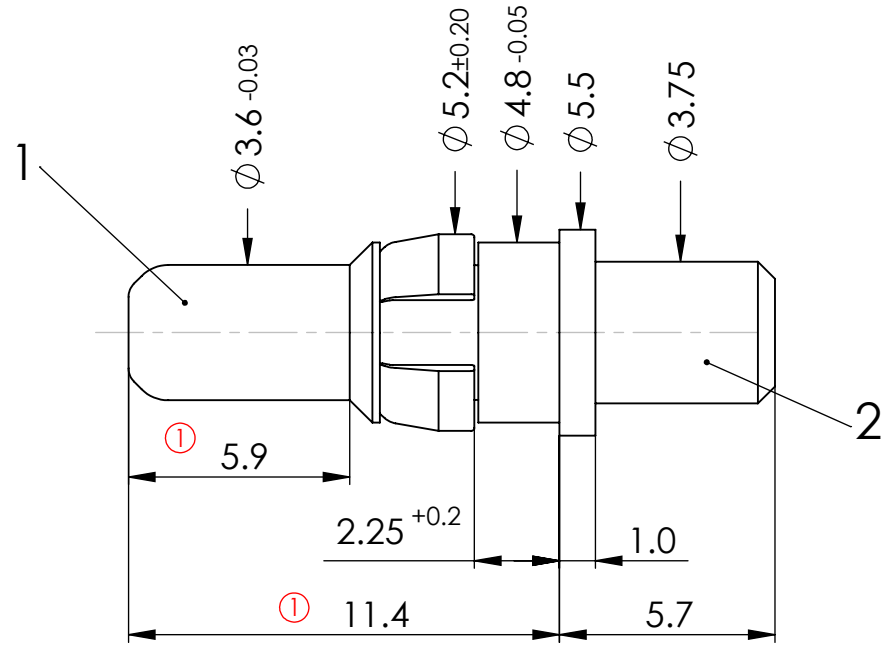

THE DATASHEET OF
1731120085

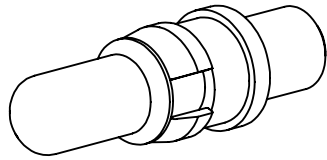

COMMENT:
 ALL RIGHTS ARE RESERVED BY US FOR THIS DRAWING. WITHOUT OUR PRIOR CONSENT,
 IT MAY NEITHER BE DUPLICATED NOR MADE AVAILABLE TO A THIRD PARTY,
 AND IT ALSO MAY NOT BE IMPROPERLY USED BY THE RECEIVER, OR A THIRD PARTY.



CURRENT	40 A	HIGH POWER CONTACT		SCALE	DATA SHEET	②
FOR	D-Sub			5:1		
DIMENSIONS IN MM		DRAWN	NAME / DATE			
MATERIAL + FINISH SEE EXTRA SHEET		CHECKED	MSteinbrück 25-08-2003			
UNLESS OTHERWISE SPECIFIED DIMENSIONS FOR REFERENCE ONLY			MTeubel 31-05-2006			
2	19-09-2006	11330			PART NO.	REV.
REV.	DATE	INDEX			FMP016P	2
			ORIGINAL: DIN A4-DRAWING AS A FILE		REPLACEMENT FOR:	PAGE: 1/1

Looking for pricing, stock, or lifecycle information?

Click below to explore more details on WIN SOURCE:

 [View 1731120085 on WIN SOURCE](#)

 [Molex, LLC Information](#)

Optimize Your Supply Chain with WIN SOURCE Solutions

-  Global Sourcing Solution
-  Obsolete Management
-  Cost Control Management
-  Shortage Management
-  Alternative Solution
-  Excess Inventory Management