

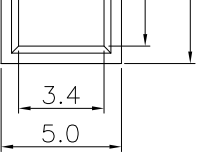

THE DATASHEET OF
3220-26-0100-00





±0.15

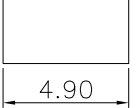

SQ0.40±0.02

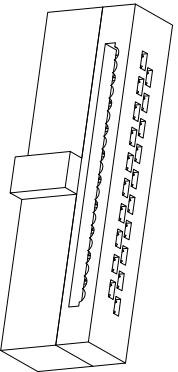
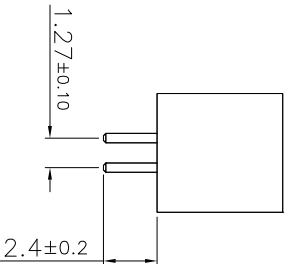

MATING PART
3230-XX-0102-00

Specifications:
 Current ratings:1.0A AC,DC
 Voltage rating:50V AC, DC
 Contact resistance:20m ohm Max
 Insulation resistance:1,000M ohm Min
 Withstanding voltage:500V AC/minute
 Operating Temperature:-40°C ~ +105°C

Materials:
 Insulator:Nylon 9T(UL94V-0)
 Standard Color:Black
 Terminal:Brass
 Finish:Gold Plated

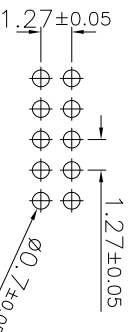

P.C.B Layout

Dimension Information:

Pin.No	Dim.A	Dim.B	Dim.C	Pin.No	Dim.A	Dim.B	Dim.C
8	3.81	9.83	11.43	30	17.78	23.80	25.40
10	5.08	11.10	12.70	34	20.32	26.34	27.94
12	6.35	12.37	13.97	40	24.13	30.15	31.75
14	7.62	13.64	15.24	44	26.67	32.69	34.29
16	8.89	14.91	16.51	50	30.48	36.50	38.10
20	11.43	17.45	19.05	60	36.83	42.85	44.45
24	13.97	19.99	21.59	68	41.91	47.93	49.53
26	15.24	21.26	22.86				

RoHS Compliant

DRAWN: Jamie

CHECKED: Jerry

APPROVAL: Rory

GENERAL TOLERANCE:

.X = ±0.25

.XX = ±0.20

UNIT: MM

SCALE:1:1

SHEET: 1 / 1

PROJECTION:



DESCRIPTION:

1.27mm Box Header Straight Type

PART NO:

3220-10-0100-00

SIZE

A4

C



B

A

D

Looking for pricing, stock, or lifecycle information?

Click below to explore more details on WIN SOURCE:

-  [View 3220-26-0100-00 on WIN SOURCE](#)
-  [CNC Tech Information](#)

Optimize Your Supply Chain with WIN SOURCE Solutions

-  Global Sourcing Solution
-  Obsolete Management
-  Cost Control Management
-  Shortage Management
-  Alternative Solution
-  Excess Inventory Management