



**THE DATASHEET OF
ELJ-FA1R0JF2**



Chip Inductors

Series: Chip

Type: RE, ND, NC, NA, FD,
FC, FA, SA, PB, PC, PA

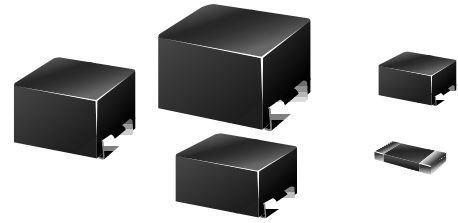

Non-winding (RE) and wire wound types chip inductors for automatic mounting and high-density mounting.

Industrial property: Patents 4.

■ Features

- High Q
- Good for mounting
- Allowable range (1.5 nH to 1,000 μ H)

■ Recommended Applications

- CTV, VTR, HIC, HDD, FDD, cordless telephones, portable telephones, pagers, video cameras

■ Explanation of Part Numbers

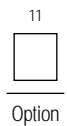
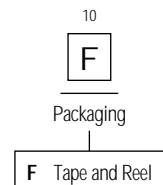
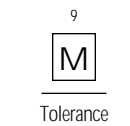
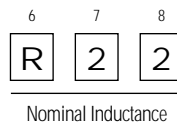
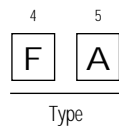
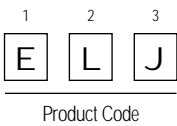

| Types | Style | | | | |
|----------|---------------------|---------------------|---------------------|---------------------|---------------------|
| | E 1608 (0603) | D 2012 (0805) | C 2520 (1008) | A 3225 (1210) | B 4532 (1812) |
| Coreless | RE | ND | NC | NA | — |
| Regular | — | FD | FC | FA | FB |
| Shield | — | — | — | SA | — |
| Power | — | — | PC | PA | — |

| | | |
|-----|---|--------------|
| 2N2 | → | 2.2 nH |
| 22N | → | 22 nH |
| R22 | → | 0.22 μ H |
| 2R2 | → | 2.2 μ H |
| 220 | → | 22 μ H |
| 221 | → | 220 μ H |
| 102 | → | 1000 μ H |

| | |
|---|--------------|
| D | \pm 0.3 nH |
| J | \pm 15% |
| K | \pm 10% |
| M | \pm 20% |

Size unit: mm (inch)

■ Inductance, Size Guide

| Type Name | | L Value (μH) | | | | | | Notes | |
|--|--|---------------------------|------|-----|-----|----|-----|---|--|
| | | 0.001 | 0.01 | 0.1 | 1.0 | 10 | 100 | 1000 | |
| Non-Magnetic Core (Ceramic, Resin, etc.) | 1608 (0603) RE Refer to EL8 | | | | | | | <ul style="list-style-type: none"> • Low inductance, tight tolerance • Stable L value, against an environmental condition • Suitable for high-frequency circuits | |
| | 2012 (0805) ND Refer to EL9 | | | | | | | | |
| | 2520 (1008) NA Refer to EL10 | | | | | | | | |
| | 3225 (1210) NA Refer to EL11 | | | | | | | | |
| Normal (Ferrite Core) | 2012 (0805) FD Refer to EL11 | | | | | | | <ul style="list-style-type: none"> • Suitable for various applications | |
| | 2520 (1008) FC Refer to EL12 | | | | | | | | |
| | 3225 (1210) FA Refer to EL13 | | | | | | | | |
| | 3225 (1210) SA Mag. Shield Refer to EL14 | | | | | | | | |
| | 4532 (1812) FB Refer to EL14 | | | | | | | | |
| High Power (Ferrite Core) | 2520 (1008) PC Refer to EL15 | | | | | | | <ul style="list-style-type: none"> • Low DC resistance and large rated DC current • Suitable for power line as choke coil | |
| | 3225 (1210) PA Refer to EL15 | | | | | | | | |

Size unit: mm (inch)

Non-Magnetic Core Types RE, ND, NC, NA

■ Examples: Type 1608 (0603) RE

| Part No. | Inductance | | Q ^{*1} min. (100 MHz) | Q ^{*2} Typical (800 MHz) | SRF ^{*3} min. (MHz) | DCR ^{*4} max. (Ω) | Rated DC Current max. (mA) |
|-------------|-----------------|-----------|-----------------------------------|--------------------------------------|---------------------------------|-------------------------------|----------------------------------|
| | nH (100 MHz) | Tolerance | | | | | |
| ELJRE1N5DF2 | 1.5 | ±0.3 nH | 8 | 47 | 6000 | 0.07 | 500 |
| ELJRE1N8DF2 | 1.8 | | 8 | 45 | 6000 | 0.08 | 500 |
| ELJRE2N2DF2 | 2.2 | | 8 | 35 | 6000 | 0.09 | 500 |
| ELJRE2N7DF2 | 2.7 | | 8 | 35 | 6000 | 0.10 | 500 |
| ELJRE3N3DF2 | 3.3 | | 9 | 35 | 5500 | 0.12 | 500 |
| ELJRE3N9JF2 | 3.9 | ±5% | 9 | 36 | 5500 | 0.15 | 450 |
| ELJRE4N7JF2 | 4.7 | | 9 | 36 | 4800 | 0.17 | 450 |
| ELJRE5N6JF2 | 5.6 | | 9 | 36 | 4600 | 0.18 | 430 |
| ELJRE6N8JF2 | 6.8 | | 9 | 36 | 3550 | 0.20 | 430 |
| ELJRE8N2JF2 | 8.2 | | 9 | 36 | 3500 | 0.28 | 400 |
| ELJRE10NJF2 | 10 | | 10 | 37 | 2800 | 0.32 | 400 |
| ELJRE12NJF2 | 12 | | 10 | 37 | 2800 | 0.35 | 400 |
| ELJRE15NJF2 | 15 | | 10 | 38 | 2500 | 0.41 | 350 |
| ELJRE18NJF2 | 18 | | 10 | 39 | 2300 | 0.45 | 350 |
| ELJRE22NJF2 | 22 | | 10 | 40 | 2000 | 0.50 | 300 |
| ELJRE27NJF2 | 27 | | 10 | 41 | 2000 | 0.55 | 300 |
| ELJRE33NJF2 | 33 | | 10 | 40 | 1800 | 0.60 | 300 |
| ELJRE39NJF2 | 39 | | 11 | 39 | 1800 | 0.80 | 300 |
| ELJRE47NJF2 | 47 | | 11 | 38 | 1800 | 0.95 | 250 |
| ELJRE56NJF3 | 56 | | 12 | 35 | 1800 | 1.20 | 250 |
| ELJRE68NJF3 | 68 | 12 | 35 | 1500 | 1.30 | 250 | |
| ELJRE82NJF3 | 82 | 12 | 33 | 1500 | 1.50 | 250 | |
| ELJRER10JF3 | 100 | 12 | 30 | 1300 | 1.80 | 200 | |

*¹Test instrument *¹ HP4191A *² HP4291A *³ Self-resonant frequency *⁴ DC resistance

■ Q-Frequency Characteristics

Type: RE

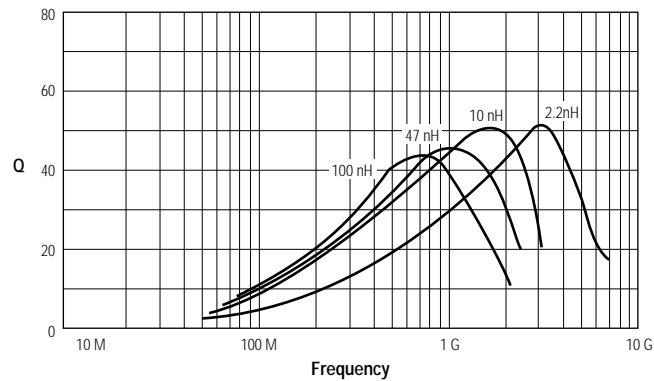

Type: ND

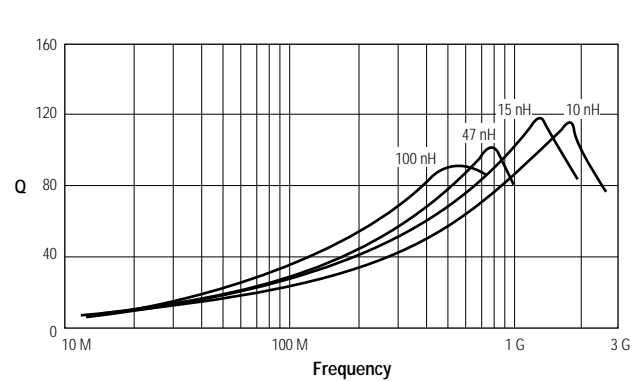

■ Examples: Type 1202 (0805) ND

| Part No. | Inductance | | Q ^{*1} min. (100 MHz) | L • Q Test-Frequency (100 MHz) | SRF ^{*2 *3} min. (MHz) | R DC ±30% (Ω) | IDC max. (mA) | |
|--------------|-----------------|---------------|-----------------------------------|--------------------------------------|------------------------------------|------------------|------------------|-----|
| | nH (100 MHz) | Tolerance | | | | | | |
| ELJND10NKF | 10 | ± 10% | 10 | 100 | 2500 | 0.14 | 540 | |
| ELJND12NKF | 12 | | | | 2500 | 0.18 | 535 | |
| ELJND15NKF | 15 | | | | 2500 | 0.18 | 520 | |
| ELJND18NKF | 18 | | | | 2000 | 0.22 | 480 | |
| ELJND22NKF | 22 | | | | 2000 | 0.22 | 465 | |
| ELJND27NKF | 27 | | 1800 | | 0.26 | 455 | | |
| ELJND33NJ/KF | 33 | | ± 5% ± 10% | | 15 | 1500 | 0.30 | 395 |
| ELJND39NJ/KF | 47 | | | | | 1500 | 0.31 | 390 |
| ELJND47NJ/KF | 56 | | | | | 1000 | 0.35 | 385 |
| ELJND56NJ/KF | 68 | | | | | 800 | 0.39 | 360 |
| ELJND68NJ/KF | 82 | 800 | | 0.44 | | 340 | | |
| ELJND82NJ/KF | 82 | 800 | | 0.48 | 330 | | | |
| ELJNDR10J/KF | 100 | ± 5% ± 10% | | 8 | 800 | 0.66 | 2.85 | |
| ELJNDR12J/KF | 120 | | | | 600 | 0.76 | 275 | |
| ELJNDR15J/KF | 150 | | | | 600 | 1.13 | 230 | |
| ELJNDR18J/KF | 180 | | | | 600 | 1.24 | 195 | |
| ELJNDR22J/KF | 220 | | 500 | | 1.41 | 170 | | |
| ELJNDR27J/KF | 270 | | 300 | 1.41 | 170 | | | |
| ELJNDR33J/KF | 330 | | 10 | 25.2 | 200 | 1.66 | 160 | |
| ELJNDR39J/KF | 390 | | | | 150 | 1.82 | 150 | |
| ELJNDR47J/KF | 470 | | | | 150 | 1.97 | 145 | |
| ELJNDR56J/KF | 560 | | | | 100 | 2.07 | 140 | |
| ELJNDR68J/KF | 680 | 100 | | | 2.32 | 130 | | |
| ELJNDR82J/KF | 820 | 80 | 2.60 | | 125 | | | |
| ELJND1ROJ/KF | 1000 | 8 | 7.96 | | 80 | 2.98 | 120 | |

* Test instrument *¹ HP4191A *² HP8753B *³ Self-resonant frequency

■ Examples: Type 2520 (1008) NC

| Part No. | Inductance | | Q min. | L • Q Test-Frequency MHz | SRF* MHz (min.) | DCR** Ω max. | Rated DC Current mA max. | | | |
|--------------|------------|-----------|--------|--------------------------|-----------------|--------------|--------------------------|-----|------|-----|
| | μH | Tolerance | | | | | | | | |
| ELJNC10NKF | 0.010 | ± 10% | 10 | 100 | 2500 | 0.32 | 280 | | | |
| ELJNC12NKF | 0.012 | | | | 2200 | 0.34 | 270 | | | |
| ELJNC15NKF | 0.015 | | | | 1800 | 0.38 | 255 | | | |
| ELJNC18NKF | 0.018 | | | | 1550 | 0.40 | 250 | | | |
| ELJNC22NKF | 0.022 | | | | 1350 | 0.43 | 240 | | | |
| ELJNC27NKF | 0.027 | ± 10% | 15 | 100 | 1150 | 0.47 | 230 | | | |
| ELJNC33NJ/KF | 0.033 | | | | 1000 | 0.51 | 220 | | | |
| ELJNC39NJ/KF | 0.039 | | | | 890 | 0.55 | 215 | | | |
| ELJNC47NJ/KF | 0.047 | | | | 770 | 0.59 | 205 | | | |
| ELJNC56NJ/KF | 0.056 | | | | 670 | 0.63 | 200 | | | |
| ELJNC68NJ/KF | 0.068 | | | | 590 | 0.68 | 190 | | | |
| ELJNC82NJ/KF | 0.082 | | | | 520 | 0.73 | 185 | | | |
| ELJNCR10J/KF | 0.10 | | | | ± 10% ±5% | 10 | 25.2 | 460 | 0.80 | 175 |
| ELJNCR12J/KF | 0.12 | | | | | | | 400 | 0.87 | 170 |
| ELJNCR15J/KF | 0.15 | | | | | | | 340 | 0.98 | 160 |
| ELJNCR18J/KF | 0.18 | 300 | 1.05 | 155 | | | | | | |
| ELJNCR22J/KF | 0.22 | 260 | 1.15 | 145 | | | | | | |
| ELJNCR27J/KF | 0.27 | 230 | 1.25 | 140 | | | | | | |
| ELJNCR33J/KF | 0.33 | 200 | 1.37 | 135 | | | | | | |
| ELJNCR39J/KF | 0.39 | 180 | 1.47 | 130 | | | | | | |
| ELJNCR47J/KF | 0.47 | 160 | 1.58 | 125 | | | | | | |
| ELJNCR56J/KF | 0.56 | 145 | 1.70 | 120 | | | | | | |
| ELJNCR68J/KF | 0.68 | 130 | 1.85 | 110 | | | | | | |
| ELJNCR82J/KF | 0.82 | 100 | 2.10 | 100 | | | | | | |

*Self-Resonant Frequency ** DC Resistance

■ Examples: Type 3225 (1210) NA

| Part No. | Inductance | | | Q | | SRF MHz (min.) | DCR Ω max. | Rated DC Current mA Max. | | | | |
|------------|------------|-----------|------------|-----------|-----------|----------------|-------------------|--------------------------|------|-----|-----|-----|
| | μ H | Freq. MHZ | Tolerance | min. | Freq. MHZ | | | | | | | |
| ELJNA47NMF | 0.047 | 100 | $\pm 20\%$ | 10 | 100 | 680 | 0.20 | 450 | | | | |
| ELJNA56NMF | 0.056 | | | | | 600 | 0.22 | 420 | | | | |
| ELJNA68NMF | 0.068 | | | | | 540 | 0.25 | 400 | | | | |
| ELJNA82NMF | 0.082 | | | | | 500 | 0.27 | 380 | | | | |
| ELJNAR10MF | 0.10 | | | | | 450 | 0.30 | 360 | | | | |
| ELJNAR12MF | 0.12 | 25.2 | $\pm 20\%$ | | 10 | 25.2 | 400 | 0.67 | 240 | | | |
| ELJNAR15MF | 0.15 | | | | | | 350 | 0.72 | 230 | | | |
| ELJNAR18MF | 0.18 | | | | | | 320 | 0.81 | 220 | | | |
| ELJNAR22KF | 0.22 | 1.0 | $\pm 10\%$ | | | 10 | 25.2 | 280 | 0.90 | 210 | | |
| ELJNAR27KF | 0.27 | | | | | | | 250 | 1.0 | 200 | | |
| ELJNAR33KF | 0.33 | | | 220 | | | | 1.1 | 190 | | | |
| ELJNAR39KF | 0.39 | | | 200 | | | | 1.2 | 180 | | | |
| ELJNAR47KF | 0.47 | | | 180 | | | | 1.4 | 175 | | | |
| ELKNAR56KF | 0.56 | | | 160 | | | | 1.5 | 170 | | | |
| ELJNAR68KF | 0.68 | | | 150 | | | | 1.7 | 155 | | | |
| ELJNAR82KF | 0.82 | | | 135 | 1.9 | | | 145 | | | | |
| ELJNA1R0KF | 1.0 | | | $\pm 5\%$ | $\pm 5\%$ | | | 13 | 7.96 | 120 | 2.1 | 125 |
| ELJNA1R2JF | 1.2 | | | | | | | | | 110 | 2.3 | 120 |
| ELJNA1R5JF | 1.5 | 95 | 2.7 | | | 115 | | | | | | |
| ELJNA1R8JF | 1.8 | 85 | 3.0 | | | 110 | | | | | | |
| ELJNA2R2JF | 2.2 | 80 | 3.2 | | | 110 | | | | | | |
| ELJNA2R7JF | 2.7 | 70 | 3.6 | | | 105 | | | | | | |
| ELJNA3R3JF | 3.3 | 62 | 4.2 | | | 100 | | | | | | |
| ELJNA3R9JF | 3.9 | 57 | 4.4 | | | 95 | | | | | | |
| ELJNA4R7JF | 4.7 | 52 | 7.7 | | | 70 | | | | | | |
| ELJNA5R6JF | 5.6 | 46 | 8.7 | | | 65 | | | | | | |
| ELJNA6R8JF | 6.8 | 42 | 10 | 60 | | | | | | | | |
| ELJNA8R2JF | 8.2 | 38 | 11 | 60 | | | | | | | | |

Normal Types FD, FC, FA, SA, FB

■ Examples: Type 3225 (1210) NA

| Part No. | Inductance | | Q ^{*1} min. (100 MHz) | L • Q Test-Frequency (MHz) | SRF ^{*2 *3} min. (MHz) | R DC $\pm 30\%$ (Ω) | IDC max. (mA) |
|------------|------------|------------|--------------------------------|----------------------------|---------------------------------|------------------------------|---------------|
| | μ H | Tolerance | | | | | |
| ELJFDR82KF | 0.81 | $\pm 10\%$ | 8 | 25.2 | 370 | 1.35 | 190 |
| ELJFD1R0KF | 1.0 | | 15 | 7.96 | 300 | 1.56 | 160 |
| ELJFD1R2KF | 1.2 | | | | 200 | 1.60 | 155 |
| ELJFD1R5KF | 1.5 | | | | 100 | 1.85 | 150 |
| ELJFD1R8KF | 1.8 | | | | 80 | 1.95 | 145 |
| ELJFD2R2KF | 2.2 | | | | 70 | 2.27 | 145 |
| ELJFD2R7KF | 2.7 | | | | 60 | 2.54 | 140 |
| ELJFD3R3KF | 3.3 | | | | 50 | 2.84 | 140 |
| ELJFD3R9KF | 3.9 | | | | 40 | 2.92 | 130 |
| ELJFD4R7KF | 4.7 | | | | 30 | 3.38 | 130 |

*Test instrument *¹ HP4191A *² HP8753B *³ Self-resonant frequency

■ Examples: Type 2520 (1008) FC

| Part No. | Inductance | | Q min. | L • Q Test-Frequency MHz | SRF* MHz (min.) | DCR** Ω max. | Rated DC Current mA max. | |
|--------------|------------|--------------|--------|--------------------------|-----------------|--------------|--------------------------|----|
| | μH | Tolerance | | | | | | |
| ELJFCR22M/KF | 0.22 | ±20% ±10% | | 25.2 | 230 | 0.70 | 190 | |
| ELJFCR27M/KF | 0.27 | | | | 210 | 0.75 | 180 | |
| ELJFCR33M/KF | 0.33 | | | | 190 | 0.85 | 170 | |
| ELJFCR39M/KF | 0.39 | | | | 175 | 0.95 | 160 | |
| ELJFCR47M/KF | 0.47 | | | | 160 | 1.0 | 155 | |
| ELJFCR56M/KF | 0.56 | | | | 150 | 1.1 | 150 | |
| ELJFCR68M/KF | 0.68 | | | | 135 | 1.25 | 140 | |
| ELJFCR82M/KF | 0.82 | | | | 125 | 1.4 | 130 | |
| ELJFC1R0K/JF | 1.0 | ±10% ±5% | 25 | 7.95 | 115 | 0.65 | 195 | |
| ELJFC1R2K/JF | 1.2 | | | | 100 | 0.75 | 180 | |
| ELJFC1R5K/JF | 1.5 | | | | 90 | 0.85 | 170 | |
| ELJFC1R8K/JF | 1.8 | | | | 85 | 0.95 | 160 | |
| ELJFC1R2K/JF | 2.2 | | | | 80 | 1.05 | 155 | |
| ELJFC2R7K/JF | 2.7 | | | | 75 | 1.2 | 145 | |
| ELJFC3R3K/JF | 3.3 | | | | 65 | 1.3 | 135 | |
| ELJFC3R9K/JF | 3.9 | | | | 60 | 1.4 | 130 | |
| ELJFC4R7K/JF | 4.7 | | | 55 | 1.55 | 125 | | |
| ELJFC5R6K/JF | 5.6 | | | 50 | 1.75 | 120 | | |
| ELJFC6R8K/JF | 6.8 | | | 45 | 1.95 | 115 | | |
| ELJFC8R2K/JF | 8.2 | | | 40 | 2.2 | 105 | | |
| ELJFC100K/JF | 10 | | | 20 | 2.52 | 32 | 3.5 | 80 |
| ELJFC120K/JF | 12 | | | | | 30 | 3.8 | 75 |
| ELJFC150K/JF | 15 | | | | | 28 | 4.4 | 70 |
| ELJFC180K/JF | 18 | | | | | 25 | 5.0 | 65 |
| ELJFC220K/JF | 22 | 22 | 5.8 | | | 60 | | |
| ELJFC270K/JF | 27 | 21 | 6.3 | | | 115 | | |
| ELJFC330K/JF | 33 | 20 | 7.1 | | | 110 | | |
| ELJFC390K/JF | 39 | 18 | 9.5 | | | 90 | | |
| ELJFC470K/JF | 47 | 17 | 11.0 | | | 80 | | |
| ELJFC560K/JF | 56 | 16 | 12.1 | | | 75 | | |
| ELJFC680K/JF | 68 | 15 | 16.6 | 70 | | | | |
| ELJFC820K/JF | 82 | 13 | 19.0 | 65 | | | | |
| ELJFC101K/JF | 100 | 15 | 0.796 | 122 | 21.0 | 60 | | |

* Self-Resonant Frequency ** DC Resistance

■ Examples: Type 3225 (1210) FA

| Part No. | Inductance | | Q min. | L, Q Test-Frequency MHz | SRF* min. (MHz) | DCR** Ω max. | Rated DC Current mA max. | |
|---------------|------------|--------------|--------|-------------------------------|--------------------|-----------------|--------------------------------|-----|
| | μH | Tolerance | | | | | | |
| ELJFAR22M/KF2 | 0.22 | ±20% ±10% | 25 | 25.2 | 230 | 0.29 | 360 | |
| ELJFAR27M/KF2 | 0.27 | | | | 210 | 0.32 | 345 | |
| ELJFAR33M/KF2 | 0.33 | | | | 190 | 0.35 | 330 | |
| ELJFAR39M/KF2 | 0.39 | | | | 175 | 0.39 | 305 | |
| ELJFAR47M/KF2 | 0.47 | | | | 160 | 0.44 | 290 | |
| ELJFAR56M/KF2 | 0.56 | | | | 150 | 0.49 | 275 | |
| ELJFAR68M/KF2 | 0.68 | | | | 135 | 0.55 | 260 | |
| ELJFAR82M/KF2 | 0.82 | | | | 125 | 0.61 | 245 | |
| ELJFA1R0K/JF2 | 1.0 | ±10% ±5% | 30 | 7.96 | 115 | 0.69 | 230 | |
| ELJFA1R2K/JF2 | 1.2 | | | | 100 | 0.75 | 215 | |
| ELJFA1R5K/JF | 1.5 | | | | 90 | 0.75 | 210 | |
| ELJFA1R8K/JF | 1.8 | | | | 85 | 0.82 | 200 | |
| ELJFA2R2K/JF | 2.2 | | | | 80 | 0.95 | 190 | |
| ELJFA2R7K/JF | 2.7 | | | | 75 | 1.1 | 180 | |
| ELJFA3R3K/JF | 3.3 | | | | 65 | 1.2 | 180 | |
| ELJFA3R9K/JF | 3.9 | | | | 60 | 1.3 | 175 | |
| ELJFA4R7K/JF | 4.7 | | | | 55 | 1.5 | 165 | |
| ELJFA5R6K/JF | 5.6 | | | | 50 | 1.6 | 160 | |
| ELJFA6R8K/JF | 6.8 | | | 45 | 1.8 | 150 | | |
| ELJFA8R2K/JF | 8.2 | | | 40 | 2.0 | 140 | | |
| ELJFA100K/JF | 10 | | | 25.2 | 25.2 | 36 | 2.1 | 140 |
| ELJFA120K/JF | 12 | | | | | 33 | 2.5 | 125 |
| ELJFA150K/JF | 15 | | | | | 30 | 2.8 | 120 |
| ELJFA180K/JF | 18 | | | | | 27 | 3.3 | 110 |
| ELJFA220K/JF | 22 | | | | | 25 | 3.7 | 105 |
| ELJFA270K/JF | 27 | | | | | 22 | 5.0 | 90 |
| ELJFA330K/JF | 33 | | | | | 20 | 5.6 | 85 |
| ELJFA390K/JF | 39 | | | | | 20 | 6.4 | 80 |
| ELJFA470K/JF | 47 | 15 | 7.0 | | | 75 | | |
| ELJFA560K/JF | 56 | 15 | 8.0 | | | 70 | | |
| ELJFA680K/JF | 68 | 15 | 9.0 | 65 | | | | |
| ELJFA820K/JF | 82 | 11 | 10 | 60 | | | | |
| ELJFA101K/JF | 100 | 20 | 0.796 | 10 | 10 | 60 | | |
| ELJFA121K/JF | 120 | | | 10 | 11 | 55 | | |
| ELJFA151K/JF | 150 | | | 8 | 15 | 50 | | |
| ELJFA181K/JF | 180 | | | 7 | 17 | 50 | | |
| ELJFA221K/JF | 220 | | | 7 | 21 | 45 | | |

* Self-resonant frequency ** DC resistance

■ Examples: Type 3225 (1210) SA

| Part No. | Inductance | | | Q | | SRF MHz (min.) | DCR Ω max. | Rated DC Current mA max. |
|------------|------------|-----------|-----------|------|-----------|-------------------|---------------|-----------------------------|
| | μH | Freq. MHz | Tolerance | min. | Freq. MHz | | | |
| ELJSA100KF | 10 | 1.0 | ±10% | 40 | 5.0 | 30 | 1.8 | 18 |
| ELJSA120KF | 12 | | | | | 28 | 2.0 | 17 |
| ELJSA150KF | 15 | | | | | 25 | 2.2 | 15 |
| ELJSA180KF | 18 | | | | | 23 | 2.5 | 13 |
| ELJSA220KF | 22 | | | | | 20 | 2.8 | 12 |
| ELJSA270KF | 27 | | | | | 18 | 3.2 | 10 |
| ELJSA330KF | 33 | | | | | 17 | 3.5 | 10 |
| ELJSA390KF | 39 | | | | 15 | 3.8 | 9 | |
| ELJSA470KF | 47 | | | | 14 | 4.0 | 8 | |
| ELJSA560KF | 56 | | | | 13 | 4.5 | 7 | |
| ELJSA680KF | 68 | | | | 1.5 | 12 | 5.0 | 6 |
| ELJSA820KF | 82 | | | | | 11 | 6.0 | 6 |
| ELJSA101KF | 100 | | | | | 10 | 7.0 | 5 |
| ELJSA121KF | 120 | | | | | 9 | 8.0 | 5 |
| ELJSA151KF | 150 | 5 | 9.0 | 5 | | | | |
| ELJSA181KF | 180 | 5 | 11.0 | 5 | | | | |
| ELJSA221KF | 220 | 0.1 | 4 | 12.0 | | 5 | | |
| ELJSA271KF | 270 | | 4 | 14.0 | 5 | | | |

■ Examples: Type 4532 (1812) FB

| Part No. | Inductance | | | Q | | SRF* MHz (min.) | DCR** Ω max. | Rated DC Current mA max. |
|--------------|------------|-----------|-------------|------|-----------|--------------------|-----------------|-----------------------------|
| | μH | Freq. MHz | Tolerance | min. | Freq. MHz | | | |
| ELJFB101K/JF | 100 | 0.1 | ±10% ±5% | 40 | 2.52 | 6.7 | 8.8 | 105 |
| ELJFB121K/JF | 120 | | | | 1.5 | 6.1 | 10 | 100 |
| ELJFB151K/JF | 150 | | | | | 5.5 | 11 | 95 |
| ELJFB181K/JF | 180 | | | | 5.1 | 13 | 85 | |
| ELJFB221K/JF | 220 | | | | 0.796 | 4.5 | 13 | 85 |
| ELJFB271K/JF | 270 | | | | | 4.1 | 14 | 80 |
| ELJFB331K/JF | 330 | | | | | 3.7 | 16 | 75 |
| ELJFB391K/JF | 390 | | | | | 3.3 | 19 | 70 |
| ELJFB471K/JF | 470 | | | 30 | | 3.3 | 31 | 55 |
| ELJFB561K/JF | 560 | | | | | 2.7 | 35 | 50 |
| ELJFB681K/JF | 680 | | | | | 2.5 | 39 | 50 |
| ELJFB821K/JF | 820 | | | | | 2.4 | 45 | 45 |
| ELJFB102K/JF | 1000 | | | 2.1 | 53 | 40 | | |

* Self-resonant frequency ** DC resistance

High Power Types PC, PA

■ Examples: Type 2520 (1008) PC

| Part No. | Inductance | | Q min. | L, Q Test-Frequency MHz | SRF* MHz (min.) | DCR** Ω max. | Rated DC Current mA max. |
|-------------|------------|-----------|--------|-------------------------|-----------------|--------------|--------------------------|
| | μH | Tolerance | | | | | |
| ELJPC1R0MF | 1.0 | ±20% | 10 | 7.96 | 95 | 0.45 | 475 |
| ELJPC1R5MF | 1.5 | | | | 85 | 0.55 | 435 |
| ELJPC2R2MF | 2.2 | | | | 65 | 0.65 | 390 |
| ELJPC3R3MF | 3.3 | | | | 55 | 0.85 | 340 |
| ELJPC4R7MF | 4.7 | | | | 43 | 1.2 | 285 |
| ELJPC6R8KF2 | 6.8 | ±10% | 8 | 2.52 | 39 | 1.3 | 275 |
| ELJPC100KF | 10.0 | | | | 32 | 2.2 | 210 |
| ELJPC120KF | 12.0 | | | | 25 | 2.7 | 195 |
| ELJPC150KF | 15.0 | | | | 21 | 3.2 | 175 |
| ELJPC220KF | 22.0 | | | | 18 | 4.0 | 160 |
| ELJPC330KF | 33.0 | | | | 16 | 6.5 | 120 |

*Self-Resonant Frequency ** DC Resistance

■ Examples: Type 3225 (1210) PA

| Part No. | Inductance | | Q | L, Q Test-Frequency MHz | SRF* MHz (min.) | DCR** Ω max. | Rated DC Current mA max. |
|------------|------------|-----------|------|-------------------------|-----------------|--------------|--------------------------|
| | μH | Tolerance | | | | | |
| ELJPA1R0MF | 1.0 | ±20% | 7 | 7.96 | 150 | 0.15 | 600 |
| ELJPA1R5MF | 1.5 | | | | 110 | 0.18 | 550 |
| ELJPA2R2MF | 2.2 | | | | 80 | 0.23 | 500 |
| ELJPA3R3MF | 3.3 | | | | 58 | 0.28 | 400 |
| ELJPA4R7MF | 4.7 | | | | 46 | 0.34 | 350 |
| ELJPA6R8MF | 6.8 | | | | 38 | 0.42 | 300 |
| ELJPA100KF | 10 | ±10% | 15 | 2.52 | 23 | 0.50 | 240 |
| ELJPA120KF | 12 | | | | 21 | 0.60 | 230 |
| ELJPA150KF | 15 | | | | 18 | 0.74 | 220 |
| ELJPA180KF | 18 | | | | 17 | 0.90 | 205 |
| ELJPA220KF | 22 | | | | 15 | 1.15 | 185 |
| ELJPA270KF | 27 | | | | 13 | 1.45 | 165 |
| ELJPA330KF | 33 | | | | 12 | 1.65 | 155 |
| ELJPA390KF | 39 | | | | 11 | 1.90 | 145 |
| ELJPA470KF | 47 | | | | 9.5 | 2.25 | 135 |
| ELJPA560KF | 56 | | 8.5 | 3.30 | 110 | | |
| ELJPA680KF | 68 | | 7.5 | 3.70 | 105 | | |
| ELJPA820KF | 82 | | 7.0 | 4.20 | 100 | | |
| ELJPA101KF | 100 | | 20 | 0.796 | 6.5 | 5.00 | 90 |
| ELJPA121KF | 120 | | | | 6.0 | 7.00 | 75 |
| ELJPA151KF | 150 | | | | 5.5 | 8.00 | 70 |
| ELJPA181KF | 180 | | | | 5.0 | 9.50 | 65 |
| ELJPA221KF | 220 | | | | 4.0 | 11.0 | 60 |
| ELJPA271KF | 270 | | | | 3.5 | 14.5 | 55 |
| ELJPA331KF | 330 | 3.0 | 16.0 | 50 | | | |

*Self-Resonant Frequency ** DC Resistance

■ Dimensions in mm (not to scale)

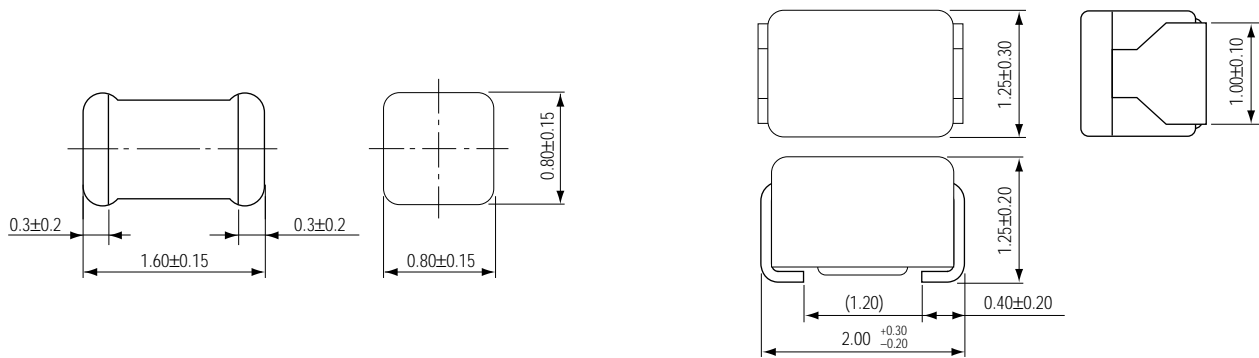

Type RE
(1.6 x 0.8 x 0.8)

Types ND, FD
(2.0 x 1.25 x 1.25)

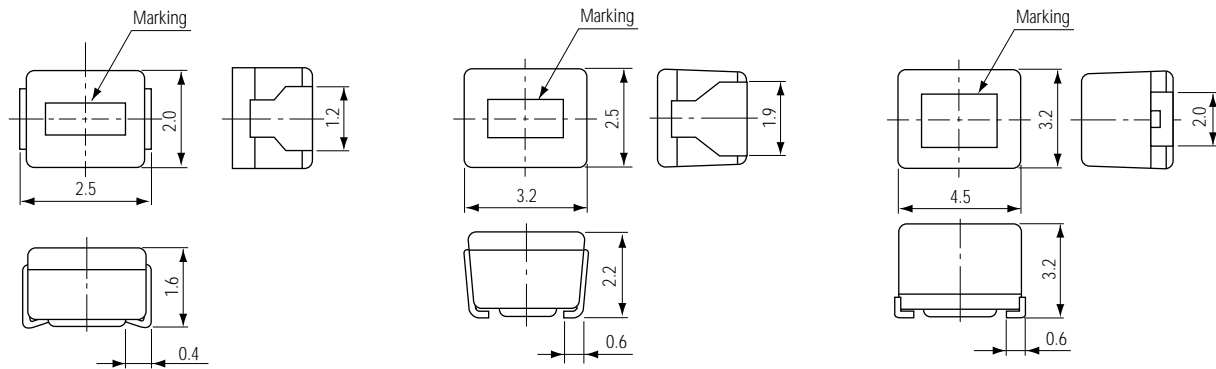

Types FC, NC, PC
(2.5 x 2.0 x 1.6)

Types FA, SA, NA, PA
(3.2 x 2.5 x 2.2)

Type FB
(4.5 x 3.2 x 3.2)

■ Recommended Land Pattern in mm (not to scale)

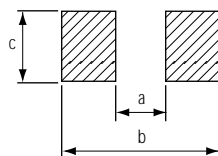

| | a | b | c |
|----------|-----------|-----------|-----------|
| Type RE | 0.8 ~ 1.0 | 2.0 ~ 2.6 | 0.7 ~ 0.9 |
| Type □ D | 1.0 ~ 1.2 | 3.0 ~ 3.8 | 0.9 ~ 1.3 |
| Type □ C | 1.4 ~ 1.5 | 3.5 ~ 4.0 | 1.2 ~ 1.6 |
| Type □ A | 1.6 ~ 2.0 | 4.0 ~ 4.6 | 1.9 ~ 2.4 |
| Type FB | 2.4 ~ 2.6 | 5.5 ~ 6.0 | 2.0 ~ 3.0 |

■ Embossed Carrier Tape Dimensions in mm (not to scale)
Types RE, ND, FC, FD, FC, PC

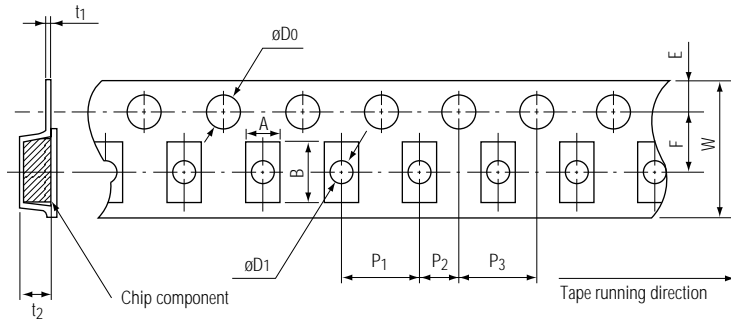

(W = 8mm)

Types NA, FA, SA, PA

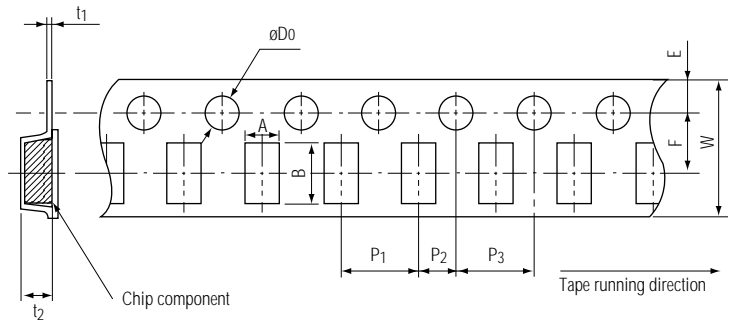

(W = 8mm)

Type FB

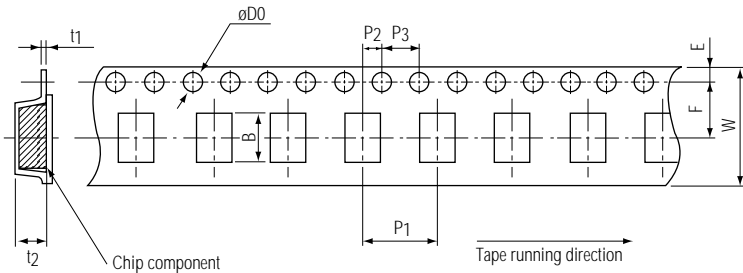

(W = 12mm)

| Size | Types | Dimensions | | | | | | | | | | | |
|-------------|----------------|------------|------|----|-----|------|----------------|----------------|----------------|-----------------|-----------------|----------------|----------------|
| | | A | B | W | F | E | P ₁ | P ₂ | P ₃ | øD ₀ | øD ₁ | t ₁ | t ₂ |
| 1608 (0603) | RE | 1.0 | 1.8 | 8 | 3.5 | 1.75 | 4.0 | 2.0 | 4.0 | 1.5 | 0.6 | (0.27) | 1.2 |
| 2012 (0805) | ND, FD | 1.45 | 2.25 | 8 | 3.5 | 1.75 | 4.0 | 2.0 | 4.0 | 1.5 | 1.0 | (0.25) | 1.55 |
| 2520 (1008) | NC, FC, PC | 2.4 | 2.9 | 8 | 3.5 | 1.75 | 4.0 | 2.0 | 4.0 | 1.5 | 1.1 | (0.25) | 1.85 |
| 3225 (1210) | NA, FA, SA, PA | 2.8 | 3.6 | 8 | 3.5 | 1.75 | 4.0 | 2.0 | 4.0 | 1.5 | — | (0.25) | 2.4 |
| 4532 (1812) | FB | 3.6 | 4.9 | 12 | 5.5 | 1.75 | 8.0 | 2.0 | 4.0 | 1.5 | — | (0.3) | 3.5 |

■ Packaging Methods

Standard Packing Quantity and Mass

| Types | Quantity | Mass |
|----------------|-----------|-------|
| RE, ND, FD | 3000 pcs. | 90 g |
| NC, FC, PC | 2000 pcs. | 100 g |
| NA, FA, SA, PA | 2000 pcs. | 170 g |
| FB | 500 pcs. | 100 g |

Reel Dimensions

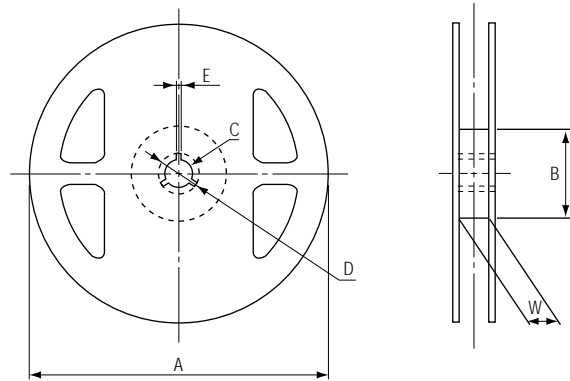

Dimensions

| Types RE, ND, FD, NC, FC, PC, NA, FA, SA, PA | | | | | |
|--|---------|-----|----|-----|----|
| A | B | C | D | E | W |
| 178 | 60 min. | ø13 | 21 | 2.0 | 9 |
| Type FB | | | | | |
| A | B | C | D | E | W |
| 178 | 60 min. | ø13 | 21 | 2.0 | 13 |

Looking for pricing, stock, or lifecycle information?

Click below to explore more details on WIN SOURCE:

 [View ELJ-FA1R0JF2 on WIN SOURCE](#)

 [Panasonic Information](#)

Optimize Your Supply Chain with WIN SOURCE Solutions

-  Global Sourcing Solution
-  Obsolete Management
-  Cost Control Management
-  Shortage Management
-  Alternative Solution
-  Excess Inventory Management