

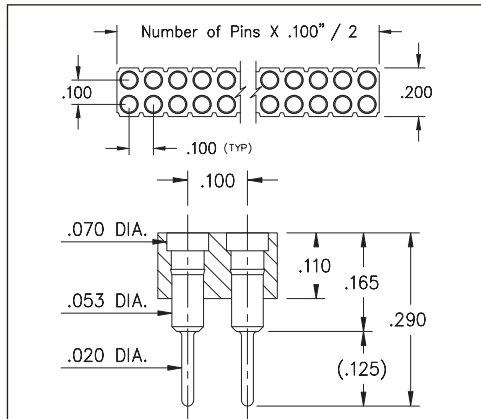


**THE DATASHEET OF  
419-10-210-00-005000**

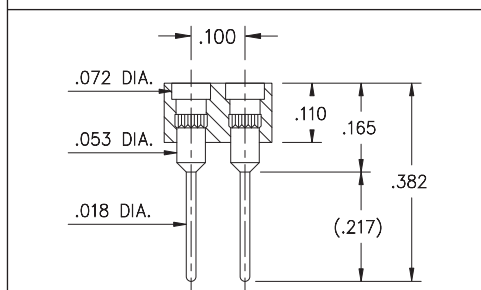


# SPRING-LOADED CONNECTORS

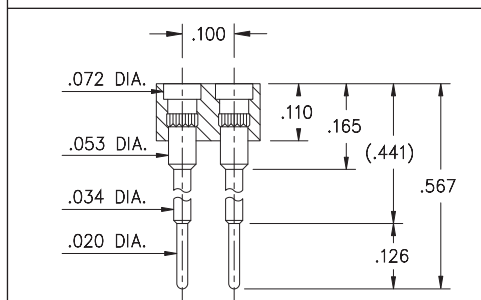
## SERIES 419, 430 • .100" GRID TARGET CONNECTORS FOR SPRING-LOADED ASSEMBLIES • DOUBLE ROW STRIPS



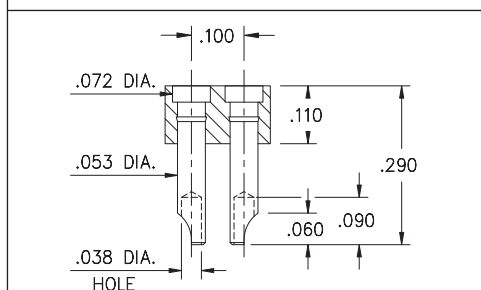
**FIG. 1**



**FIG. 2**

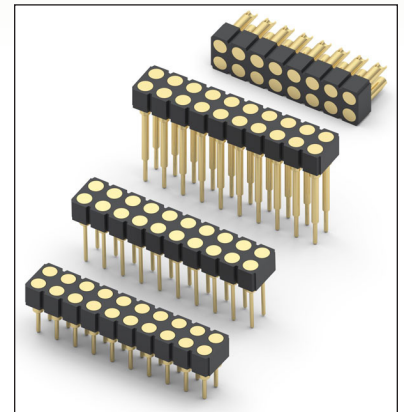


**FIG. 3**







**FIG. 4**

- Series 419 and 430 Spring Target Connectors, supplied in double row strips. Available in through-hole and wire termination configurations
- Target Connectors provide an excellent gold-plated conductive mating surface for spring loaded connectors. These series are offered with a flat face for making contact with our standard .042" dia. spring pin plungers
- Target connectors use MM #1938, #1940, #1942 and #3024 pins. See page 218 for details
- Insulators are high temperature thermoplastic



### ORDERING INFORMATION

	Series 419...001	Standard Solder Tails
<b>FIG. 1</b>	419-10-2	-00-001000
	Specify number of pins	04-64
	Series 419...002	Long Solder Tails
<b>FIG. 2</b>	419-10-2	-00-002000
	Specify number of pins	04-64
	Series 419...005	Elevated with Solder Tails
<b>FIG. 3</b>	419-10-2	-00-005000
	Specify number of pins	04-64
	Series 430...240	Solder Cups
<b>FIG. 4</b>	430-10-2	-00-240000
	Specify number of pins	04-64
  		
<b>SPECIFY PLATING CODE XX=</b>	10	◆
Pin Plating 	10 μ" Au	

## Looking for pricing, stock, or lifecycle information?

Click below to explore more details on WIN SOURCE:

- ⊖ [View 419-10-210-00-005000 on WIN SOURCE](#)
- ⊖ [Mill-Max Manufacturing Corp.](#) Information

## Optimize Your Supply Chain with WIN SOURCE Solutions

- ✓ Global Sourcing Solution
- ✓ Obsolete Management
- ✓ Cost Control Management
- ✓ Shortage Management
- ✓ Alternative Solution
- ✓ Excess Inventory Management