



# THE DATASHEET OF 2.4-LA-JJ



① ② ③ ④ ⑤ ⑥ ⑦

VIEW A

(16.1)

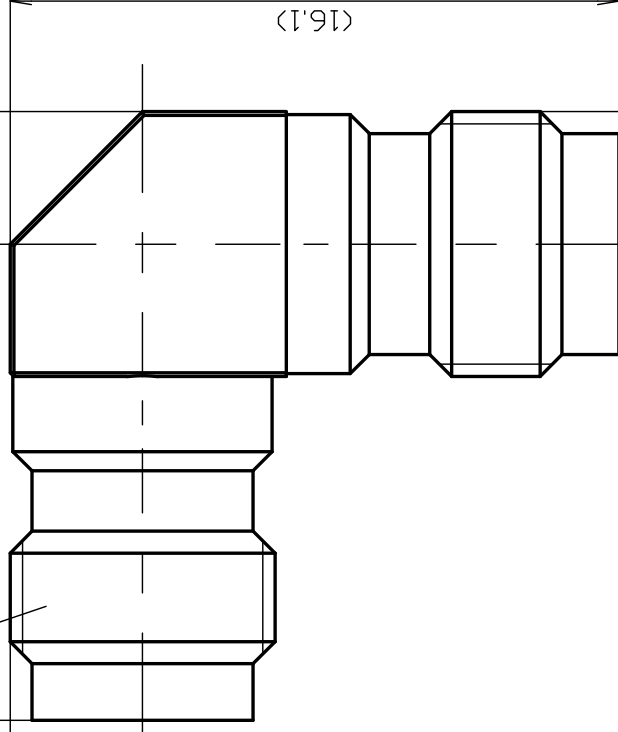

M7 P0.75-6g

VIEW B

(16.1)

M7 P0.75-6g

- \*1 PASSIVATE
- \*2 STAINLESS STEEL
- \*3 BERYLLIUM COPPER

NO.	DESCRIPTION	MATERIAL	Q'TY	FINISH	REMARK
7	BUSHING	*2	5	*1	
6	CENTER PIN C	*3	1	Au	
5	INSULATOR B	PEI	1	--	
4	CENTER PIN B	*3	1	Au	
3	INSULATOR A	PEI	1	--	
2	CENTER PIN A	*3	1	Au	
1	BODY	*2	1	*1	

SCALE	5/1
UNIT	mm
DATE	2024.05.23

DRAWN	INSPECTED	APPR
井 出 '24.05.23	檜 澤 '24.05.23	井 出 '24.05.23

PROJECTION	株式会社	70-
第一角	株式会社	70-

# PRODUCT SPECIFICATIONS

Part number: 2.4-LA-JJ

No. 1042553

Drawing number: U-1046351

Nominal 1 Standard IEC 61169-40  
 2 Voltage rating AC 160V  
 3 Rated frequency 50GHz  
 4 Impedance 50Ω  
 5 Operating temperature range -40°C~+85°C



	Test Items	Test Method/Value	Remarks
1	E L E C T R I C A L	Insulation resistance	1000MΩ(Min.) at DC 500V
2		Withstanding voltage	1 minute at AC 500V
3		Contact resistance	Inner conductor : 4.0mΩ(Max.) Outer conductor : 2.5mΩ(Max.)
4		V.S.W.R	DC~50GHz : 1.35(Max.)
5	M E C H A N I C A L	Compatibility	No defects or abnormalities  Connecting with a standard-compliant connector
6		Tensile strength of coupling mechanism	450N  At axial tensile force
7		Center contact retaining force	0.25N(Min.)  With a standard pin gauge
8		Coupling torque	0.8~1.1N·m
	O T H E R S		

※The structural shape is shown in the attached drawing (Drawing number:U-1046351)



	REVISIONS	DATE
1		
2		
3		

Checked	Approved	Inspected	Prepared
24.05.23	24.05.23	24.05.23	24.05.23
村	山本	澤	井出

GKQM-24

## Looking for pricing, stock, or lifecycle information?

Click below to explore more details on WIN SOURCE:

-  [View 2.4-LA-JJ on WIN SOURCE](#)
-  [TYCLON Information](#)

## Optimize Your Supply Chain with WIN SOURCE Solutions

-  Global Sourcing Solution
-  Obsolete Management
-  Cost Control Management
-  Shortage Management
-  Alternative Solution
-  Excess Inventory Management