



# THE DATASHEET OF N-PA-PJ



1 2 3 4 5 6

7

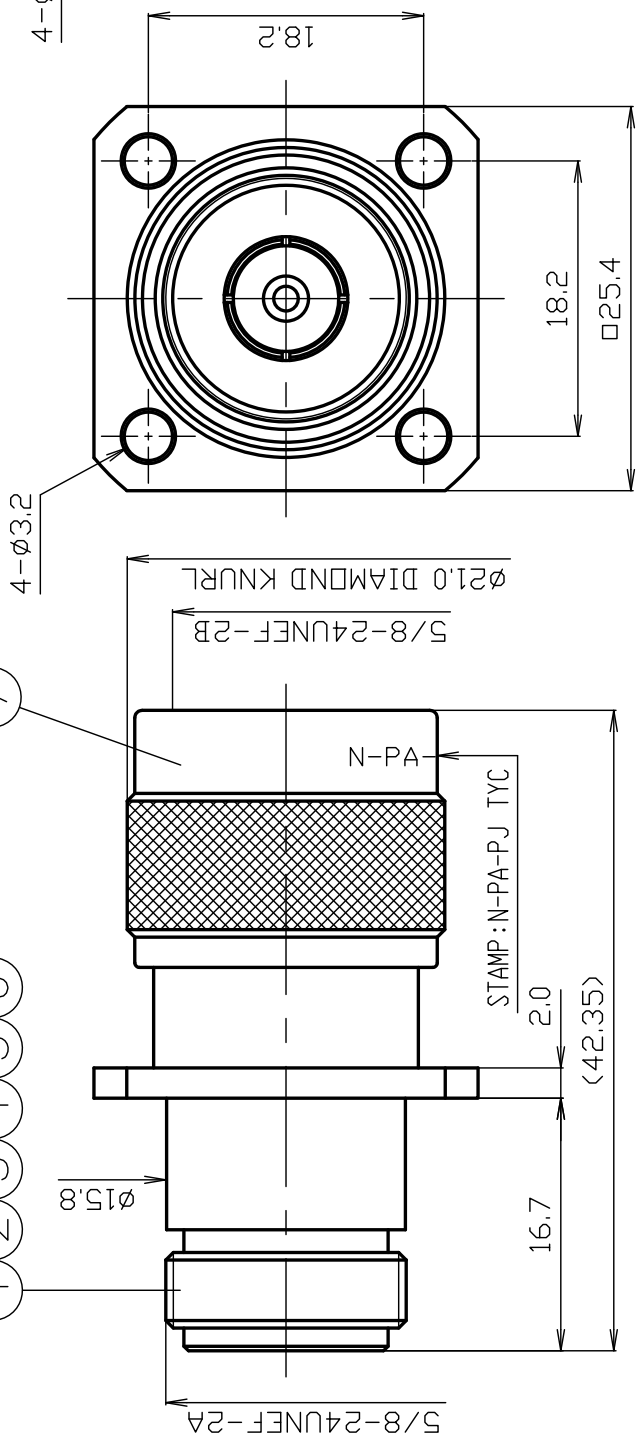

\*1: PHOSPHOR BRONZE

|     |               |          |      |        |  |  |        |            |            |           |           |
|-----|---------------|----------|------|--------|--|--|--------|------------|------------|-----------|-----------|
| 7   | COUPLING NUT  | BRASS    | 1    | Ni     |  |  | SCALE  | 2/1        | DRAWN      | INSPECTED | APPR      |
| 6   | GASKET        | SILICONE | 1    | --     |  |  |        |            | 渡邊         | 檜澤        | '23, '23, |
| 5   | OUTER CONTACT | BRASS    | 1    | Ni     |  |  |        |            | '23,12.06  | '23,12.06 |           |
| 4   | HOLDING RING  | *1       | 1    | --     |  |  |        |            | 直弘         |           |           |
| 3   | INSULATOR     | PTFE     | 2    | --     |  |  | UNIT   | mm         | PROJECTION |           |           |
| 2   | BODY          | BRASS    | 1    | Ni     |  |  | DATE   | 2023.12.06 |            |           |           |
| 1   | CENTER PIN    | *1       | 1    | Au     |  |  |        |            |            |           |           |
| NO. | DESCRIPTION   | MATERIAL | Q'TY | FINISH |  |  | REMARK |            |            |           |           |

# PRODUCT SPECIFICATION

Part number : N-PA-PJ

No. 0541352

Drawing number : X-0573657





Nominal 1 Standard JIS C 5411  
 2 Voltage rating AC 500V  
 3 Frequency range 10GHz  
 4 Impedance 50Ω  
 5 Operating Temperture Range -40°C ~ +85°C  
 6 Operating Humidity Range 95%RH(Max.) ※No condensation



|   |   | Test Items                             | Test Method/Value                                 | Remarks   |
|---|---|--|---|---|
| 1<br>E<br>L<br>E<br>C<br>T<br>R<br>I<br>C<br>A<br>L |   | Insulation Resistance                  | 1000MΩ(Min.) at DC 500V                           |   |
|   | 2 | Withstand voltage                      | 1 minute at AC 1000V                              |   |
|   | 3 | Contact resistance                     | 3mΩ(Max.)   |   |
|   | 4 | V.S.W.R                                | DC~3.5GHz : 1.2(Max.)<br>3.5GHz~10GHz : 1.3(Max.) |   |
| 5<br>M<br>E<br>C<br>H<br>A<br>N<br>I<br>C<br>A<br>L |   | Compatibility                          | No defects or abnormalities                       | Mating with connector complying with the standard |
|   | 6 | Center contact retaining force         | 0.98N(Min.)                                       | With a standard pin gauge                         |
|   | 7 | Tensile strength of coupling mechanism | 300N  | At axial tensile force                            |
| O<br>T<br>H<br>E<br>R<br>S                          |   |  |   |   |

※The structural shape is shown in the attached drawing (Drawing number:X-0573657)



| REVISIONS |  | DATE |
|-----------|--|------|
| 1         |  |      |
| 2         |  |      |
| 3         |  |      |

| Checked   | Approved  | Inspected   | Preparation  |
|---|---|---|--|
| <br>三<br>23.12.06<br>村 | <br>山<br>23.12.06<br>本 | <br>檜<br>23.12.06<br>澤 | <br>渡邊<br>'23,12,06<br>直弘 |

GKQM-24

## Looking for pricing, stock, or lifecycle information?

Click below to explore more details on WIN SOURCE:

-  [View N-PA-PJ on WIN SOURCE](#)
-  [TYCLON Information](#)

## Optimize Your Supply Chain with WIN SOURCE Solutions

-  Global Sourcing Solution
-  Obsolete Management
-  Cost Control Management
-  Shortage Management
-  Alternative Solution
-  Excess Inventory Management