

13 12 11 10 9 8 7 6 5 4

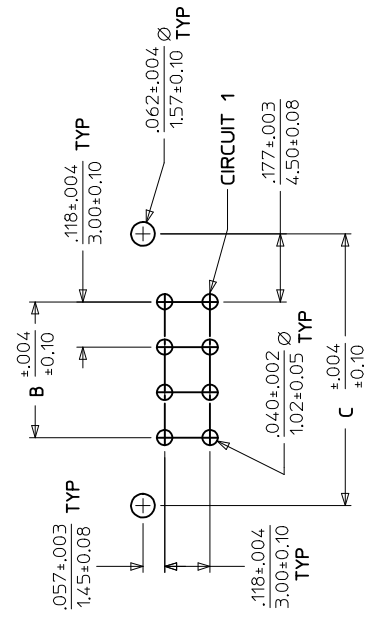
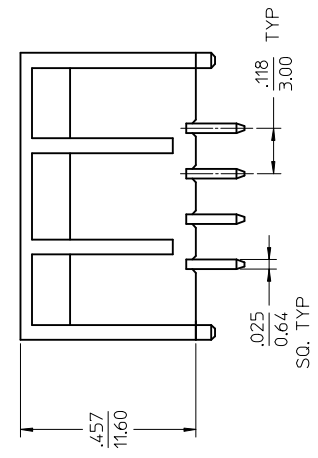
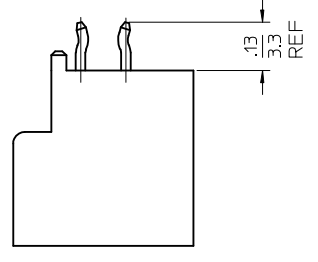
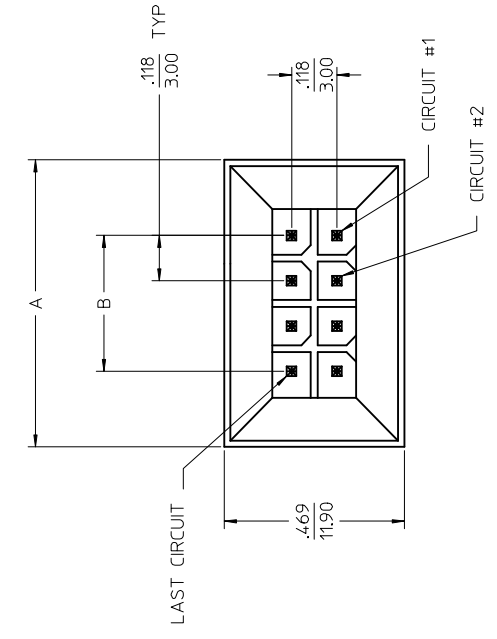

NOTES :

- MATERIALS -
HOUSING : NYLON , GLASS-FILLED, UL94V-0 COLOR - BLACK
TERMINAL : BRASS ALLOY
- FINISH:
A = .000200/(0.00508) MIN. TIN OVER .000050/(0.00127) MIN. NICKEL.
B = .000015/(0.00038) MIN. SELECT GOLD IN CONTACT AREA;
.000100/(0.00254) MIN. SELECT TIN ON SOLDER TAILS;
BOTH OVER .000050/(0.00127) MIN. NICKEL.
C = .000030/(0.00076) MIN. SELECT GOLD IN CONTACT AREA;
.000100/(0.00254) MIN. SELECT TIN ON SOLDER TAILS;
BOTH OVER .000050/(0.00127) MIN. NICKEL.
- PRODUCT SPECIFICATION : PS-44300-001
- PACKAGING SPECIFICATION : PK-44432-001
- THIS ASSEMBLY MATES WITH MOLEX BMI PANEL MOUNT RECEPTACLE (SEE DRAWING SD-44133-001) & FEMALE CRIMP TERMINAL (SEE DRAWING SD-43030-*****)
- SEE SHEET 2 FOR PART NUMBER CHART.
- THIS PART CONFORMS TO CLASS B REQUIREMENTS OF COSMETIC SPECIFICATION PS-45499-002

**PCB LAYOUT: COMPONENT SIDE
RECOMMENDED PCB THICKNESS .062/157**

ADD REFERENCE DIM	FC NO: UCP206-3971	DRW:CSLAFTR	2016/04/11	REV
	CHKD:JDFOX		2016/04/11	
	APP:FSM1TH		2016/04/13	
	DESCRIPTION			

QUALITY SYMBOLS	GENERAL TOLERANCES (UNLESS SPECIFIED)	DIMENSION STYLE
▽=0	MM INCH	IN/MM
▽=0	4 PLACES ± ---	DRAWN BY
▽=0	3 PLACES ± ---	MUELLER
	2 PLACES ± 0.25	CHECKED BY
	1 PLACE ± 0.38	MUELLER
	0 PLACE ± ---	APPROVED BY
	ANGULAR ±1/2°	FSM1TH
	DRAFT WHERE APPLICABLE MUST REMAIN WITHIN DIMENSIONS	MATERIAL NO.
		SEE CHART
		SIZE THIS DRAWING CONTAINED AND SH

12 11 10 9 8 7 6 5 4

13 12 11 10 9 8 7 6 5 4

MATERIAL NUMBER	NUMBER OF POSITIONS	PLATING OPTION
44432-0401	04	A
44432-0402	04	B
44432-0403	04	C
44432-0601	06	A
44432-0602	06	B
44432-0603	06	C
44432-0801	08	A
44432-0802	08	B
44432-0803	08	C
44432-1001	10	A
44432-1002	10	B
44432-1003	10	C
44432-1201	12	A
44432-1202	12	B
44432-1203	12	C
44432-1401	14	A
44432-1402	14	B
44432-1403	14	C
44432-1601	16	A
44432-1602	16	B
44432-1603	16	C
44432-1801	18	A
44432-1802	18	B
44432-1803	18	C
44432-2001	20	A
44432-2002	20	B
44432-2003	20	C
44432-2201	22	A
44432-2202	22	B
44432-2203	22	C
44432-2401	24	A
44432-2402	24	B
44432-2403	24	C

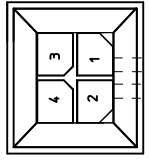

4 CIRCUIT

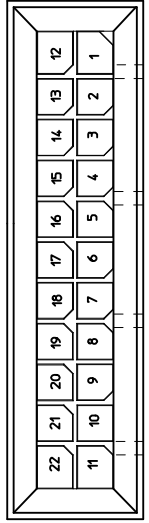

22 CIRCUIT

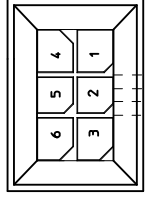

6 CIRCUIT

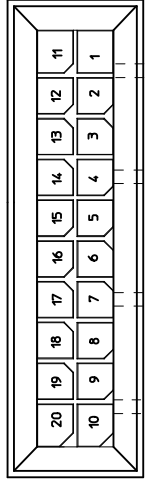

20 CIRCUIT

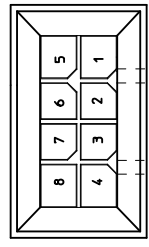

8 CIRCUIT

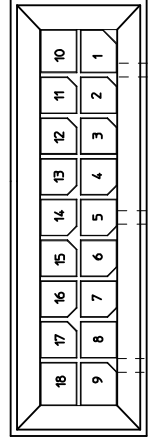

18 CIRCUIT

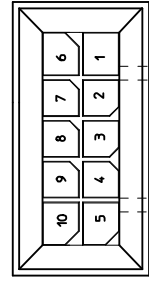

10 CIRCUIT

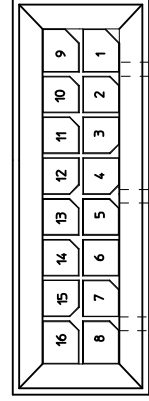

16 CIRCUIT

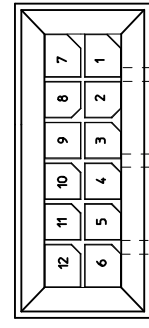

12 CIRCUIT

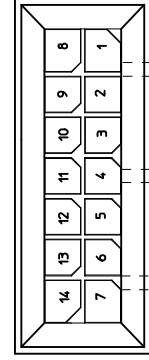

14 CIRCUIT

APPR:FSMITH 2016/04/13 CH:KDJ:JDFOX 2016/04/11 DRWN:CSLAFTER 2016/04/11 EC NO: UCP2016-3971 SEE SHEET 1	DESCRIPTION REV	QUALITY SYMBOLS ▽=0 ▽=0 ▽=0	GENERAL TOLERANCES (UNLESS SPECIFIED) mm ± --- INCH ± --- 4 PLACES ± --- 3 PLACES ± --- ± 0.10 2 PLACES ± 0.25 ± 0.15 1 PLACE ± 0.38 ± --- 0 PLACE ± --- ± ---	DIMENSION STYLE IN/MM DRAWN BY MUELLER DATE 1999/11/29 CHECKED BY MUELLER DATE 1999/11/29 APPROVED BY FSMITH DATE 2016/04/13 MATERIAL NO.
--	--------------------	--------------------------------------	---	---

SEE CHART

THIS DRAWING CONTAINS INCORPORATED AND S

12 11 10 9 8 7 6 5 4

Looking for pricing, stock, or lifecycle information?

Click below to explore more details on WIN SOURCE:

 [View 45750-3111 on WIN SOURCE](#)

 [Molex, LLC Information](#)

Optimize Your Supply Chain with WIN SOURCE Solutions

-  Global Sourcing Solution
-  Obsolete Management
-  Cost Control Management
-  Shortage Management
-  Alternative Solution
-  Excess Inventory Management