

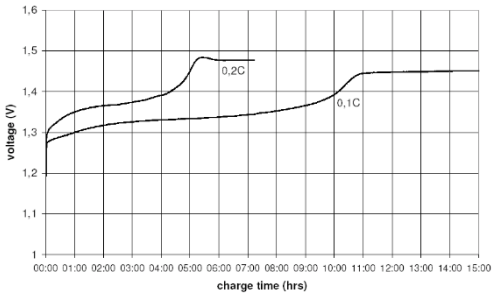

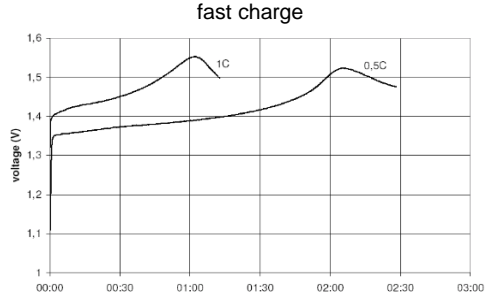

THE DATASHEET OF
1312-0038-XX

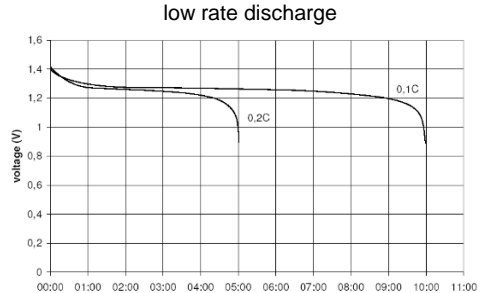
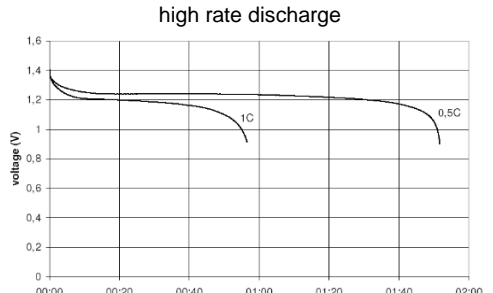
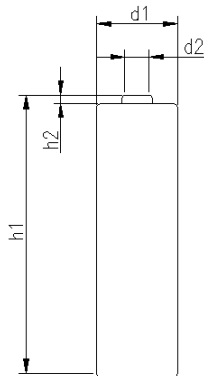

		Conditions	Diagrams
cell type:	NiMH		
cell size:	AA		
nominal voltage:	1.2 V		
max. charge voltage:	1.5 V	at standard charge (0.1C / 20°C)	standard charge 
capacity			
nominal:	1600 mAh	discharge at 0.2C	
minimum:	1600 mAh	discharge at 0.2C	
	1280 mAh	discharge at 1C	
		1.0V end discharge voltage	
		ta: 20°C	
max. continuous discharge current:	3200 mA	ta: 0...45°C	fast charge 
charge	current	time	
standard charge:	160 mA	15...17hrs	
quick charge:	800 mA	2.33hrs	
fast charge:	1600 mA	1.2hrs	
recommended charge termination control parameters:	0...5 mV 0.8...1 °C 45...50 °C	- ΔV (-deltaV) temperature rise per minute TCO (temperature cut off)	
trickle charge current:	10...30 mA	(recommended)	low rate discharge 
continuous overcharge: (less than 1 year)	≤ 80 mA	no conspicuous deformation no leakage	
internal resistance: (impedance)	≤ 35 mΩ	at 1KHz battery fully charged	
life expectancy:	≥ 500 cycles	acc. IEC standard	
self discharge			
charge retention:	≥ 75 %	after 12 months storage at 20°C	
initial capacity:	≥ 900 mAh	within 30 days after delivery discharge at 0.2C	
ambient temperature range:	0...40 °C 10...35 °C -10...65 °C -20...50 °C -20...45 °C -20...35 °C	standard charge fast charge discharge storage (≤1months) storage (≤6months) storage (≤12months)	high rate discharge 
QCT1:	20/1250/45		
QCT2:	30/1150/50		
mechanical specifications			
cell dimensions			
diameter d1:	max. 14.4 - 0.7	mm	
diameter d2:	5.5	mm	
height h1:	50.5 - 0.5	mm	
height h2:	min. 1.2	mm	
weight:	23 ±1	g	



	ANSMANN Specifications for model:	NiMH Battery
		AA - 1600mAh low self discharge
	data sheet no. / part no.	1302-0021
	s.n.	705294
	author / date	Cweiland / 11.09.2023

Looking for pricing, stock, or lifecycle information?

Click below to explore more details on WIN SOURCE:

- [⊖ View 1312-0038-XX on WIN SOURCE](#)
- [⊖ ANSMANN \(Huizhou\) Trading CO., LTD Information](#)

Optimize Your Supply Chain with WIN SOURCE Solutions

- ✓ Global Sourcing Solution
- ✓ Obsolete Management
- ✓ Cost Control Management
- ✓ Shortage Management
- ✓ Alternative Solution
- ✓ Excess Inventory Management