



# 89 Series



## Metal-Mite® Aluminum Housed Axial Terminal Wirewound, 1% Tolerance



The 89 Series is a high-performance axial type resistor. These molded-construction metal-housed resistors are available in higher power ratings than standard axial resistors and are better suited to withstanding vibration, shock and harsh environmental conditions.

The 89 Series Metal-Mite® resistors are aluminum housed to maintain high stability during operation and to permit secure mounting to chassis surfaces.

The metal housing also provides heat-sinking capabilities.

### FEATURES

- High Stability:  $\pm 0.5\% \Delta R$
- High power to size ratio
- Metal housing allows chassis mounting and provides heat sink capability

### SERIES SPECIFICATIONS

Series	Wattage	Ohms	Voltage
805	5	0.10-25K	210
810	10	0.10-50K	320
825	25	0.010-75K	520
850	50	0.005-100K	1170

Non-Inductive versions available. Insert "N" before tolerance code.  
Example: 850NF560

### CHARACTERISTICS

<b>Housing</b>	Metal, anodized aluminum
<b>Internal Coating</b>	Silicone
<b>Core</b>	Ceramic
<b>Terminals</b>	Solder-coated axial
<b>Derating</b>	Linearly from 100% @ +25°C to 0% @ +275°C.
<b>Tolerance</b>	$\pm 1\%$ and $\pm 5\%$ (other tolerances available).
<b>Power rating</b>	Rating is based on chassis mounting area and temperature stability. Proper heat sink as follows: 5W and 10W units, 4" x 6" x 2" x .040" Aluminum chassis; 25W units, 5" x 7" x 2" x .040" Aluminum chassis; 50W units, 12" x 12" x .059" Aluminum panel.
<b>Maximum ohmic values</b>	See chart.
<b>Overload</b>	5 times rated wattage for 5 seconds.
<b>Temperature coefficient</b>	Under 1 $\Omega$ : $\pm 90$ ppm/°C; 1 to 9.99 $\Omega$ : $\pm 50$ ppm/°C; 10 $\Omega$ and over: $\pm 20$ ppm/°C.
<b>Dielectric withstanding voltage</b>	5W and 10W rating, 1000 VAC; 25 and 50W ratings, 2250 VAC.

(continued)

# 89 Series

## Metal-Mite® Aluminum Housed Axial Terminal Wirewound, 1% Tolerance

### DIMENSIONS

(in./mm)

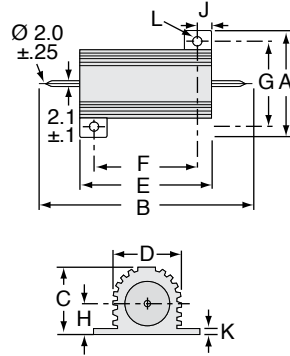

Dimensions have changed  
as of August 2015

	A max.	B max.	C ±0.25mm	D max.	E ±0.1mm	F ±.3mm	G ±.3mm	H max.	J max.	K max.	L ±.25mm
805	0.65" / 16.5	1.18" / 30.0	0.32" / 8.25	0.33" / 8.5	0.62" / 15.80	0.44" / 11.3	0.49" / 12.4	0.18" / 4.5	0.09" / 2.4	0.07" / 1.8	0.09" / 2.4
810	0.83" / 21.0	1.44" / 36.5	0.42" / 10.72	0.44" / 11.2	0.78" / 19.80	0.56" / 14.3	0.63" / 15.9	0.22" / 5.5	0.11" / 2.8	0.07" / 1.8	0.09" / 2.4
825	1.10" / 28.0	2.01" / 51.0	0.56" / 14.35	0.56" / 14.2	1.07" / 27.20	0.72" / 18.3	0.78" / 19.8	0.30" / 7.7	0.20" / 5.2	0.10" / 2.6	0.13" / 3.2
850	1.10" / 28.0	2.85" / 72.5	0.56" / 14.35	0.56" / 14.2	1.93" / 49.00	1.56" / 39.7	0.84" / 21.4	0.33" / 8.4	0.20" / 5.2	0.10" / 2.6	0.13" / 3.2

### ORDERING INFORMATION

Ohmic value	Wattage				Ohmic value	Wattage				Ohmic value	Wattage						
	Part No. Prefix Suffix	5	10	25		50	Part No. Prefix Suffix	5	10		25	50	Part No. Prefix Suffix	5	10	25	50
0.005	---R005			✓	✓	20	---20R	✓	✓			1,500	---1K5	✓	♦	♦	✓
0.010	---R010			✓	✓	25	---25R	✓	✓	✓		2,000	---2K0	✓	✓	♦	♦
0.025	---R025			✓	✓	30	---30R	♦	♦			2,500	---2K5	✓	✓		
0.1	---R10			✓	✓	40	---40R	♦	♦			3,000	---3K0	✓	✓	✓	♦
0.3	---R30			✓	♦	50	---50R	✓	✓	✓		3,500	---3K5	♦	♦		
0.5	---R50			✓	♦	75	---75R	✓	♦	✓		4,000	---4K0	✓	✓		
0.7	---R70			♦	♦	100	---100	✓	✓	✓		4,500	---4K5	♦	♦		
1.0	---1R0	✓	✓	✓	✓	150	---150	✓	✓	✓		5,000	---5K0	✓	✓	✓	✓
1.5	---1R5	♦	✓			200	---200	♦	♦	✓		6,000	---6K0	♦	♦		
2.0	---2R0	♦	✓	✓	✓	250	---250	✓	✓	✓		10,000	---10K	✓	♦	✓	✓
3.0	---3R0	✓	✓	✓	✓	300	---300	✓	♦			15,000	---15K	✓	✓	♦	♦
4.0	---4R0	♦	✓			400	---400	♦	♦			20,000	---20K	♦	♦		
5.0	---5R0	✓	✓	✓	✓	500	---500	♦	♦	✓		25,000	---25K	✓	♦	♦	♦
10.0	---10R	✓	✓	✓	✓	750	---750	♦	♦	✓		50,000	---50K	♦	♦		
15.0	---15R	✓	✓	✓	✓	1,000	---1K0	♦	✓	✓		75,000	---75K	♦	♦		
												100,000	---100K	♦	♦		

Non-Inductive Winding  
Optional (blank = std. winding) RoHS Compliant

805NF5R0E

Series: 805 = 5 Watt, 810 = 10 watt, 825 = 25 watt, 850 = 50 watt  
Tolerance: F = 1%, J = 5%  
Ohms: R005 = 0.005Ω, R10 = 0.1Ω, 1R0 = 1.0Ω, 250 = 250Ω, 1K0 = 1,000Ω, 1K5 = 1,500Ω, 25K = 25,000Ω

✓ = Standard values

♦ = Non-standard values subject to minimum handling charge per item

Shaded values involve very fine resistance wire and should not be used in critical applications without burn-in and/or thermal cycling.

As of September 2006,  
the 89 Series is no longer  
offered as Mil. Spec.

## Looking for pricing, stock, or lifecycle information?

Click below to explore more details on WIN SOURCE:

 [View 805F4R0E on WIN SOURCE](#)

 [Ohmite Information](#)

## Optimize Your Supply Chain with WIN SOURCE Solutions

-  Global Sourcing Solution
-  Obsolete Management
-  Cost Control Management
-  Shortage Management
-  Alternative Solution
-  Excess Inventory Management