



THE DATASHEET OF
971-037-040R011



SHELL

S
1.00.354 [9.0]
CREW

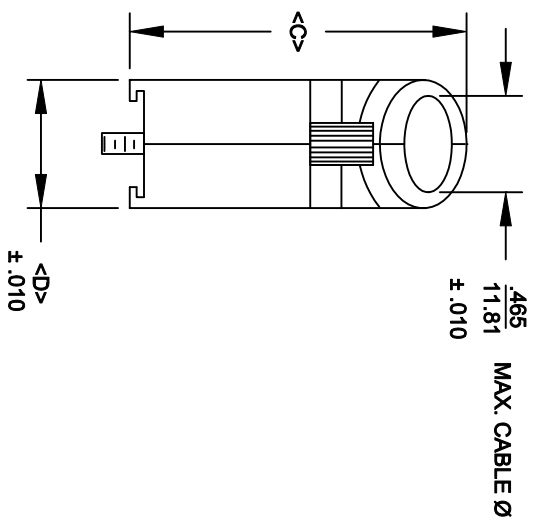
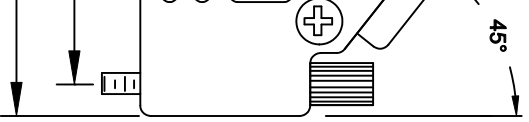

971-YYY-040R011

SERIES _____

POSITIONS _____

009 _____

015 _____

025 _____

037 _____

MATERIAL _____

040 = ZINC _____

COLOR: _____

01 = BLACK _____

PUT-UPS _____

1 = KIT _____

POS.	A B C D			
	A	B	C	D
9	1.220	.984	1.496	570
	30.99	24.99	38.00	14.48
15	1.595	1.312	1.618	570
	40.51	33.32	41.10	14.48
25	2.114	1.852	1.646	570
	53.70	47.04	41.81	14.48
37	2.748	2.500	1.646	570
	69.80	63.50	41.81	14.48

N

THESE DRAWINGS AND SPECIFICATIONS ARE THE PROPERTY OF NorComp AND SHALL NOT BE REPRODUCED, COPIED OR USED AS THE BASIS FOR THE MANUFACTURE OR SALE OF APPARATUS WITHOUT WRITTEN PERMISSION.

DRAWN: PAM JENKINS DATE: 6-10-05

CHECKED: DATE:

NorComp

SCALE SHEET 1 OF 1 REV 7

DWG NO. 971-YYY-040R011

Looking for pricing, stock, or lifecycle information?

Click below to explore more details on WIN SOURCE:

 [View 971-037-040R011 on WIN SOURCE](#)

 [NorComp Inc. Information](#)

Optimize Your Supply Chain with WIN SOURCE Solutions

-  Global Sourcing Solution
-  Obsolete Management
-  Cost Control Management
-  Shortage Management
-  Alternative Solution
-  Excess Inventory Management