



THE DATASHEET OF
1052TR



THRU-HOLE (THM) & SURFACE MOUNT (SMT) COIN CELL HOLDERS

23mm to 30mm COIN CELL HOLDERS

23mm

- Advanced air-flow design enhances air circulation around battery
- Unique notched slots assure quick and easy battery insertion and replacement

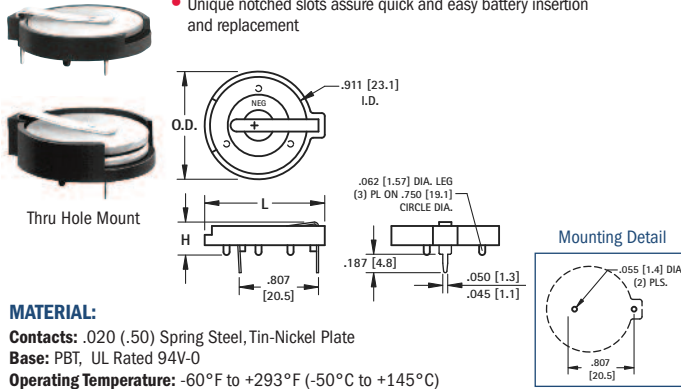

MATERIAL:

Contacts: .020 (.50) Spring Steel, Tin-Nickel Plate

Base: PBT, UL Rated 94V-0

Operating Temperature: -60°F to +293°F (-50°C to +145°C)

| CAT. NO. | H | L | O.D. | NO. OF CELLS | BATTERY REFERENCE |
|----------|-------------|--------------|--------------|------------------------------|--|
| 104 | .335 (8.5) | 1.150 (29.2) | 1.000 (25.4) | (1) Cell (Any 23mm) | BR2320, CR2320, CL2325, DL2330, CL2354, CR2335 |
| 107 | .335 (8.5) | 1.219 (31.0) | 1.093 (27.8) | (1) Cell (Any 23mm) | (1) 2354 |
| 1027 | .452 (11.5) | 1.219 (31.0) | 1.093 (27.8) | (2) 2320, (2) 2325, (2) 2330 | |

AVAILABLE ON TAPE AND REEL

- SMT solder tail with "Flow-Hole" design for increased joint strength
- Viewable solder tails assures reliable joint inspection
- All conductive polystyrene carrier tape meets ANSI/EIA - 481 standard

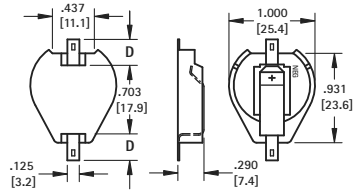

Surface Mount

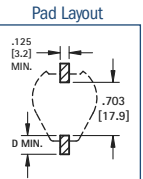

MATERIAL:

Contacts: .015 (.38) Steel

Base: High Temp Nylon 46, UL Rated 94V-0

Operating Temperature: -60°F to +293°F (-50°C to +145°C)

| Tin-Nickel Plate | | Gold Plate (Flash) | | D PAD SIZE | BATTERY REFERENCE |
|----------------------|----------------------|----------------------|----------------------|------------|--|
| CAT. NO. BULK & REEL | CAT. NO. BULK & REEL | CAT. NO. BULK & REEL | CAT. NO. BULK & REEL | | |
| 1071 | 1071TR | 1091 | 1091TR | .156 (4.0) | CR2320, CL2325, 1073, 1073TR, 1083, 1083TR |
| | | | | .278 (7.1) | DL2330, CR2335 |

Tape & Reel Spec's: 44mm wide; 32mm pitch; 13 inch reel, (200 pieces per reel)

24mm

- Advanced air-flow design enhances air circulation around battery
- Unique notched slots assure quick and easy battery insertion and replacement

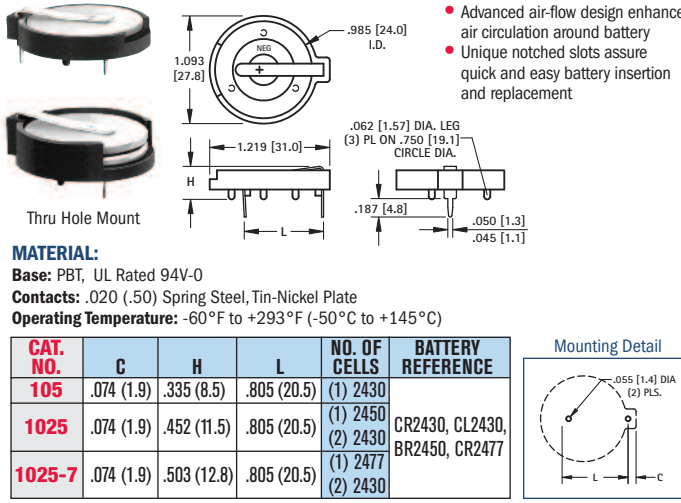

MATERIAL:

Base: PBT, UL Rated 94V-0

Contacts: .020 (.50) Spring Steel, Tin-Nickel Plate

Operating Temperature: -60°F to +293°F (-50°C to +145°C)

| CAT. NO. | C | H | L | NO. OF CELLS | BATTERY REFERENCE |
|----------|------------|-------------|-------------|--------------------|--------------------------------|
| 105 | .074 (1.9) | .335 (8.5) | .805 (20.5) | (1) 2430 | CR2430, CL2430, BR2450, CR2477 |
| 1025 | .074 (1.9) | .452 (11.5) | .805 (20.5) | (1) 2450, (2) 2430 | |
| 1025-7 | .074 (1.9) | .503 (12.8) | .805 (20.5) | (1) 2477, (2) 2430 | |

- Polarized holder
- Mounts securely for wave soldering
- Reliable spring tension assures low contact resistance

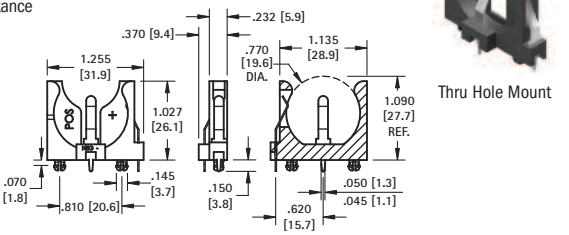

Thru Hole Mount

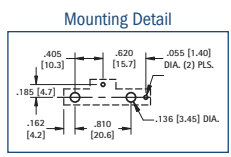

MATERIAL:

Base: PBT, UL Rated 94V-0

Contacts: .020 (.50) Spring Steel, Tin-Nickel Plate

Operating Temperature: -60°F to +293°F (-50°C to +145°C)

| CAT. NO. | BATTERY REFERENCE |
|----------|------------------------|
| 1068 | (1) CR2450, (1) CL2450 |

24mm TOP Loading

- Battery "Pop-in" from Top for automated assembly
- No tools required
- Finger pressure battery release

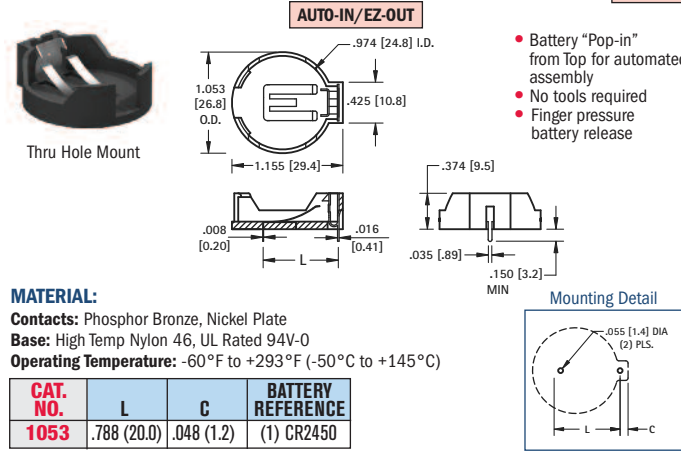

MATERIAL:

Contacts: Phosphor Bronze, Nickel Plate

Base: High Temp Nylon 46, UL Rated 94V-0

Operating Temperature: -60°F to +293°F (-50°C to +145°C)

| CAT. NO. | L | C | BATTERY REFERENCE |
|----------|-------------|------------|-------------------|
| 1053 | .788 (20.0) | .048 (1.2) | (1) CR2450 |

AVAILABLE ON TAPE AND REEL

- Polarized holder
- Low profile for densely packed PCB's
- Compatible with vacuum and mechanical pick & place systems
- Conductive carrier tape meets ANSA/EIA- 481 standard

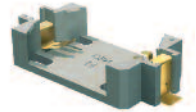
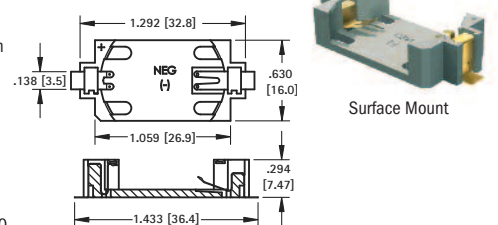

Surface Mount

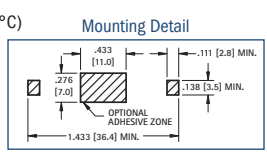

MATERIAL:

Base: LCP, UL Rated 94V-0

Contacts: .006 (.15) Phosphor Bronze, Gold Plate (Flash)

Operating Temperature: -60°F to +293°F (-50°C to +145°C)

| CAT. NO. BULK & REEL | ON TAPE & REEL | BATTERY REFERENCE |
|----------------------|----------------|-------------------|
| 1052 | 1052TR | (1) CR2450 |

Tape & Reel Spec's: 56mm wide; 20mm pitch; 13 inch reel, (400 pieces per reel)

30mm

- Advanced air-flow design enhances air circulation around battery
- Unique notched slots assure quick and easy battery insertion and replacement

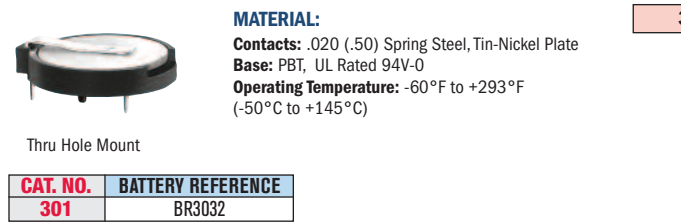

| CAT. NO. | BATTERY REFERENCE |
|----------|-------------------|
| 301 | BR3032 |

MATERIAL:

Contacts: .020 (.50) Spring Steel, Tin-Nickel Plate

Base: PBT, UL Rated 94V-0

Operating Temperature: -60°F to +293°F (-50°C to +145°C)

Looking for pricing, stock, or lifecycle information?

Click below to explore more details on WIN SOURCE:

- ⊖ [View 1052TR](#) on WIN SOURCE
- ⊖ [Keystone Electronics](#) Information

Optimize Your Supply Chain with WIN SOURCE Solutions

- ✓ Global Sourcing Solution
- ✓ Obsolete Management
- ✓ Cost Control Management
- ✓ Shortage Management
- ✓ Alternative Solution
- ✓ Excess Inventory Management