



**THE DATASHEET OF
TL2201OAZA**



TL2201, TL2202, TL4201 SERIES PUSHBUTTON SWITCH

ANTI-VANDAL SWITCHES
DETECTOR SWITCHES
DIP SWITCHES
KEYLOCK SWITCHES
NAVIGATION SWITCHES
PUSHBUTTON SWITCHES
ROCKER SWITCHES
ROTARY SWITCHES
SLIDE SWITCHES
SNAP ACTION SWITCHES
TACTILE SWITCHES
TOGGLE SWITCHES
CAP OPTIONS



APPLICATIONS / MARKETS

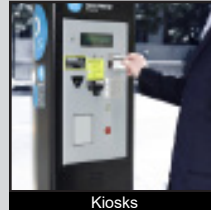
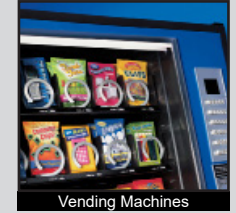

RoHS

SPECIFICATIONS

Electrical Rating: 100mA, 30VDC
Electrical Life: 10,000 Cycles
Contact Resistance: 100mΩ Max. Initial
Insulation Resistance: 100MΩ Min.
Dielectric Strength: 500VAC
Operating Temperature: -20°C to 70°C
Function: Latching or momentary
Travel: 2.5mm Full; 1.5mm to Lock Position
Circuit, Timing, Actuation Force:
TL2201: DPDT, Non-Shorting (BBM), 220 ±50gf
TL2202: DPDT, Shorting (MBB), 220 ±50gf
TL4201: 4PDT, Non-Shorting (BBM), 300 ±70gf

FEATURES & BENEFITS

- Through hole mounting design
- PC Pin termination
- Latching or momentary function
- Plunger actuator; long travel
- Many cap options

PART NUMBER CONFIGURATOR

Series

TL2201 - DPDT; Non-Shorting (BBM)
 TL2202 - DPDT; Shorting (MBB)
 TL4201 - 4PDT; Non-Shorting (BBM)

Mechanical Config.

EE - Latching
 OA - Momentary

Actuator

X - 2.0mm x 3.0mm
 Y - 3.3mm square
 Z - 2.8mm square

Termination

A - Straight
 B - Retention

Cap Option

None
 1C - Z actuator only
 1D - Z actuator only
 1R - Z actuator only
 1S - Z actuator only
 .08 - Y actuator only
 .09 - Y actuator only
 .094 - Y actuator only
 4J - Y actuator only
 5J - Y actuator only
 6J - Y actuator only
 8J - Y actuator only
 TA12 - Y actuator only
 TAC - Y actuator only
 TAD - Y actuator only
 TAG - Y actuator only
 TAM - Y actuator only
 1CF - X actuator only
 1DF - X actuator only

Cap Color

None
 BLK - Black
 GRY - Grey
 DGR - Dark Grey
 LGR - Light Grey
 WHT - White
 BLU - Blue
 RED - Red
 YEL - Yellow
 GRN - Green

Specifications subject to change without notice 1.1.2026



E-SWITCH®

www.e-switch.com

800.867.2717

1

TL2201, TL2202, TL4201 SERIES PUSHBUTTON SWITCH

BODY DIMENSIONS TL2201 & TL2202

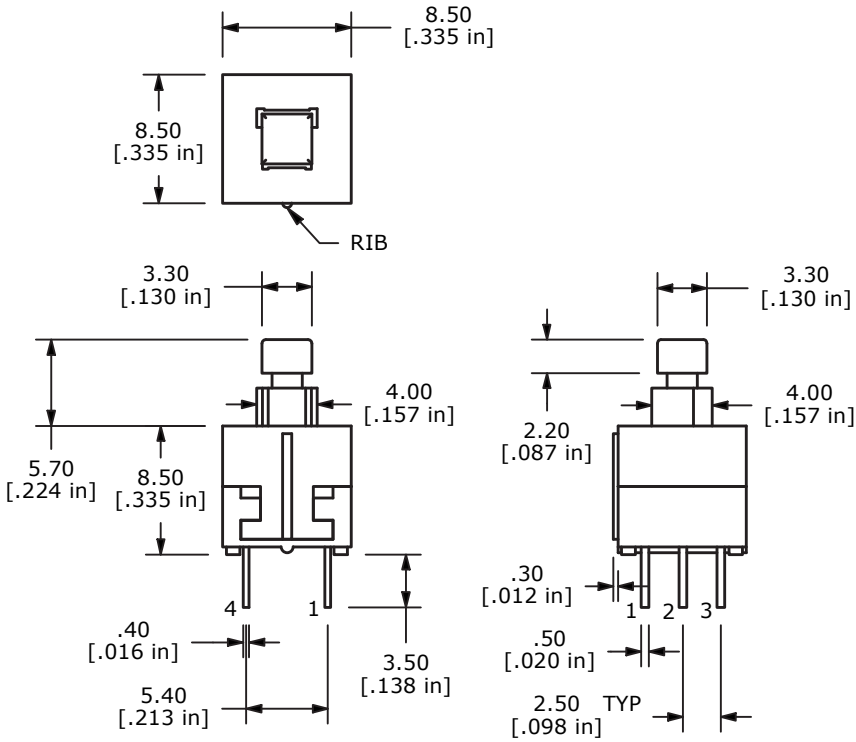

*SHOWN WITH Y ACTUATOR AND A TERMINATION

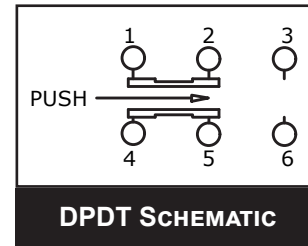
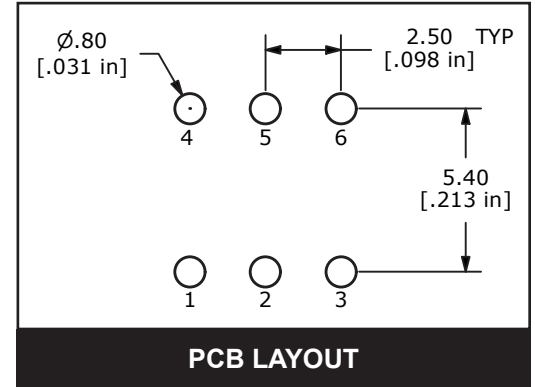

SWITCH FUNCTION	
POS. 1	POS. 2
ON	ON
2-1, 5-4	2-3, 5-6

BODY DIMENSIONS TL4201

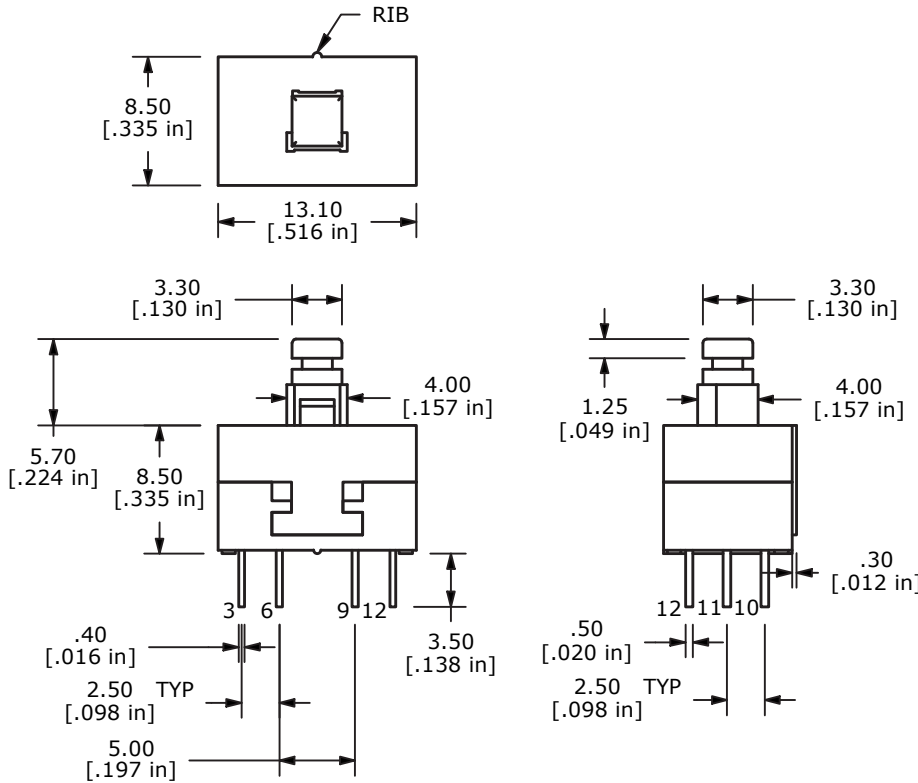

*SHOWN WITH Y ACTUATOR AND A TERMINATION

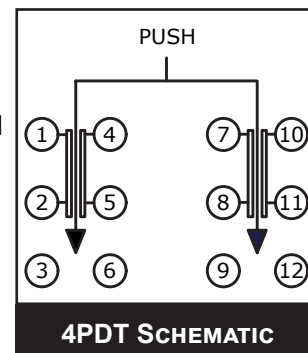
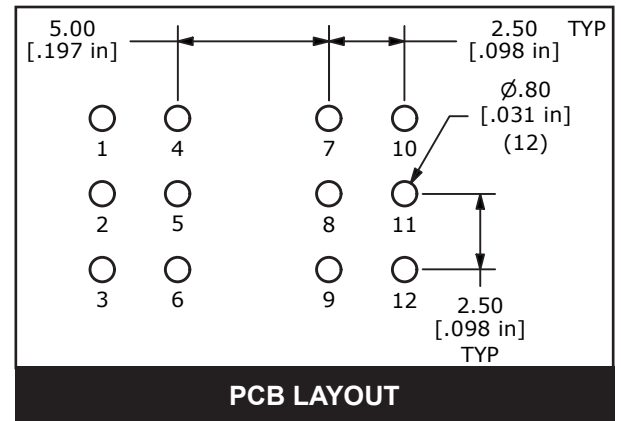

SWITCH FUNCTION	
POS. 1	POS. 2
ON	ON
1-2,4-5 7-8,10-11	2-3,5-6 8-9,11-12



ANTI-VANDAL SWITCHES
DETECTOR SWITCHES
DIP SWITCHES
KEYLOCK SWITCHES
NAVIGATION SWITCHES
PUSHBUTTON SWITCHES
ROCKER SWITCHES
ROTARY SWITCHES
SLIDE SWITCHES
SNAP ACTION SWITCHES
TACTILE SWITCHES
TOGGLE SWITCHES
CAP OPTIONS

TL2201, TL2202, TL4201 SERIES PUSHBUTTON SWITCH

TL2201 & TL2202

TL4201

TERMINATION OPTIONS

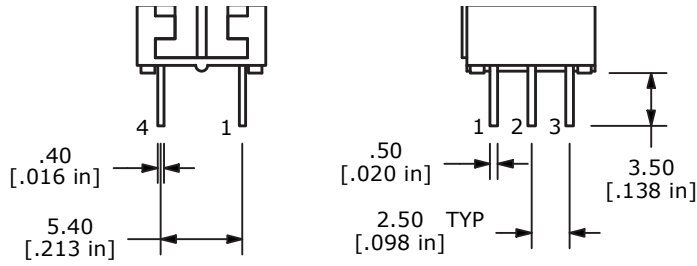

A - STRAIGHT

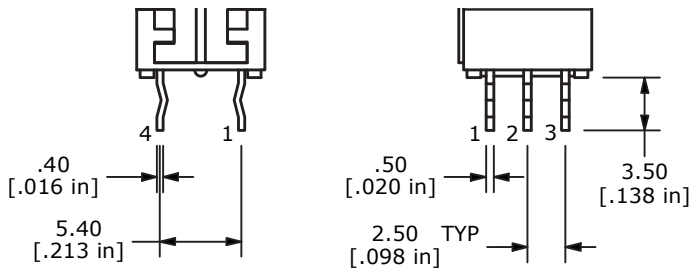

B - RETENTION

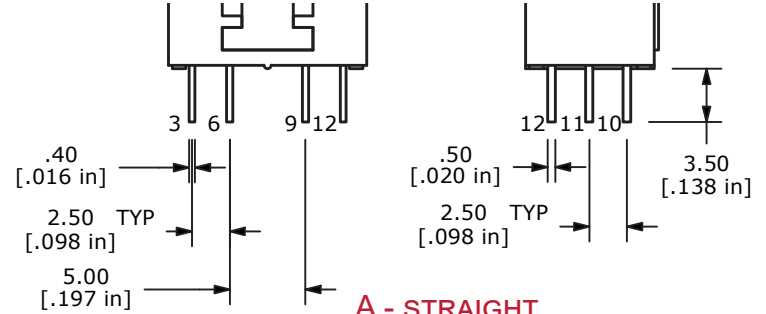

A - STRAIGHT

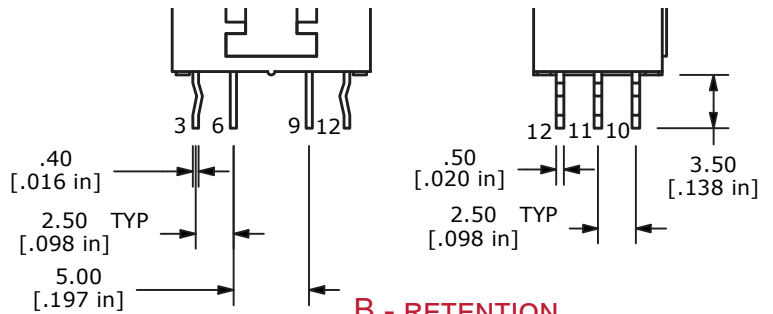

B - RETENTION

ACTUATOR OPTIONS

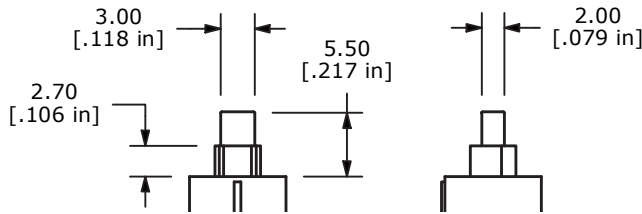

X - 2.0MM X 3.0MM

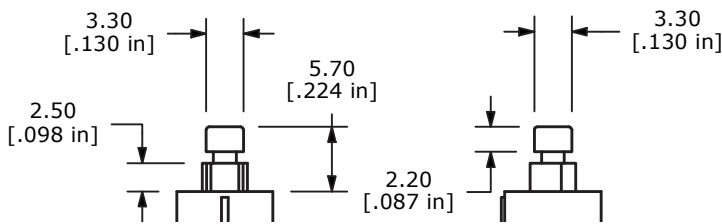

Y - 3.3MM SQUARE

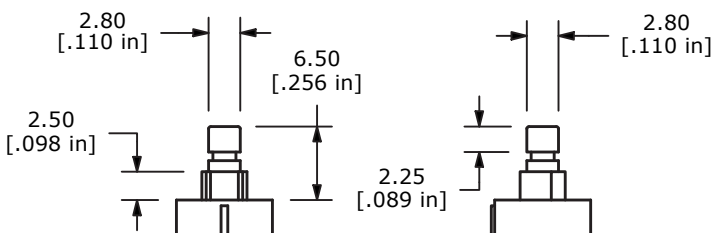

Z - 2.8MM SQUARE

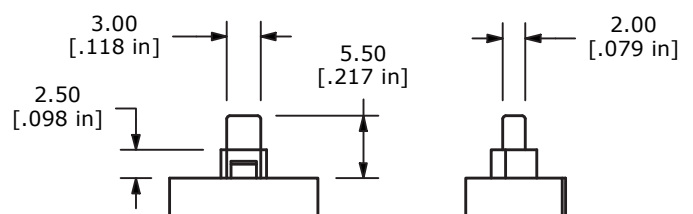

X - 2.0MM X 3.0MM

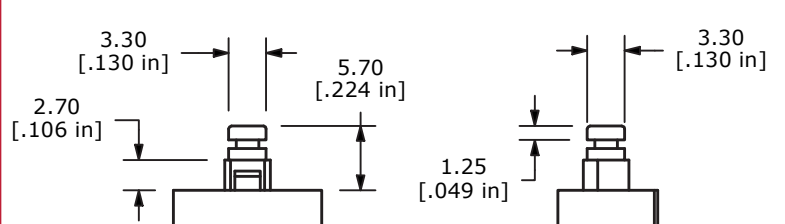

Y - 3.3MM SQUARE

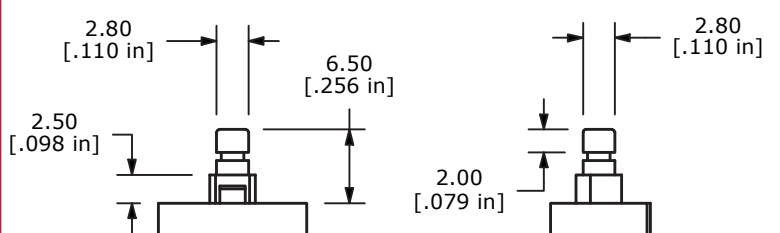

Z - 2.8MM SQUARE



ANTI-VANDAL SWITCHES
 DETECTOR SWITCHES
 DIP SWITCHES
 KEYLOCK SWITCHES
 NAVIGATION SWITCHES
PUSHBUTTON SWITCHES
 ROCKER SWITCHES
 ROTARY SWITCHES
 SLIDE SWITCHES
 SNAP ACTION SWITCHES
 TACTILE SWITCHES
 TOGGLE SWITCHES
 CAP OPTIONS

Looking for pricing, stock, or lifecycle information?

Click below to explore more details on WIN SOURCE:

 [View TL2201OAZA on WIN SOURCE](#)

 [E-SWITCH](#) Information

Optimize Your Supply Chain with WIN SOURCE Solutions

-  Global Sourcing Solution
-  Obsolete Management
-  Cost Control Management
-  Shortage Management
-  Alternative Solution
-  Excess Inventory Management