

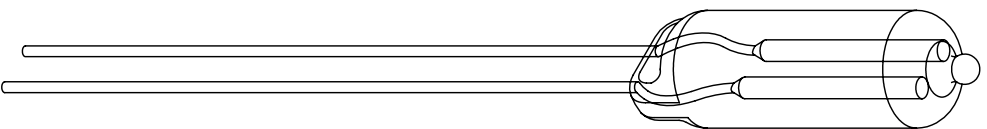

**THE DATASHEET OF
GT-RLSA80SS**

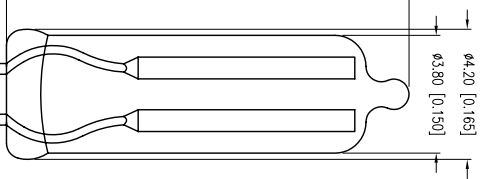

PART NUMBER	GT-RLSA80SS		REV.	A
DATE	12.18.06		REV.	A
E.C.N.	#11148		E.C.N. NUMBER AND REVISION COMMENTS	



ELECTRICAL SPECIFICATIONS

PARAMETER	VALUE	TEST CONDITION
DC FIRING VOLTAGE	80±15% DC	(4v/dt 100V/S)
IMPULSE FIRING VOLTAGE	800V DC MAX.	(4v/dt 5M/μS)
IMPULSE CURRENT	1.5KA MAX.	(8*20μS)
IMPULSE SURGE LIFE	1000 TIMES MIN.	(8*20μS)
DC HOLD/OVER CURRENT	50V DC	(150ms MAX.)
AC DISCHARGE CURRENT	1A	(15μS TIMES)
AC FOLLOW-ON CURRENT	1A	
INSULATION RESISTANCE	10 ⁹ Ω/IN	
INTER-ELECTRODE CAPACITANCE	1.0 pF MAX	(50V DC MIN.)

ENVIRONMENTAL SPECIFICATIONS PER MIL-STD 202

TEST	METHODE	CONDITION	RATING
THERMAL SHOCK	107	B	-65 TO +125C
HUMIDITY	103B	B	95%RH HUMIDITY
TEMPERATURE CYCLING	102A	C	-65 TO +125C
OPERATING TEMP.			-40 TO +100C

X±H1 (+0.039), X±H0.5 (+0.020), XXX=±0.25 (+0.010), XXXX=±0.127 (+0.005), LEAD SIZE=±0.05 (+0.002), LEAD LENGTH=±0.75 (+0.030), MIN=-0.00

0.35 [0.014]
(2 PLS.)

HELEN ROAD
E. I. L. 60067-6976
+1.847.359.2790
1.847.359.6538
WWW.LUMEX.COM

LIGHT DUTY RADIAL LEADED ARRESTOR.

THE SPECIFICATIONS MAY CHANGE AT ANY TIME WITHOUT NOTICE DUE TO NEW MATERIALS OR PRODUCT IMPROVEMENT

CONFIDENTIAL INFORMATION
THE INFORMATION CONTAINED IN THIS DOCUMENT IS THE PROPERTY OF LUMEX INC. EXCEPT AS SPECIFICALLY AUTHORIZED IN WRITING BY LUMEX INC., THE HOLDER OF THIS DOCUMENT SHALL KEEP ALL INFORMATION CONTAINED HEREIN CONFIDENTIAL AND SHALL PROTECT SAME IN WHOLE OR IN PART FROM DISCLOSURE AND DISSEMINATION TO ALL THIRD PARTIES.

DATE:	12.18.06	DRAWN BY:	JC
PAGE:	1 OF 1	CHKD BY:	KF
SCALE:	NTS	APRVD BY:	BC
UNIT:	mm [INCH]		

UNCONTROLLED DOCUMENT



Looking for pricing, stock, or lifecycle information?

Click below to explore more details on WIN SOURCE:

- ⊖ [View GT-RLSA80SS on WIN SOURCE](#)
- ⊖ [Lumex Opto/Components Inc. Information](#)

Optimize Your Supply Chain with WIN SOURCE Solutions

- ✓ Global Sourcing Solution
- ✓ Obsolete Management
- ✓ Cost Control Management
- ✓ Shortage Management
- ✓ Alternative Solution
- ✓ Excess Inventory Management