

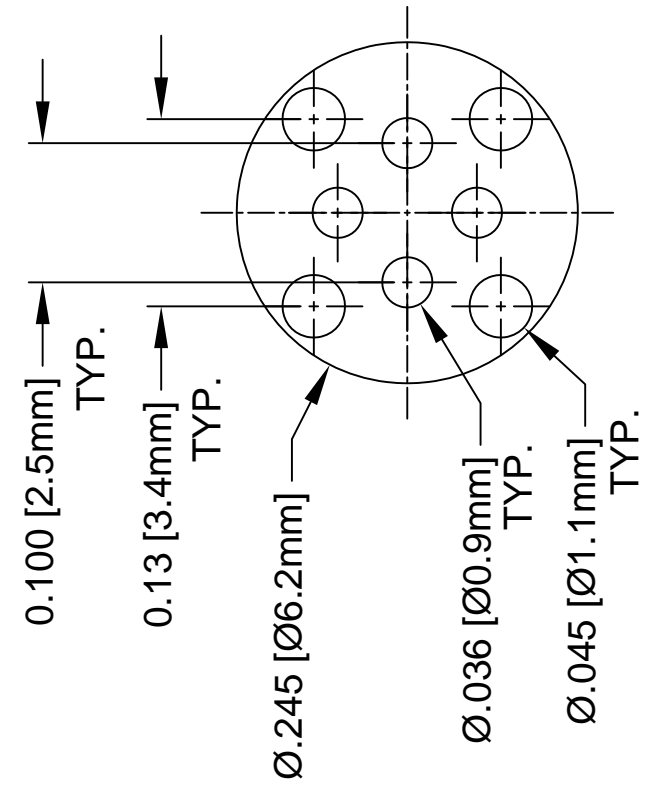

THE DATASHEET OF
102-130



REV.	
B	Engineering Update
C	Removed Material C



PART NO.	H	T	F
102-050	.050 (1.3)	.030 (.76)	.010 (.25)
102-060	.060 (1.5)	.030 (.76)	.015 (.38)
102-070	.070 (1.8)	.030 (.76)	.020 (.51)
102-080	.080 (2.0)	.030 (.76)	.025 (.64)
102-090	.090 (2.3)	.030 (.76)	.030 (.76)
102-100	.100 (2.5)	.030 (.76)	.035 (.89)
102-110	.110 (2.8)	.030 (.76)	.040 (1.0)
102-120	.120 (3.0)	.030 (.76)	.045 (1.1)

PART NO.	H	T
102-130	.130 (3.3)	.030 (.76)
102-140	.140 (3.6)	.030 (.76)
102-150	.150 (3.8)	.030 (.76)
102-160	.160 (4.1)	.030 (.76)
102-170	.170 (4.3)	.030 (.76)
102-180	.180 (4.6)	.030 (.76)
102-190	.190 (4.8)	.030 (.76)
102-200	.200 (5.1)	.030 (.76)

- MATERIAL: NYLON 6/6, 94V-2, WHITE.
- GENERAL SPECIFICATIONS: BIVAR MOLDED COMPONENT SPECIFICATION BV00-E101.

STANDARD TOLERANCES
(UNLESS OTHERWISE SPECIFIED)

DECIMALS	ANGLES
.X ±.1	X°
.XX ±.01	
.XXX ±.005	

DESIGNED: **M. Chen** DATE: **04/1**

CHECKED: **D. Green** DATE: **04/1**

Looking for pricing, stock, or lifecycle information?

Click below to explore more details on WIN SOURCE:

 [View 102-130 on WIN SOURCE](#)

 [Bivar Inc. Information](#)

Optimize Your Supply Chain with WIN SOURCE Solutions

-  Global Sourcing Solution
-  Obsolete Management
-  Cost Control Management
-  Shortage Management
-  Alternative Solution
-  Excess Inventory Management