

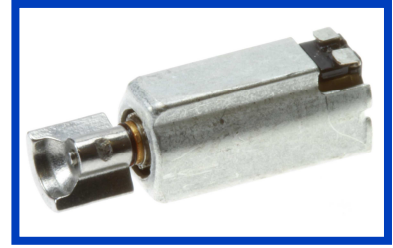

THE DATASHEET OF KHN4NX1RC



KHN4NX (Reflow) Haptics



Outline UNIT:mm

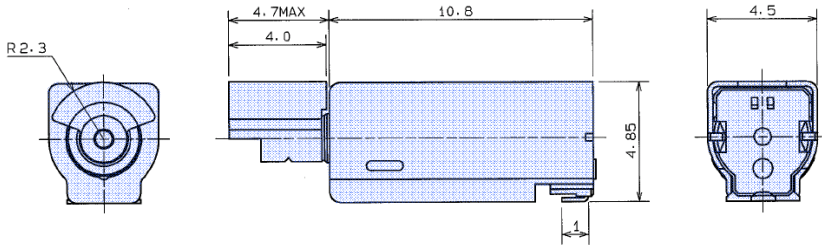

Specifications

Model	Operating Voltage (V)	Rated Voltage (V)	Rated Speed (min ⁻¹)	Rated Current (mA)	Starting Voltage (V)	Starting Current (mA)	Vibration (N)	Weight (g)	Volume (mm ³)
KHN4NX1RC	1.1 to 1.5	1.3	9500	52	0.5	74	0.48	0.55	125

Characteristics

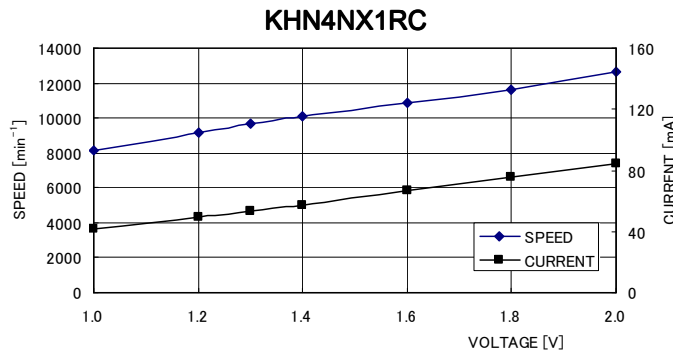

Improvement of Haptics function

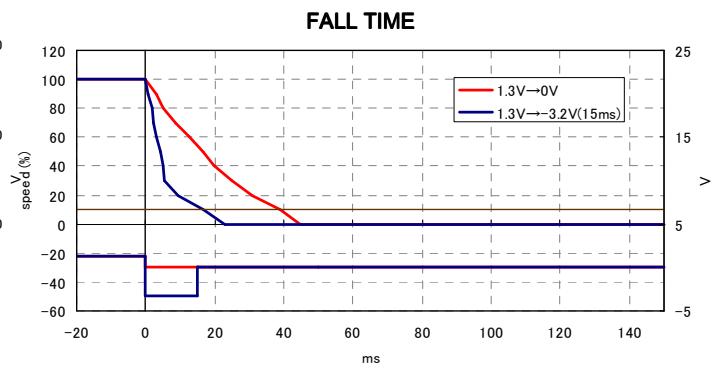
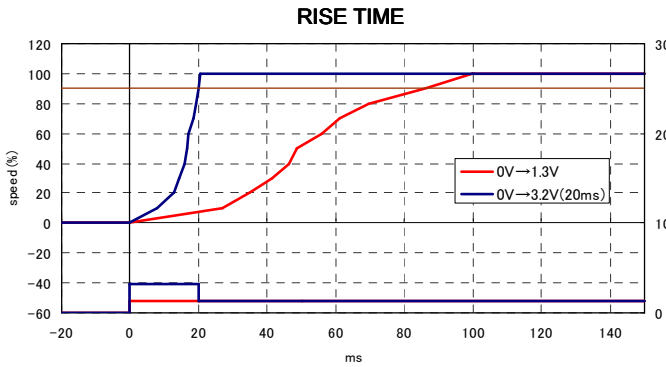

1. To reduce rise time, motor can be applied at 3.2V(20msec). 2. To reduce fall time, motor can be applied at -3.2V(15msec).

※please do not applied at 3.2V more than 30msec.

※please do not applied at -3.2V more than 30msec.

Looking for pricing, stock, or lifecycle information?

Click below to explore more details on WIN SOURCE:

-  [View KHN4NX1RC on WIN SOURCE](#)
-  [NMB Technologies Corporation Information](#)

Optimize Your Supply Chain with WIN SOURCE Solutions

-  Global Sourcing Solution
-  Obsolete Management
-  Cost Control Management
-  Shortage Management
-  Alternative Solution
-  Excess Inventory Management