



**THE DATASHEET OF
51761-10002406AALF**



PRODUCT NUMBER
51761 - A00CCDDEF -- NOTE 1
SEE NOTE 1

Tous droits strictement reserves. Reproduction ou communication a des tiers interdite sous quelque forme que ce soit sans autorisation ecrite du proprietaire. Propriete de c FCI. Droits de reproduction FCI.



All rights strictly reserved. Reproduction or issue to third parties in any form whatever is not permitted without written authority from the proprietor. Property of FCI. Copyright FCI.

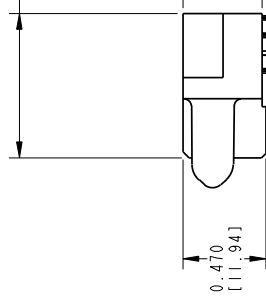
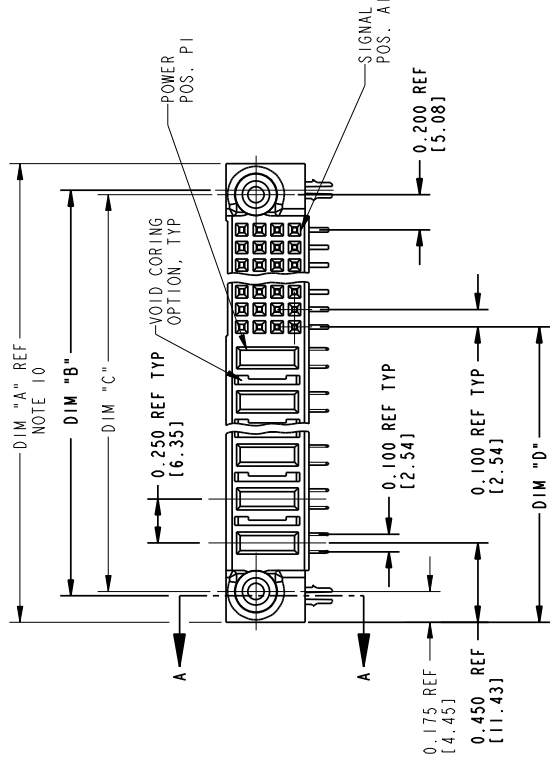
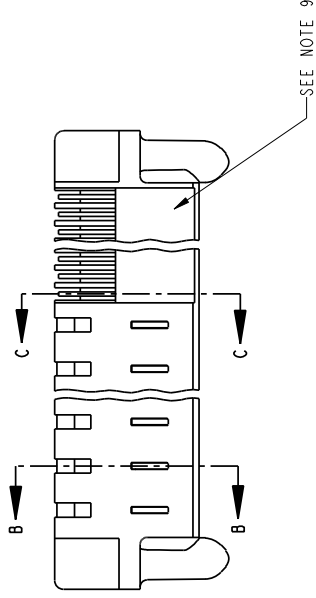

mat'l code		SEE NOTE 2		tolerances unless otherwise specified		CUSTOMER COPY
lir	ecn no.	dr	date	linear	angles	projection
K	0007-0039	RYAN	02/12/07	.XX±.01/.XX±.3	0°±2°	1st ANGLE
L	0007-0061	JULIA	02/14/07	.XXX±.005/.XX±.13		
M	0008-0239	JC	09/11/08	.XXXX±.0020/.XXX±.051		
N	0009-0126	JR	04/23/09		DIBOLE	INCH / MM
P	0611-0074	RZ	03/14/11		J. BROWN	Scale
					J. BROWN	1 : 1
sheet index	revision	P	P	oppd		
	sheet	1	2	3		

THIS FILE WAS ORIGINALLY CREATED IN THE PRO ENGINEER ENVIRONMENT AND ANY FUTURE REVISIONS TO THIS FILE MUST BE MADE IN THE PRO ENGINEER ENVIRONMENT

form no. 7530-001-103

Tous droits strictement reserves. Reproduction ou communication a des tiers interdite sous quelque forme que ce soit sans autorisation ecrite du proprietaire. Propriete de c FCI. Droits de reproduction FCI.



All rights strictly reserved. Reproduction or issue to third parties in any form whatever is not permitted without written authority from the proprietor. Property of FCI. Copyright FCI.

PRODUCT NUMBER 51761-A00CCDDDEF-- NOTE 1	DIM	LENGTH FORMULAS (SEE NOTE 1)
SEE NOTE 1	DIM "A"	.250 [6.35] x DD + .100 [2.54] x (CCC/4) + .650 [16.51] (NOTE 10)
	DIM "B"	.250 [6.35] x DD + .100 [2.54] x (CCC/4) + .350 [8.89]
	DIM "C"	.250 [6.35] x DD + .100 [2.54] x (CCC/4) + .300 [7.62]
	DIM "D"	.250 [6.35] x DD + .375 [9.53] Δ
	DIM "E"	.250 [6.35] x DD + .100 [2.54] x (CCC/4) + .680 [17.27]
	DIM "G"	.250 [6.35] x DD + .225 [5.72]

CONNECTOR NOTES

1) PRODUCT NUMBER CODE:

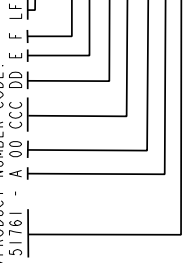

NO THIS SUFFIX: 100u"/2.54um SnPb ON PCB INTERFACE
ADD THIS SUFFIX: 78u"/2.00um Sn ON PCB INTERFACE
RETAINTION TO PCB (NOTE 8)
TAIL OPTIONS (NOTE 7)
NUMBER OF LEFT END POWER CONTACTS (NOTE 6)
NUMBER OF SIGNAL CONTACTS (NOTE 5)
ALWAYS '00' (ZERO, ZERO) (NOTE 4)
PLATING (NOTE 3)
BASE NUMBER

2) HOUSING MATERIAL: GLASS FILLED V-O HIGH TEMP THERMO PLASTIC.
SIGNAL CONTACT MATERIAL: COPPER ALLOY
POWER CONTACT MATERIAL: COPPER ALLOY

3) PLATING OPTION:
SEE PRINT 10064183 FOR PLATING SPEC OF 51761-100CCDDDEF; 51761-100CCDDDEF L

4) THIS PART IS NOT AVAILABLE WITH RIGHT SIDE POWER CONTACTS.

5) SIGNAL CONTACTS, 004 TO 148 AVAILABLE FOR SOLDER TO BOARD.
012 TO 148 AVAILABLE FOR PRESS FIT TO BOARD.

6) LEFT END POWER CONTACTS, 01 TO 20 AVAILABLE.
MAXIMUM OF 20 POWER CONTACTS PER CONNECTOR

7) TAIL OPTIONS:
A = .135 ± .010 [3.43 ± 0.25] SOLDER TO BOARD
B = .090 ± .005 / -.010 [2.29 ± 0.13 / -0.25]
SOLDER TO BOARD)
C = .154 ± .010 [3.91 ± 0.25] PRESS FIT TO BOARD

- 8) RETENTION TO PCB OPTICALLY
A = BOARD LOCK (REQUIREMENT)
MOUNTING FOOT HEIGHT
[2.49 +0.05/-0.03]
[2.2015,59]
B = .150 [3.81] THRU
[4.01 ± 0.08] THRU
MOUNTING FOOT HEIGHT
[1.6014,06]
9) MANUFACTURE'S NAME, P.A. TO APPEAR ON THIS SURFACE
10. THE MAXIMUM OVERALL LENGTH IS 8.00 [203.2]
11. PRODUCT SPECIFICATION
12. APPLICATION SPECIFICATION
13. FOR PRESS FIT CONNECTOR TO APPLY CONNECTOR

PCB NOTES:

14. ALL DIMENSIONS ARE BASED ON TRUE POSITION OF .0041
15. ALL THROUGH HOLES ARE TRUE POSITION OF .0041
16. ALL HOLE DIAMETERS ARE 0.0003 [0.007] MIN SIZE
17. Ø 0.0453 +/- .001 [1.15 ± 0.025] MIN SIZE
18. A Δ SYMBOL WILL BE NEAR NOTE WHICH HAS BEEN MADE DRAWING REVISION.

mat'l code		tolerances unless otherwise specified		CUSTOMER COPY	
lir	ecn no.	dr	date	linear	projection
P				.XX±.01/.X±.3 .XXX±.005/.XX±.13 .XXXX±.0020/.XXX±.051	
		angles		0° ± 2°	
		dr		D/BROG	INCH / MM
		engr		J. BROWN	Scale
		chr		J. BROWN	1 : 1
		appd		J. BROWN	
		revision			
		sheet			
		index			

THIS FILE WAS ORIGINALLY CREATED IN THE PRO ENGINEER ENVIRONMENT AND ANY FUTURE REVISIONS TO THIS FILE MUST BE MADE IN THE PRO ENGINEER ENVIRONMENT

form no. 7530-001-103

PDM: Rev:F

PRODUCT NUMBER

51761 - A00CCDDDEF --
NOTE ①

1 | 2 | | | | | | | | | | 3 |

Tous droits strictement reserves. Reproduction ou communication a des tiers interdite sous quelque forme que ce soit sans autorisation ecrite du proprietaire. Propriete de c FCI. Droits de reproduction FCI.

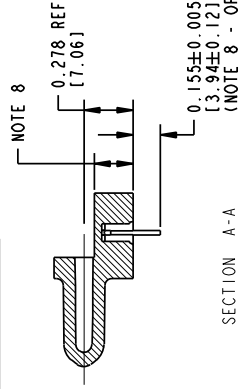

SECTION A-A

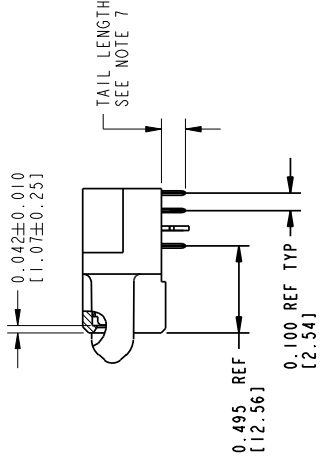

SECTION B-B

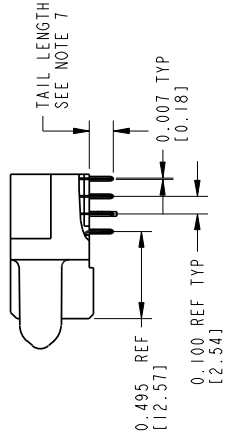

SECTION C-C

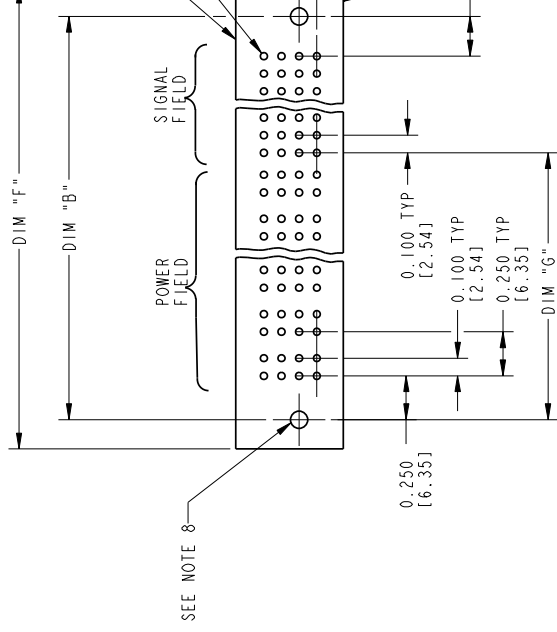

RECOMMENDED PCB LAYOUT

mat'l code		tolerances unless otherwise specified		CUSTOMER COPY	
lir	ecm no.	date	linear	.XX±.01/.X±.3	projection
P			angles	.XXX±.005/.XX±.13	
			dr	.XXXX±.0020/.XXX±.051	INCH / MM
			engr	0°±2°	
			chr	DIBBLE 05-18-99	SCALE
			appd	J. BROWN 05-18-99	
			revision sheet	J. BROWN 05-18-99	1 : 1
sheet index					

form no. 7530-001-103

1 | 2

3 |



All rights strictly reserved. Reproduction or issue to third parties in any form whatever is not permitted without written authority from the propriete. Property of FCI. Copyright FCI.

PDM: Rev.F

Looking for pricing, stock, or lifecycle information?

Click below to explore more details on WIN SOURCE:

- [View 51761-10002406AALF on WIN SOURCE](#)
- [Amphenol FCI Information](#)

Optimize Your Supply Chain with WIN SOURCE Solutions

- ✓ Global Sourcing Solution
- ✓ Obsolete Management
- ✓ Cost Control Management
- ✓ Shortage Management
- ✓ Alternative Solution
- ✓ Excess Inventory Management