



**THE DATASHEET OF  
89047-102LF**



1	2	POB	LOADING CONFIGURATION
1.6	2.90	1.6	FULLY LOADED
2.4	2.90	2.4	FULLY LOADED
1.6	2.90	1.6	FULLY LOADED
2.4	3.53	2.4	FULLY LOADED

PLATING CONTACT AREA:	
DASH NR:	PERFORMANCE LEVEL
-1YY/1YYL	TELCORDIA CO
-2YY/2YYL	CUSTOMER SPECIAL
-3Y/3YYL	CUSTOMER SPECIAL

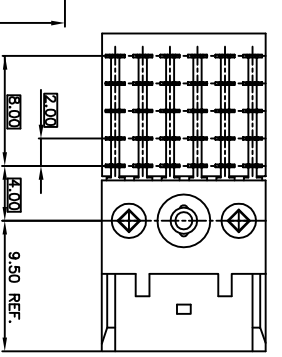
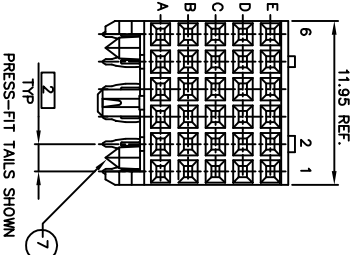
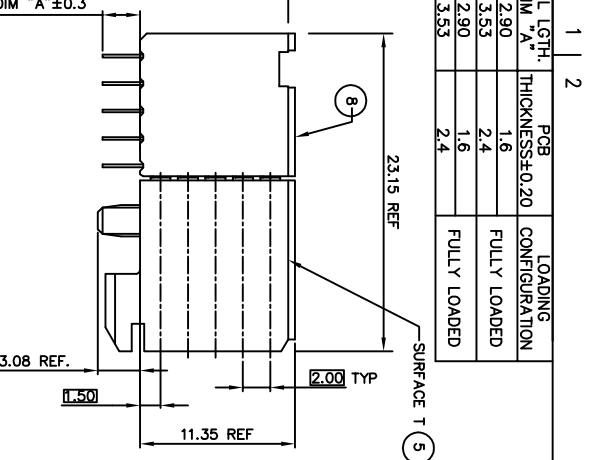

NOTES:

- CONNECTOR MATERIALS:  
HOUSING: LCP, 30% GLASS FILLED, UL 94-V0 COMPLIANT  
PRESS BLOCK: GLASS FILLED, HIGH TEMPERATURE RESIN UL 94-V0 COMPLIANT  
TERMINAL: PHOSPHOR BRONZE ALLOY
- TAIL PLATING:  
89047-XYLF = 0.5-1.5µm Sn Pb  
89047-XYLF = 0.5-1.5µm Sn (LEAD FREE)  
GS-12-002
- PRODUCT SPECIFICATION:  
GS-12-002
- APPLICATION SPECIFICATIONS:  
BUS-20-061  
TA-941
- PRODUCT MARKING: (PART NUMBER & LOT CODE).
- INDICATED HOLES ARE UNPLATED.
- DIAMOND LOCATION PEG ARE ONLY EXISTED ON THE BOTH SIDES OF PRODUCT.
- TOP SURFACE OF PRESS BLOCK MAY EXTEND UP TO 0.4MM HIGHER THAN HOUSING. THIS MAY AFFECT THE TAIL LENGTH BEFORE APPLICATION TO A BOARD.
- THESE PRODUCTS WHERE THE PART NUMBER ENDS IN "LF" MEET THE EUROPEAN UNION DIRECTIVES AND OTHER COUNTRY REGULATIONS AS DESCRIBED IN GS-22-008.
- ALL PRODUCTS WILL WITHSTAND EXPOSURE TO 240°C FOR 60 SECONDS IN A CONVECTION, INFRARED OR VAPOR PHASE REFLOW OVEN.  
10. FOR LEAD FREE PART NUMBERS ADD "LF" SUFFIX. EXAMPLE: 89047-XYLF.

TABLE 1  
PLATED THRU HOLE REQUIREMENTS

HOLE DIAMETER AFTER PLATING	0.65- 0.80
DRILLED HOLE	0.81-0.86 (0.85 DRILL)
COPPER PLATING	0.025 - 0.05
SN/Pb PLATING	0.005-0.015

mat'l. code	NOTE 1	tolerances unless otherwise specified	CUSTOMER COPY	FCI	title	product family	code
lt	ecn no.	df	ddte	llnear	0.XXX±0.13	METRAL	213
S	D608-0445	Cenh	10/30/08	llnear	0.XXX±.051		
T	D607-0171	Cenh	05/25/07	onlges	0±.2°		
U	D608-0171	TER	7/7/08				
V	D609-0068	Cenh	06/06/09	dr			
W	D611-0061	Cenh	2011/03/03	engr			
R	V05-0874	DAI	09/13/05	ppd			
sheet index	revision	W					
1	2						

## Looking for pricing, stock, or lifecycle information?

Click below to explore more details on WIN SOURCE:

- [View 89047-102LF on WIN SOURCE](#)
- [Amphenol FCI Information](#)

## Optimize Your Supply Chain with WIN SOURCE Solutions

- ✓ Global Sourcing Solution
- ✓ Obsolete Management
- ✓ Cost Control Management
- ✓ Shortage Management
- ✓ Alternative Solution
- ✓ Excess Inventory Management