



**THE DATASHEET OF  
BD677G**



# BD675G, BD675AG, BD677G, BD677AG, BD679G, BD679AG, BD681G

## Plastic Medium-Power Silicon NPN Darlington

This series of plastic, medium-power silicon NPN Darlington transistors can be used as output devices in complementary general-purpose amplifier applications.

### Features

- High DC Current Gain
- Monolithic Construction
- Complementary to BD676, 676A, 678, 678A, 680, 680A, 682
- BD677, 677A, 679, 679A are Equivalent to MJE 800, 801, 802, 803
- These Devices are Pb-Free and are RoHS Compliant\*

### MAXIMUM RATINGS

| Rating   | Symbol         | Value                 | Unit                     |
|--|----------------|-----------------------|--------------------------|
| Collector-Emitter Voltage<br>BD675G, BD675AG<br>BD677G, BD677AG<br>BD679G, BD679AG<br>BD681G | $V_{CEO}$      | 45<br>60<br>80<br>100 | Vdc                      |
| Collector-Base Voltage<br>BD675G, BD675AG<br>BD677G, BD677AG<br>BD679G, BD679AG<br>BD681G    | $V_{CBO}$      | 45<br>60<br>80<br>100 | Vdc                      |
| Emitter-Base Voltage   | $V_{EBO}$      | 5.0                   | Vdc                      |
| Collector Current  | $I_C$          | 4.0                   | Adc                      |
| Base Current   | $I_B$          | 1.0                   | Adc                      |
| Total Device Dissipation<br>@ $T_C = 25^\circ\text{C}$<br>Derate above $25^\circ\text{C}$    | $P_D$          | 40<br>0.32            | W<br>W/ $^\circ\text{C}$ |
| Operating and Storage Junction<br>Temperature Range  | $T_J, T_{stg}$ | -55 to +150           | $^\circ\text{C}$         |

Stresses exceeding those listed in the Maximum Ratings table may damage the device. If any of these limits are exceeded, device functionality should not be assumed, damage may occur and reliability may be affected.

### THERMAL CHARACTERISTICS

| Characteristic                       | Symbol          | Max  | Unit                      |
|--------------------------------------|-----------------|------|---------------------------|
| Thermal Resistance, Junction-to-Case | $R_{\theta JC}$ | 3.13 | $^\circ\text{C}/\text{W}$ |



ON Semiconductor®

<http://onsemi.com>

**4.0 AMPERES  
POWER TRANSISTORS  
NPN SILICON  
60, 80, 100 VOLTS, 40 WATTS**

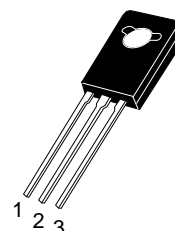
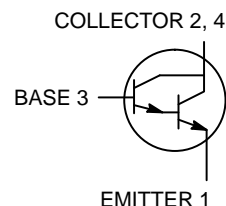

TO-225  
CASE 77-09  
STYLE 1

### MARKING DIAGRAMS

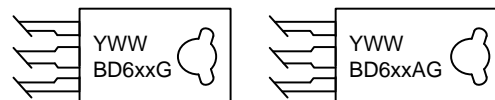

BD6xx/BD6xxA = Device Code  
x = 75, 77, 79, 81  
Y = Year  
WW = Work Week  
G = Pb-Free Package

### ORDERING INFORMATION

See detailed ordering and shipping information in the package dimensions section on page 4 of this data sheet.

\*For additional information on our Pb-Free strategy and soldering details, please download the ON Semiconductor Soldering and Mounting Techniques Reference Manual, SOLDERRM/D.

# BD675G, BD675AG, BD677G, BD677AG, BD679G, BD679AG, BD681G

## ELECTRICAL CHARACTERISTICS ( $T_C = 25^\circ\text{C}$ unless otherwise noted)

| Characteristic   | Symbol     | Min                   | Max        | Unit            |
|--|------------|-----------------------|------------|-----------------|
| <b>OFF CHARACTERISTICS</b>   |            |                       |            |                 |
| Collector-Emitter Breakdown Voltage, (Note 1)<br>( $I_C = 50\text{ mAdc}$ , $I_B = 0$ )<br>BD675G, BD675AG<br>BD677G, BD677AG<br>BD679G, BD679AG<br>BD681G     | $BV_{CEO}$ | 45<br>60<br>80<br>100 | -          | Vdc             |
| Collector Cutoff Current<br>( $V_{CE} = \text{Half Rated } BV_{CEO}$ , $I_B = 0$ )   | $I_{CEO}$  | -                     | 500        | $\mu\text{Adc}$ |
| Collector Cutoff Current<br>( $V_{CB} = \text{Rated } BV_{CEO}$ , $I_E = 0$ )<br>( $V_{CB} = \text{Rated } BV_{CEO}$ , $I_E = 0$ , $T_C = 100^\circ\text{C}$ ) | $I_{CBO}$  | -                     | 0.2<br>2.0 | mAdc            |
| Emitter Cutoff Current<br>( $V_{BE} = 5.0\text{ Vdc}$ , $I_C = 0$ )  | $I_{EBO}$  | -                     | 2.0        | mAdc            |

## ON CHARACTERISTICS

|   |               |            |            |     |
|---|---------------|------------|------------|-----|
| DC Current Gain, (Note 1)<br>( $I_C = 1.5\text{ Adc}$ , $V_{CE} = 3.0\text{ Vdc}$ )<br>BD675G, BD677G, BD679G, BD681G<br>( $I_C = 2.0\text{ Adc}$ , $V_{CE} = 3.0\text{ Vdc}$ )<br>BD675AG, BD677AG, BD679AG        | $h_{FE}$      | 750<br>750 | -          | -   |
| Collector-Emitter Saturation Voltage, (Note 1)<br>( $I_C = 1.5\text{ Adc}$ , $I_B = 30\text{ mAdc}$ )<br>BD677G, BD679G, BD681G<br>( $I_C = 2.0\text{ Adc}$ , $I_B = 40\text{ mAdc}$ )<br>BD675AG, BD677AG, BD679AG | $V_{CE(sat)}$ | -          | 2.5<br>2.8 | Vdc |
| Base-Emitter On Voltage, (Note 1)<br>( $I_C = 1.5\text{ Adc}$ , $V_{CE} = 3.0\text{ Vdc}$ )<br>BD677G, BD679G, BD681G<br>( $I_C = 2.0\text{ Adc}$ , $V_{CE} = 3.0\text{ Vdc}$ )<br>BD675AG, BD677AG, BD679AG        | $V_{BE(on)}$  | -          | 2.5<br>2.5 | Vdc |

## DYNAMIC CHARACTERISTICS

|  |          |     |   |   |
|--|----------|-----|---|---|
| Small Signal Current Gain<br>( $I_C = 1.5\text{ Adc}$ , $V_{CE} = 3.0\text{ Vdc}$ , $f = 1.0\text{ MHz}$ ) | $h_{fe}$ | 1.0 | - | - |
|--|----------|-----|---|---|

Product parametric performance is indicated in the Electrical Characteristics for the listed test conditions, unless otherwise noted. Product performance may not be indicated by the Electrical Characteristics if operated under different conditions.

1. Pulse Test: Pulse Width  $\leq 300\ \mu\text{s}$ , Duty Cycle  $\leq 2.0\%$ .

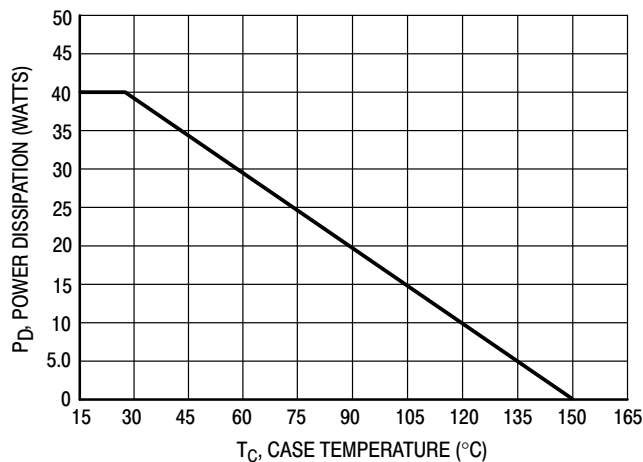

Figure 1. Power Temperature Derating

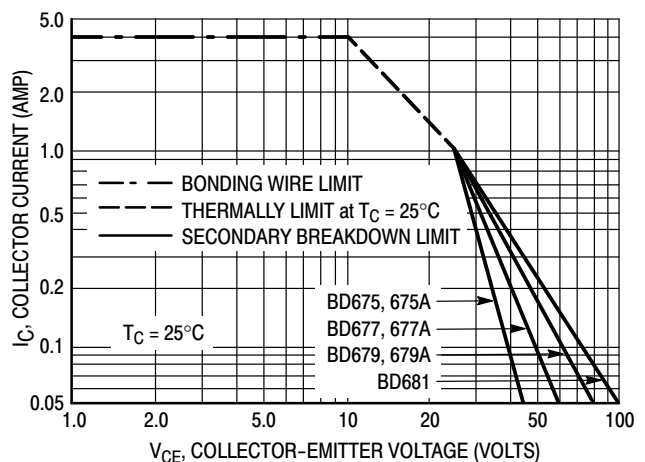

Figure 2. DC Safe Operating Area

## BD675G, BD675AG, BD677G, BD677AG, BD679G, BD679AG, BD681G

There are two limitations on the power handling ability of a transistor average junction temperature and secondary breakdown. Safe operating area curves indicate  $I_C - V_{CE}$  limits of the transistor that must be observed for reliable operation; e.g., the transistor must not be subjected to greater dissipation than the curves indicate.

At high case temperatures, thermal limitations will reduce the power that can be handled to values less than the limitations imposed by secondary breakdown.

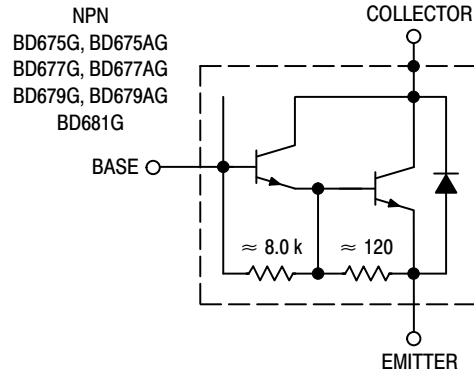

Figure 3. Darlington Circuit Schematic

### ORDERING INFORMATION

| Device  | Package             | Shipping        |
|---------|---------------------|-----------------|
| BD675G  | TO-225<br>(Pb-Free) | 500 Units / Box |
| BD675AG | TO-225<br>(Pb-Free) | 500 Units / Box |
| BD677G  | TO-225<br>(Pb-Free) | 500 Units / Box |
| BD677AG | TO-225<br>(Pb-Free) | 500 Units / Box |
| BD679G  | TO-225<br>(Pb-Free) | 500 Units / Box |
| BD679AG | TO-225<br>(Pb-Free) | 500 Units / Box |
| BD681G  | TO-225<br>(Pb-Free) | 500 Units / Box |

# BD675G, BD675AG, BD677G, BD677AG, BD679G, BD679AG, BD681G

## PACKAGE DIMENSIONS

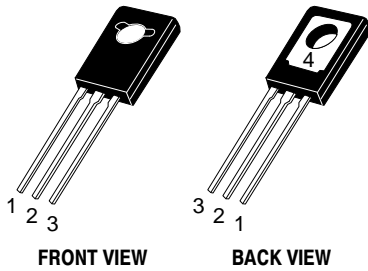

TO-225  
CASE 77-09  
ISSUE AC

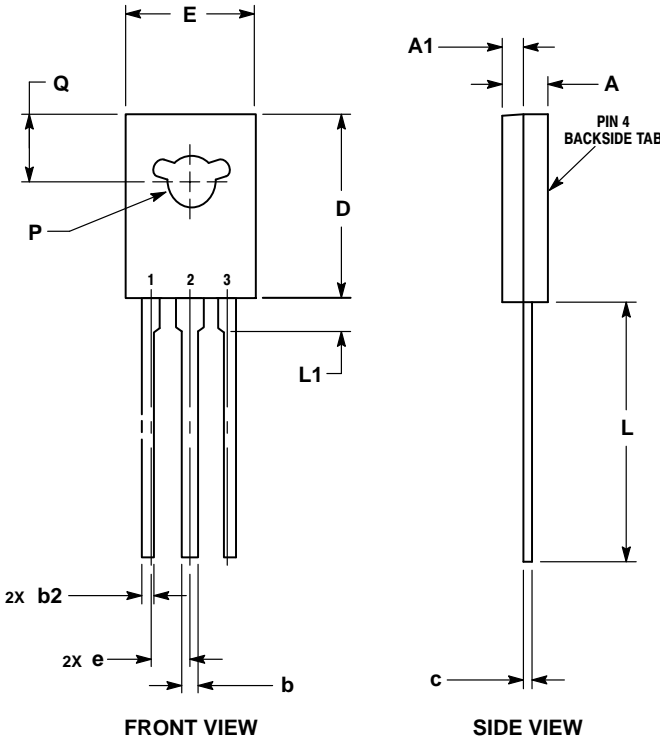

NOTES:

1. DIMENSIONING AND TOLERANCING PER ASME Y14.5M, 1994.
2. CONTROLLING DIMENSION: MILLIMETERS.
3. NUMBER AND SHAPE OF LUGS OPTIONAL.

| DIM | MILLIMETERS |       |
|-----|-------------|-------|
|     | MIN         | MAX   |
| A   | 2.40        | 3.00  |
| A1  | 1.00        | 1.50  |
| b   | 0.60        | 0.90  |
| b2  | 0.51        | 0.88  |
| c   | 0.39        | 0.63  |
| D   | 10.60       | 11.10 |
| E   | 7.40        | 7.80  |
| e   | 2.04        | 2.54  |
| L   | 14.50       | 16.63 |
| L1  | 1.27        | 2.54  |
| P   | 2.90        | 3.30  |
| Q   | 3.80        | 4.20  |

STYLE 1:

- PIN 1. EMITTER
- 2., 4. COLLECTOR
- 3. BASE

ON Semiconductor and are registered trademarks of Semiconductor Components Industries, LLC (SCILLC). SCILLC owns the rights to a number of patents, trademarks, copyrights, trade secrets, and other intellectual property. A listing of SCILLC's product/patent coverage may be accessed at [www.onsemi.com/site/pdf/Patent-Marking.pdf](http://www.onsemi.com/site/pdf/Patent-Marking.pdf). SCILLC reserves the right to make changes without further notice to any products herein. SCILLC makes no warranty, representation or guarantee regarding the suitability of its products for any particular purpose, nor does SCILLC assume any liability arising out of the application or use of any product or circuit, and specifically disclaims any and all liability, including without limitation special, consequential or incidental damages. "Typical" parameters which may be provided in SCILLC data sheets and/or specifications can and do vary in different applications and actual performance may vary over time. All operating parameters, including "Typicals" must be validated for each customer application by customer's technical experts. SCILLC does not convey any license under its patent rights nor the rights of others. SCILLC products are not designed, intended, or authorized for use as components in systems intended for surgical implant into the body, or other applications intended to support or sustain life, or for any other application in which the failure of the SCILLC product could create a situation where personal injury or death may occur. Should Buyer purchase or use SCILLC products for any such unintended or unauthorized application, Buyer shall indemnify and hold SCILLC and its officers, employees, subsidiaries, affiliates, and distributors harmless against all claims, costs, damages, and expenses, and reasonable attorney fees arising out of, directly or indirectly, any claim of personal injury or death associated with such unintended or unauthorized use, even if such claim alleges that SCILLC was negligent regarding the design or manufacture of the part. SCILLC is an Equal Opportunity/Affirmative Action Employer. This literature is subject to all applicable copyright laws and is not for resale in any manner.

### PUBLICATION ORDERING INFORMATION

**LITERATURE FULFILLMENT:**

Literature Distribution Center for ON Semiconductor  
P.O. Box 5163, Denver, Colorado 80217 USA  
Phone: 303-675-2175 or 800-344-3860 Toll Free USA/Canada  
Fax: 303-675-2176 or 800-344-3867 Toll Free USA/Canada  
Email: [orderlit@onsemi.com](mailto:orderlit@onsemi.com)

**N. American Technical Support:** 800-282-9855 Toll Free  
USA/Canada  
**Europe, Middle East and Africa Technical Support:**  
Phone: 421 33 790 2910  
**Japan Customer Focus Center**  
Phone: 81-3-5817-1050



**ON Semiconductor Website:** [www.onsemi.com](http://www.onsemi.com)

**Order Literature:** <http://www.onsemi.com/orderlit>

For additional information, please contact your local Sales Representative

## Looking for pricing, stock, or lifecycle information?

Click below to explore more details on WIN SOURCE:

-  [View BD677G on WIN SOURCE](#)
-  [ON Semiconductor Information](#)

## Optimize Your Supply Chain with WIN SOURCE Solutions

-  Global Sourcing Solution
-  Obsolete Management
-  Cost Control Management
-  Shortage Management
-  Alternative Solution
-  Excess Inventory Management