



**THE DATASHEET OF  
MSS1P2L-E3/89A**





# Surface Mount Schottky Barrier Rectifiers

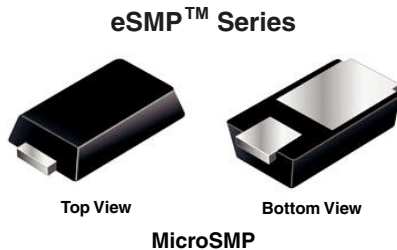

### FEATURES

- Very low profile - typical height of 0.68 mm
- Ideal for automated placement
- Low forward voltage drop, low power losses
- High efficiency
- Meets MSL level 1, per J-STD-020, LF maximum peak of 260 °C
- Component in accordance to RoHS 2002/95/EC and WEEE 2002/96/EC
- Halogen-free



PRIMARY CHARACTERISTICS	
$I_{F(AV)}$	1.0 A
$V_{RRM}$	20 V, 30 V
$I_{FSM}$	25 A
$V_F$ at $I_F = 1.0$ A	0.35 V
$T_J$ max.	150 °C

### TYPICAL APPLICATIONS

For use in low voltage high frequency inverters, freewheeling, dc-to-dc converters, and polarity protection applications.

### MECHANICAL DATA

**Case:** MicroSMP

Molding compound meets UL 94V-0 flammability rating.

Base P/N-E3 - RoHS compliant, commercial grade

Base P/N-M3 - halogen-free and RoHS compliant, commercial grade

**Terminals:** Matte tin plated leads, solderable per J-STD-002 and JESD22-B102

E3 and M3 suffix meets JESD 201 class 1A whisker test

**Polarity:** Color band denotes the cathode end

MAXIMUM RATINGS ( $T_A = 25$ °C unless otherwise noted)				
PARAMETER	SYMBOL	MSS1P2L	MSS1P3L	UNIT
Device marking code		12L	13L	
Maximum repetitive peak reverse voltage	$V_{RRM}$	20	30	V
Maximum average forward rectified current (Fig. 1)	$I_{F(AV)}$	1.0		A
Peak forward surge current 8.3 ms single half sine-wave superimposed on rated load	$I_{FSM}$	25		A
Operating junction and storage temperature range	$T_J, T_{STG}$	- 55 to + 150		°C



ELECTRICAL CHARACTERISTICS (T <sub>A</sub> = 25 °C unless otherwise noted)						
PARAMETER	TEST CONDITIONS		SYMBOL	TYP.	MAX.	UNIT
Maximum instantaneous forward voltage <sup>(1)</sup>	I <sub>F</sub> = 0.5 A	T <sub>J</sub> = 25 °C	V <sub>F</sub>	0.39	-	V
	I <sub>F</sub> = 1.0 A			0.44	0.50	
	I <sub>F</sub> = 0.5 A	T <sub>J</sub> = 125 °C		0.28	-	
	I <sub>F</sub> = 1.0 A			0.35	0.40	
Maximum reverse current <sup>(2)</sup>	rated V <sub>R</sub>	T <sub>J</sub> = 25 °C T <sub>J</sub> = 125 °C	I <sub>R</sub>	15 6.0	250 20	μA mA
Typical junction capacitance	4.0 V, 1 MHz		C <sub>J</sub>	65	-	pF

**Notes:**

- (1) Pulse test: 300 μs pulse width, 1 % duty cycle
- (2) Pulse test: Pulse width ≤ 40 ms

THERMAL CHARACTERISTICS (T <sub>A</sub> = 25 °C unless otherwise noted)				
PARAMETER	SYMBOL	MSS1P2L	MSS1P3L	UNIT
Typical thermal resistance <sup>(1)</sup>	R <sub>θJA</sub>	125		°C/W
	R <sub>θJL</sub>	30		
	R <sub>θJC</sub>	40		

**Note:**

- (1) Thermal resistance from junction to ambient and junction to lead mounted on P.C.B. with 6.0 x 6.0 mm copper pad areas. R<sub>θJL</sub> is measured at the terminal of cathode band. R<sub>θJC</sub> is measured at the top center of the body

ORDERING INFORMATION (Example)				
PREFERRED P/N	UNIT WEIGHT (g)	PREFERRED PACKAGE CODE	BASE QUANTITY	DELIVERY MODE
MSS1P3L-E3/89A	0.006	89A	4500	7" diameter plastic tape and reel
MSS1P3L-M3/89A	0.006	89A	4500	7" diameter plastic tape and reel

**RATINGS AND CHARACTERISTICS CURVES**

(T<sub>A</sub> = 25 °C unless otherwise noted)

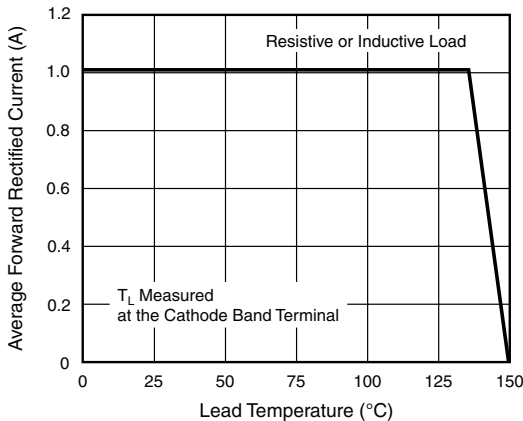

Figure 1. Maximum Forward Current Derating Curve

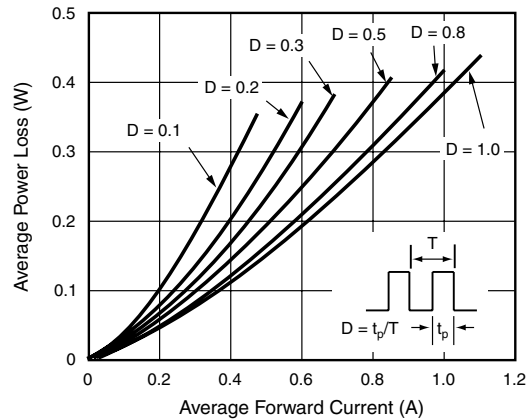

Figure 2. Forward Power Loss Characteristics

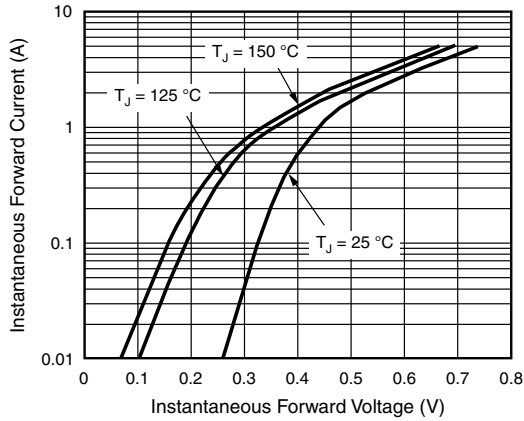

Figure 3. Typical Instantaneous Forward Characteristics

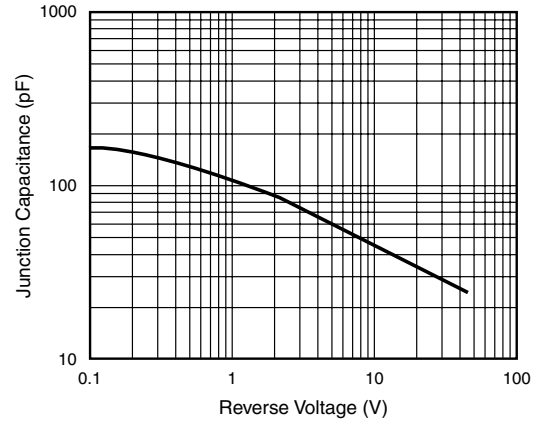

Figure 5. Typical Junction Capacitance

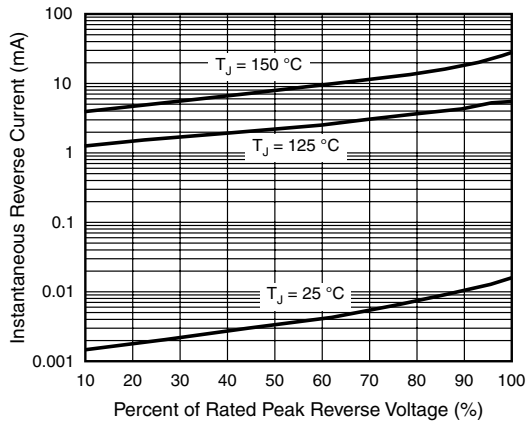

Figure 4. Typical Reverse Characteristics

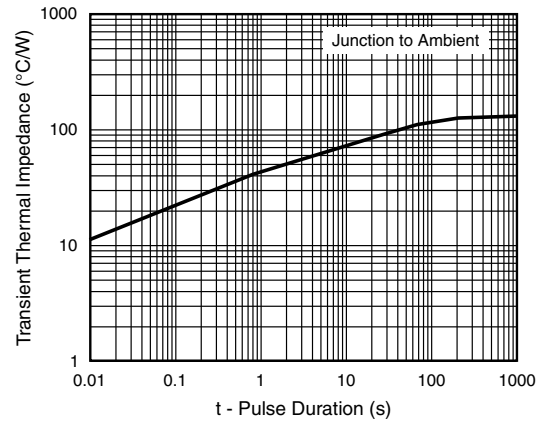
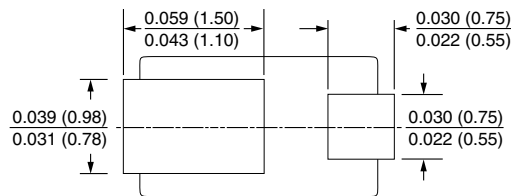
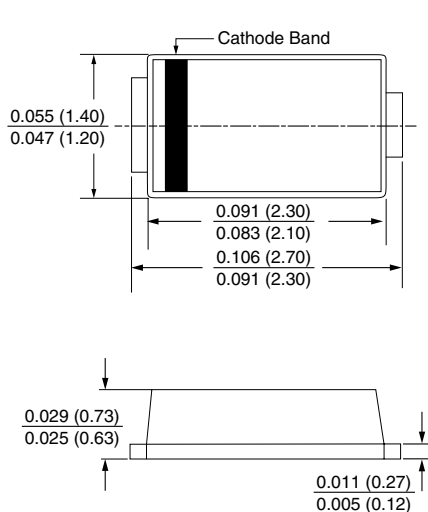

Figure 6. Typical Transient Thermal Impedance

**PACKAGE OUTLINE DIMENSIONS** in inches (millimeters)

**MicroSMP**



**Mounting Pad Layout**

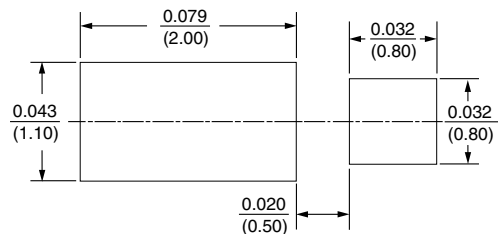



## Disclaimer

All product specifications and data are subject to change without notice.

Vishay Intertechnology, Inc., its affiliates, agents, and employees, and all persons acting on its or their behalf (collectively, "Vishay"), disclaim any and all liability for any errors, inaccuracies or incompleteness contained herein or in any other disclosure relating to any product.

Vishay disclaims any and all liability arising out of the use or application of any product described herein or of any information provided herein to the maximum extent permitted by law. The product specifications do not expand or otherwise modify Vishay's terms and conditions of purchase, including but not limited to the warranty expressed therein, which apply to these products.

No license, express or implied, by estoppel or otherwise, to any intellectual property rights is granted by this document or by any conduct of Vishay.

The products shown herein are not designed for use in medical, life-saving, or life-sustaining applications unless otherwise expressly indicated. Customers using or selling Vishay products not expressly indicated for use in such applications do so entirely at their own risk and agree to fully indemnify Vishay for any damages arising or resulting from such use or sale. Please contact authorized Vishay personnel to obtain written terms and conditions regarding products designed for such applications.

Product names and markings noted herein may be trademarks of their respective owners.

## Looking for pricing, stock, or lifecycle information?

Click below to explore more details on WIN SOURCE:

 [View MSS1P2L-E3/89A on WIN SOURCE](#)

 [Vishay Information](#)

## Optimize Your Supply Chain with WIN SOURCE Solutions

-  Global Sourcing Solution
-  Obsolete Management
-  Cost Control Management
-  Shortage Management
-  Alternative Solution
-  Excess Inventory Management