



# THE DATASHEET OF FIT80-5



### FIT80-5

#### Description:

The FIT80-5 toroidal inductor is specifically designed to minimize transients. It stores energy and therefore, conditions the output signal by leveling the current waveform providing a more stable current supply. Generally used in high frequency circuits, its standard design provides an economical solution in differential mode applications or as an output inductor.

#### Electrical Specifications (@25C):

| Min. Inductance ( $\mu$ H) |         | Rated   | Max               |
|----------------------------|---------|---------|-------------------|
| No Bias                    | At Bias | DC Amps | DCR (m $\Omega$ ) |
| 47.70                      | 22.79   | 8.1     | 22.5              |

**Note:** No Bias inductance measured at .25V, 10KHZ.

#### Dimensions:

| A    | B    | C    | D    | E    | F    | G               |
|------|------|------|------|------|------|-----------------|
| .975 | .625 | 1.10 | .450 | .624 | .125 | .040 $\pm$ .003 |

Units: In inches

**Weight:** .045 lbs.

#### Technical Notes:

1. Nominal inductance values are typically 10% higher than minimal rating.
2. Biased inductance measured at rated DC amps.
3. Operation at rated current yields approximately 40°C temperature rise over 20°C ambient.

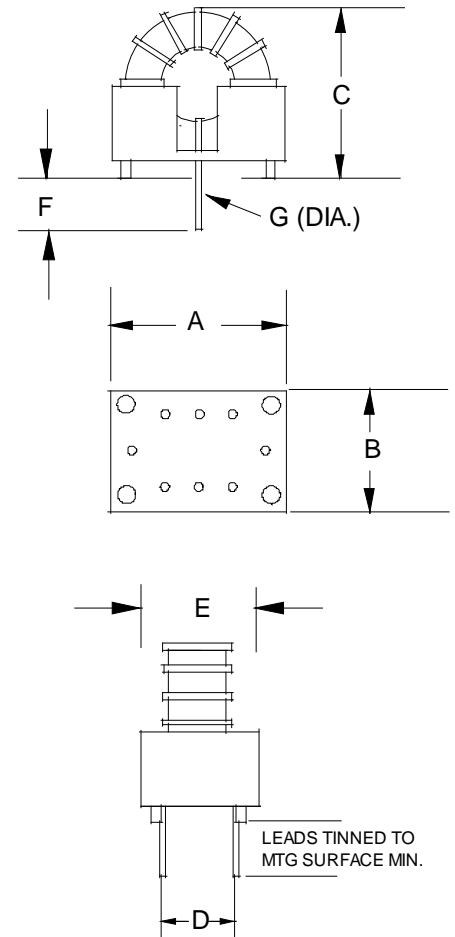

**RoHS Compliance:** As of manufacturing date February 2005, all standard products meet the requirements of 2011/65/EU, known as the RoHS initiative.

\*Upon printing, this document is considered "uncontrolled". Please contact Triad Magnetics website for the most current version. For soldering and washing information please see <http://www.triadmagnetics.com/faq.html>.









## Looking for pricing, stock, or lifecycle information?

Click below to explore more details on WIN SOURCE:

-  [View FIT80-5 on WIN SOURCE](#)
-  [Triad Magnetics Information](#)

## Optimize Your Supply Chain with WIN SOURCE Solutions

-  Global Sourcing Solution
-  Obsolete Management
-  Cost Control Management
-  Shortage Management
-  Alternative Solution
-  Excess Inventory Management