



THE DATASHEET OF AOI472A





TO251A PACKAGE OUTLINE

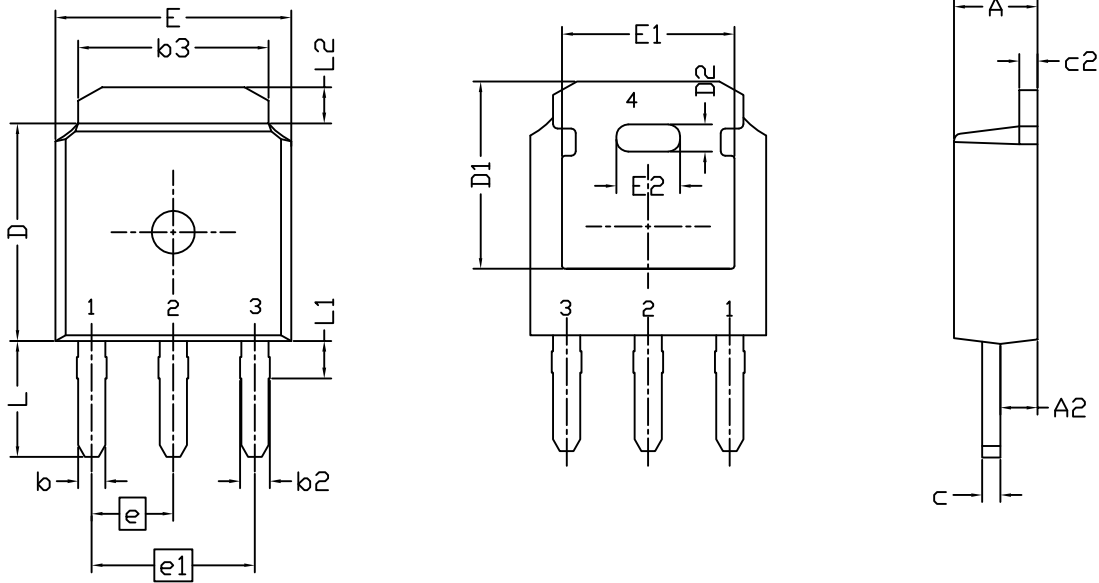

RECOMMENDED LAND PATTERN

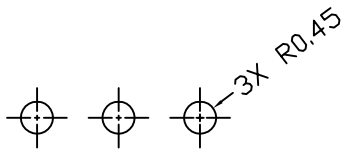

UNIT: mm

SYMBOL	DIMENSION IN MILLIMETERS			DIMENSIONS IN INCHES		
	MIN.	NOM.	MAX.	MIN.	NOM.	MAX.
A	2.18	2.29	2.39	0.086	0.090	0.094
A2	0.89	----	1.14	0.035	----	0.045
b	0.63	0.76	0.85	0.025	0.030	0.033
b2	0.76	----	1.05	0.030	----	0.041
b3	4.95	----	5.46	0.195	----	0.215
c	0.46	0.51	0.61	0.018	0.020	0.024
c2	0.46	----	0.61	0.018	----	0.024
D	5.97	6.10	6.22	0.235	0.240	0.245
D1	5.21	----	----	0.205	----	----
D2	0.508 BSC			0.02 BSC		
E	6.35	6.60	6.73	0.250	0.260	0.265
E1	4.318	----	----	0.170	----	----
E2	1.524 BSC			0.06 BSC		
e	2.29 BSC.			0.090 BSC.		
e1	4.57 BSC.			0.180 BSC.		
L	3.70	4.05	4.40	0.146	0.159	0.173
L1	1.05 REF.			0.041 REF.		
L2	0.89	----	1.27	0.035	----	0.050

NOTE

1. PACKAGE BODY SIZES EXCLUDE MOLD FLASH AND GATE BURRS. MOLD FLASH SHOULD BE LESS THAN 6 MILS.
2. DIMENSION L IS MEASURED IN GAUGE PLANE
3. TOLERANCE 0.10 mm UNLESS OTHERWISE SPECIFIED
4. CONTROLLING DIMENSION IS MILLIMETER. CONVERTED INCH DIMENSIONS ARE NOT NECESSARILY EXACT.
5. REFER TO JEDEC TO-252 (AA)

Looking for pricing, stock, or lifecycle information?

Click below to explore more details on WIN SOURCE:

- ⊖ [View AOI472A on WIN SOURCE](#)
- ⊖ [Alpha & Omega Semiconductor Inc. Information](#)

Optimize Your Supply Chain with WIN SOURCE Solutions

- ✓ Global Sourcing Solution
- ✓ Obsolete Management
- ✓ Cost Control Management
- ✓ Shortage Management
- ✓ Alternative Solution
- ✓ Excess Inventory Management