

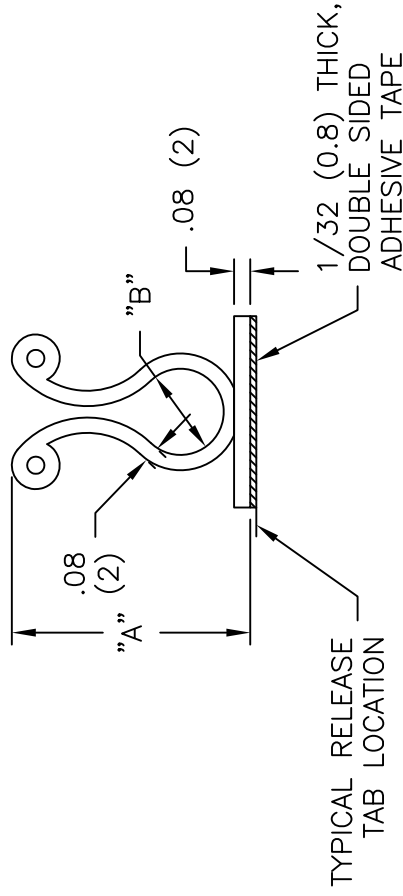

**THE DATASHEET OF
KLB-350A-RT**

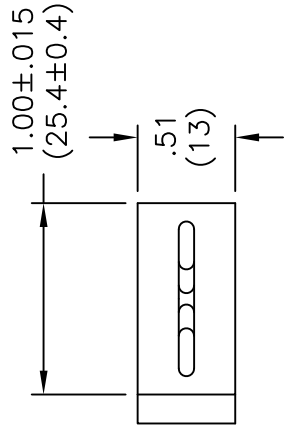

PART NO. W/ADHESIVE	"A" REF.
KLB-350A-RT	1.07 (27.2)
KLB-450A-RT	1.23 (31.2)
KLB-750A-RT	1.58 (40.1)



NOTES:

- MATERIAL: NYLON 6/6 (RMS-01).
FLAME RETARDANT, NYLON (RMS-19),
AVAILABLE BY SPECIAL ORDER ONLY.
- COLOR: NATURAL.
- ACRYLIC ADHESIVE TAPE (RMS-15), WHITE LINER.
RUBBER ADHESIVE TAPE (RMS-102), BLUE LINER,
AVAILABLE BY SPECIAL ORDER ONLY.
TO ORDER USE KLB-XXXA1-RT.
PARTS ALSO AVAILABLE WITHOUT ADHESIVE.
TO ORDER USE PART NO. KLB-XXX-01/KLB-XXX-19

REV		DESCRIPTION		ENGR		DATE	
F	SE CO 200525 FOR CHANGES	SK	04.26.10				
E	SE CO 200118 FOR CHANGES	SK	01.30.08				
D	SEE CO 200112 FOR CHANGES	SK	01.24.08				
C	ADDED RUBBER ADHESIVE BY SPECIAL ORDER	SM	05.17.02				
B	ADDED NOTE 3.	SJ	03.05.02				
A	CHANGED FILE NUMBER	SM	05.31.01				

TOLERANCES UNLESS NOTED .XX=±.010 .XXX=±.005 FRAC=±1/64 ANG=±1°	FILE # KLB	DWN: J.B.	APP:
RE: RICHCO, INC.	MAT'L: SEE NOTES	DT: 01-23-96	DT:
	RE: RICHCO, INC.		RICHCO INC. PO BOX 804238, CHICAGO, 60688 (773) 539-4060

TITLE: KURLY-LOK ON BASE

Looking for pricing, stock, or lifecycle information?

Click below to explore more details on WIN SOURCE:

- ⊖ [View KLB-350A-RT on WIN SOURCE](#)
- ⊖ [Essentra Components](#) Information

Optimize Your Supply Chain with WIN SOURCE Solutions

- ✓ Global Sourcing Solution
- ✓ Obsolete Management
- ✓ Cost Control Management
- ✓ Shortage Management
- ✓ Alternative Solution
- ✓ Excess Inventory Management