



**THE DATASHEET OF
HM2C09D2C021L9LF**



PART NUMBER

HM2C09D_C021L9LF

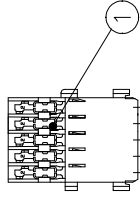
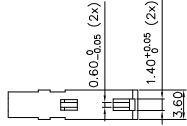
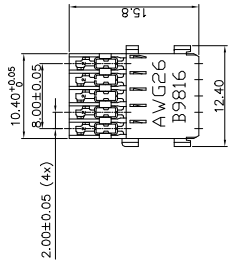
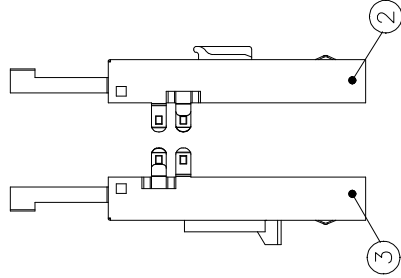
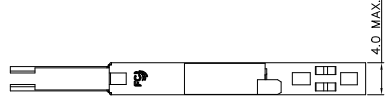
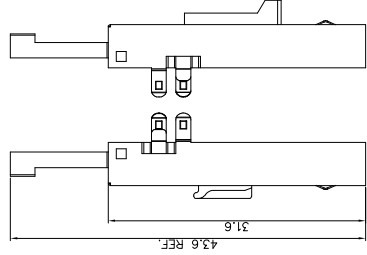
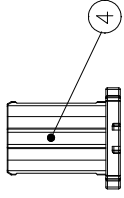
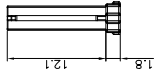
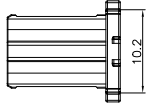
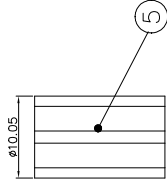
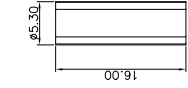
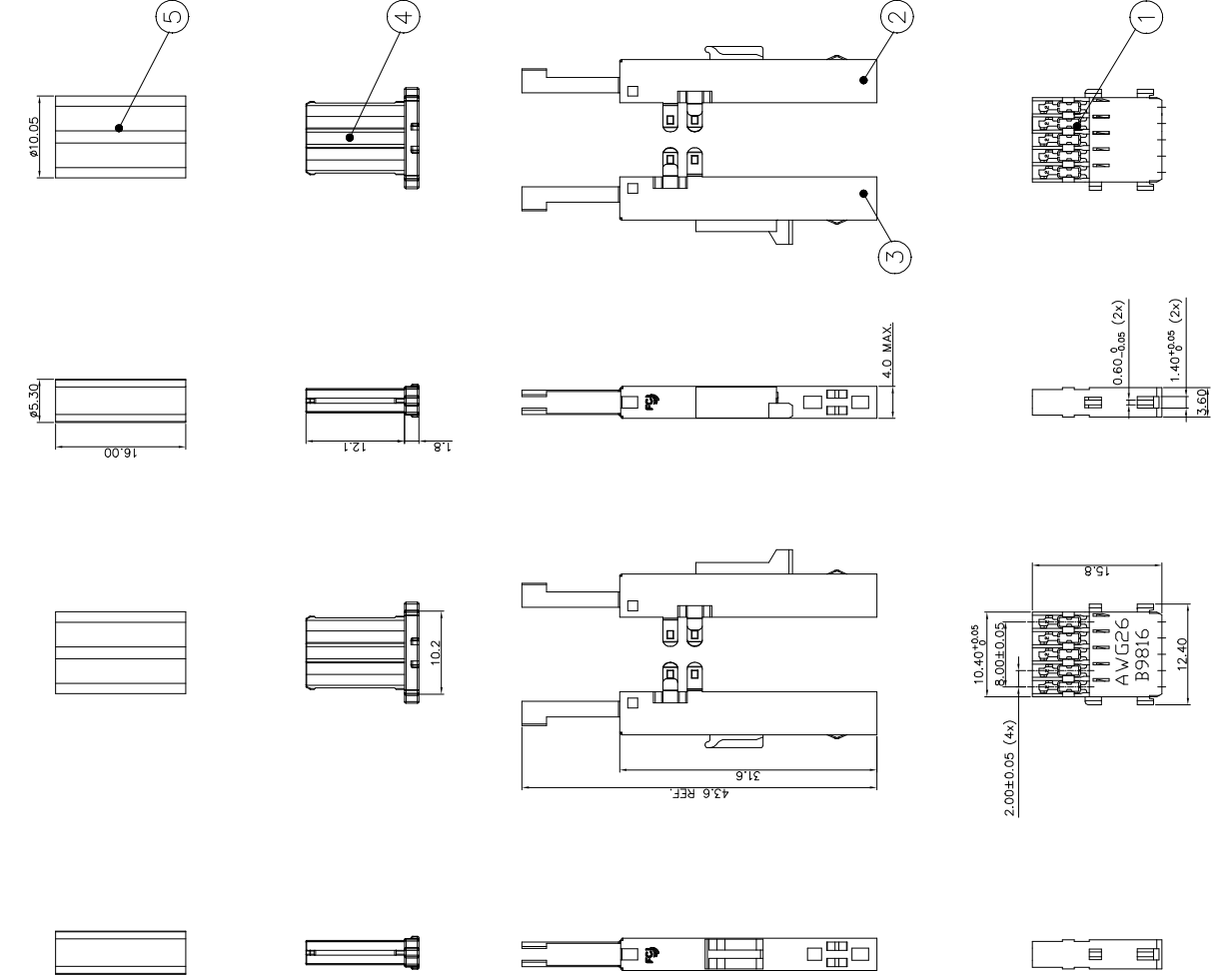

ROW E
ROW D
ROW C
ROW B
ROW A

POS. 1
POS. 2

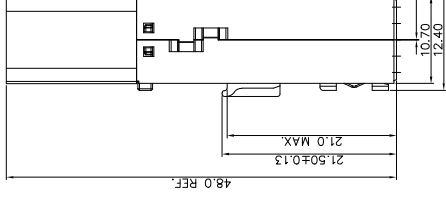

A

PERFORMANCE CHARACTERISTICS:
 VOLTAGE RATING : 250 VAC
 CURRENT RATING : 1.0 A
 INSULATION RESISTANCE : 10⁵ MΩ M
 DIELECTRIC WITHSTANDING VOLTAGE : 20 mV
 CONTACT RESISTANCE : -55°C TO
 OPERATING T° : 0.75 N M
 INSERTION FORCE : 0.15 N
 WITHDRAWAL FORCE : 0.15 N

MATERIALS:
 TERMINAL BLOCK : GLASS REINFORCE
 CONTACTS : PHOSPHOR BRON
 PERFORMANCE : TELCORDIA CO;
 SHIELDING COVER: STAINLESS STEEL
 INNER FERRULE : Sn PLATED E-Cu
 OUTER FERRULE : Sn PLATED E-Cu

5	1	12X5	POS.	SHIELDED	HM2 C
4	1	12X5	POS.	SHIELDED	HM2 I
3	1	12X5	POS.	SHIELDED	HM2 C
2	1	12X5	POS.	SHIELDED	HM2 C
1	1	12X5	POS.	STACKABLE	CAB

||Item||Qty||Description||

Notes:
 1. WHEN PART NUMBER WITH "LF" SUFFIX MEAN
 2. THIS PRODUCT WITH "LF" SUFFIX MEAN
 3. COUNTRY REGULATIONS AS DESCRIBED

itr	ecn no	dr	date	tolerances unless	surface	ISO 1302	ISO
A	-	KN	21/01/2003				
B	DG05-0244	CLU	26/07/2005	angle			
C	DG08-0117	Nickor	18/03/2008	0±2°			
D	ELX-N-004867	A.ZH	03/08/2011	dr	A.Janssens		
E	ELX-N-33153	DAISY	10/04/2019	eng	G.Droesbek		
sheet	revision	chr	appd	G.Droesbek			
index	sheet	1					

B

Looking for pricing, stock, or lifecycle information?

Click below to explore more details on WIN SOURCE:

- ⊖ [View HM2C09D2C021L9LF](#) on WIN SOURCE
- ⊖ [Amphenol FCI](#) Information

Optimize Your Supply Chain with WIN SOURCE Solutions

- ✓ Global Sourcing Solution
- ✓ Obsolete Management
- ✓ Cost Control Management
- ✓ Shortage Management
- ✓ Alternative Solution
- ✓ Excess Inventory Management