

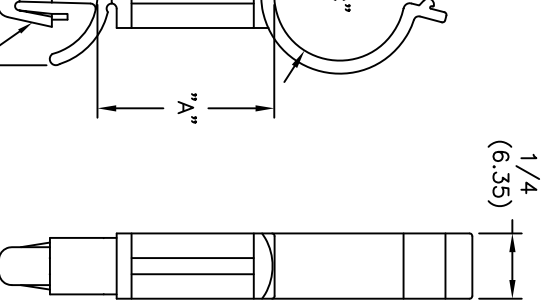

**THE DATASHEET OF
SLCSE-500-3-01**





PART NO.	"B"	MAX. BUNDLE DIA. "C" LOCKED	BOARD THICKNESS RANGE
SLOCSE-250	.57 (14.5)	.22 (5.6)	1/32-5/64 (0.8-2.0)
SLOCSE-370	.71 (18.0)	.35 (8.9)	
SLOCSE-500	.83 (21.0)	.47 (12.0)	5/64-5/32 (2.0-4.0)
SLOCSE-750	1.08 (27.5)	.73 (18.4)	
SLOCSE2250	.57 (14.5)	.22 (5.6)	
SLOCSE2370	.71 (18.0)	.35 (8.9)	
SLOCSE2500	.83 (21.0)	.47 (12.0)	
SLOCSE2750	1.08 (27.5)	.73 (18.4)	

TO SNAP-LOCK IN A
.187 ±.003 (4.75 ±0.08)
DIA. HOLE.
(SEE CHART FOR PANEL THKS.)

PART NO. CODE
SLOCSE - 500 - 8 - 01
PART# SIZE "A" MAT'L

SUFFIX	"A"
-3	3/16(4.8)
-4	1/4(6.4)
-6	3/8(9.5)
-8	1/2(12.7)
-10	5/8(15.9)
-12	3/4(19.1)
-14	7/8(22.2)
-16	1.0(25.4)

/6 UL94 V-2 (RMS-01).
V-0 (RMS-19),
AL ORDER. TO ORDER
H "-19"
/2 (RMS-109),
AL ORDER. TO ORDER
H "-109".

TITLE: STANDOFF LOCK CLIP SERIES		DWG IN IN (MM)		DWG IN IN (MM)		PRINT TYPE	
TOLERANCES UNLESS NOTED ANGS SK 04.30.12 ANGS SK 12.03.09 ANGS SK 01.14.05 ANGS SM 10.01.04 ER SM 05.31.01 ENGR DATE		FILE # SLOCSE	DWN: J.B.	APP:	PART #	FINAL	CA
RE: RICHCO, INC. FRAC=±1/64 ANG=±1°		MAT'L: SEE NOTES	DT: 02-13-96	DT:	SEE CHART		
PO BOX 804238, CHICAGO, IL 60680 (773) 539-4060		RICHCO INC.					

Looking for pricing, stock, or lifecycle information?

Click below to explore more details on WIN SOURCE:

- ⊖ [View SLCSE-500-3-01 on WIN SOURCE](#)
- ⊖ [Essentra Components Information](#)

Optimize Your Supply Chain with WIN SOURCE Solutions

- ✓ Global Sourcing Solution
- ✓ Obsolete Management
- ✓ Cost Control Management
- ✓ Shortage Management
- ✓ Alternative Solution
- ✓ Excess Inventory Management