

FW297

Power MOSFET 60V, 58mΩ, 4.5A, Dual N-Channel



ON Semiconductor®

www.onsemi.com

Features

- Low On-Resistance
- 4.0V Drive
- ESD Diode-Protected Gate
- Pb-Free, Halogen Free and RoHS Compliance

Specifications

Absolute Maximum Ratings at $T_a = 25^\circ\text{C}$

| Parameter | Symbol | Value | Unit |
|--|-----------|-------------|------------------|
| Drain to Source Voltage | V_{DS} | 60 | V |
| Gate to Source Voltage | V_{GS} | ± 20 | V |
| Drain Current (DC) | I_D | 4.5 | A |
| Drain Current (Pulse) $PW \leq 10\mu\text{s}$, duty cycle $\leq 1\%$ | I_{DP} | 18 | A |
| Power Dissipation When mounted on ceramic substrate ($2000\text{mm}^2 \times 0.8\text{mm}$) 1 unit, $PW \leq 10\text{s}$ | P_D | 1.8 | W |
| Total Dissipation When mounted on ceramic substrate ($2000\text{mm}^2 \times 0.8\text{mm}$), $PW \leq 10\text{s}$ | P_T | 2.2 | W |
| Junction Temperature | T_j | 150 | $^\circ\text{C}$ |
| Storage Temperature | T_{stg} | -55 to +150 | $^\circ\text{C}$ |

Thermal Resistance Ratings

| Parameter | Symbol | Value | Unit |
|--|-----------------|-------|--------------------|
| Junction to Ambient 1 unit, $PW \leq 10\text{s}$ * ¹ | $R_{\theta JA}$ | 69.4 | $^\circ\text{C/W}$ |
| Junction to Ambient 2 units, $PW \leq 10\text{s}$ * ¹ | $R_{\theta JA}$ | 56.8 | |

Note: *¹ When mounted on ceramic substrate ($2000\text{mm}^2 \times 0.8\text{mm}$)

Stresses exceeding those listed in the Maximum Ratings table may damage the device. If any of these limits are exceeded, device functionality should not be assumed, damage may occur and reliability may be affected.

| V_{DS} | $R_{DS(on)}$ Max | I_D Max |
|----------|------------------|-----------|
| 60V | 58mΩ@ 10V | 4.5A |
| | 84mΩ@ 4.5V | |
| | 95mΩ@ 4.0V | |

Electrical Connection N-Channel

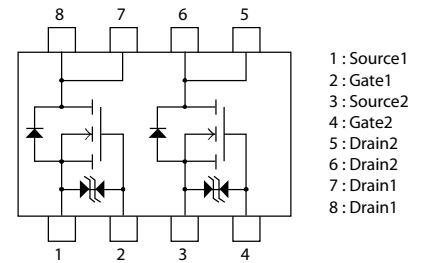

Packing Type : TL

Marking

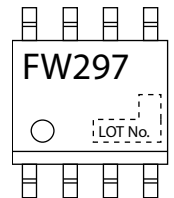
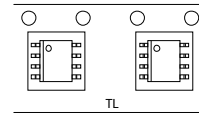

ORDERING INFORMATION

See detailed ordering and shipping information on page 5 of this data sheet.

FW297

Electrical Characteristics at $T_a = 25^\circ\text{C}$

| Parameter | Symbol | Conditions | Value | | | Unit |
|--|---------------|---|-------------------------------------|-----|----------|------------------|
| | | | min | typ | max | |
| Drain to Source Breakdown Voltage | $V_{(BR)DSS}$ | $I_D=1\text{mA}, V_{GS}=0\text{V}$ | 60 | | | V |
| Zero-Gate Voltage Drain Current | I_{DSS} | $V_{DS}=60\text{V}, V_{GS}=0\text{V}$ | | | 1 | μA |
| Gate to Source Leakage Current | I_{GSS} | $V_{GS}=\pm 16\text{V}, V_{DS}=0\text{V}$ | | | ± 10 | μA |
| Gate Threshold Voltage | $V_{GS(th)}$ | $V_{DS}=10\text{V}, I_D=1\text{mA}$ | 1.2 | | 2.6 | V |
| Forward Transconductance | g_{FS} | $V_{DS}=10\text{V}, I_D=4.5\text{A}$ | | 4.7 | | S |
| Static Drain to Source On-State Resistance | $R_{DS(on)1}$ | $I_D=4.5\text{A}, V_{GS}=10\text{V}$ | | 45 | 58 | $\text{m}\Omega$ |
| | $R_{DS(on)2}$ | $I_D=2\text{A}, V_{GS}=4.5\text{V}$ | | 60 | 84 | $\text{m}\Omega$ |
| | $R_{DS(on)3}$ | $I_D=2\text{A}, V_{GS}=4.0\text{V}$ | | 68 | 95 | $\text{m}\Omega$ |
| Input Capacitance | C_{iss} | $V_{DS}=20\text{V}, f=1\text{MHz}$ | | 750 | | pF |
| Output Capacitance | C_{oss} | | | 59 | | pF |
| Reverse Transfer Capacitance | C_{rss} | | | 47 | | pF |
| Turn-ON Delay Time | $t_{d(on)}$ | | | 7 | | ns |
| Rise Time | t_r | See specified Test Circuit | | 16 | | ns |
| Turn-OFF Delay Time | $t_{d(off)}$ | | | 50 | | ns |
| Fall Time | t_f | | | 30 | | ns |
| Total Gate Charge | Q_g | $V_{DS}=30\text{V}, V_{GS}=10\text{V}, I_D=4.5\text{A}$ | | 14 | | nC |
| Gate to Source Charge | Q_{gs} | | | 2.3 | | nC |
| Gate to Drain "Miller" Charge | Q_{gd} | | | 2.8 | | nC |
| Forward Diode Voltage | V_{SD} | | $I_S=4.5\text{A}, V_{GS}=0\text{V}$ | | 0.81 | 1.2 |

Product parametric performance is indicated in the Electrical Characteristics for the listed test conditions, unless otherwise noted. Product performance may not be indicated by the Electrical Characteristics if operated under different conditions.

Switching Time Test Circuit

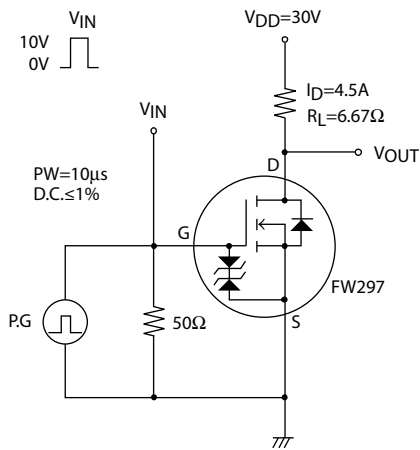

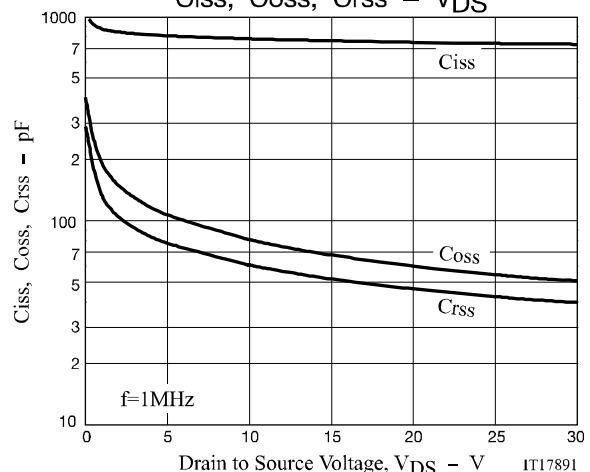
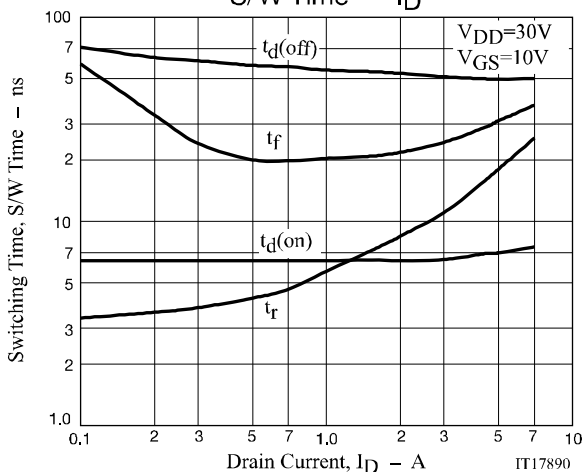
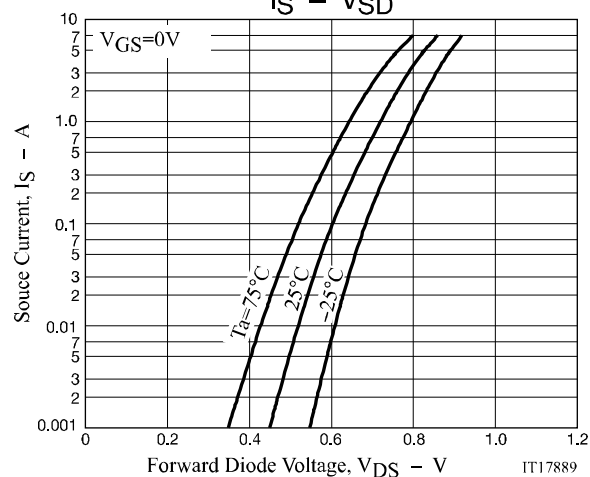
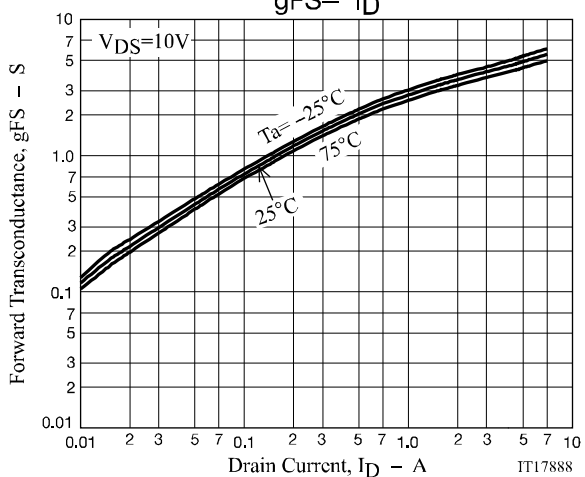
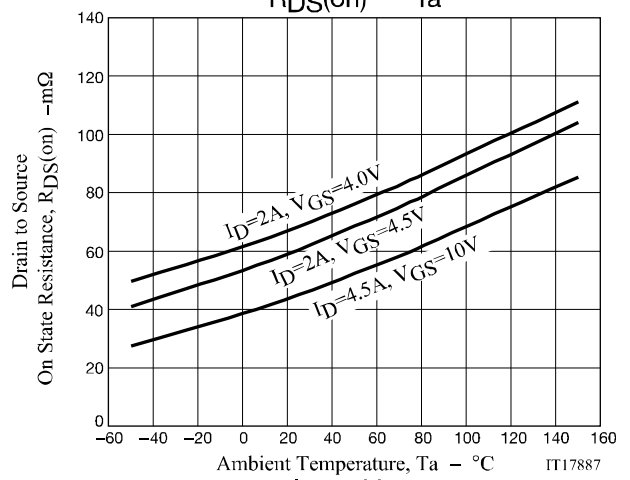
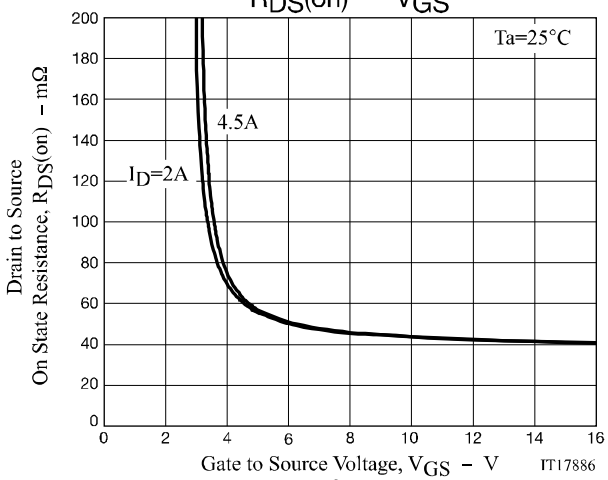
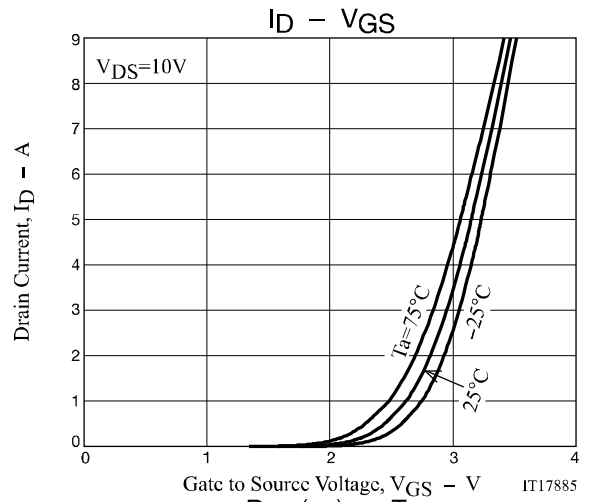
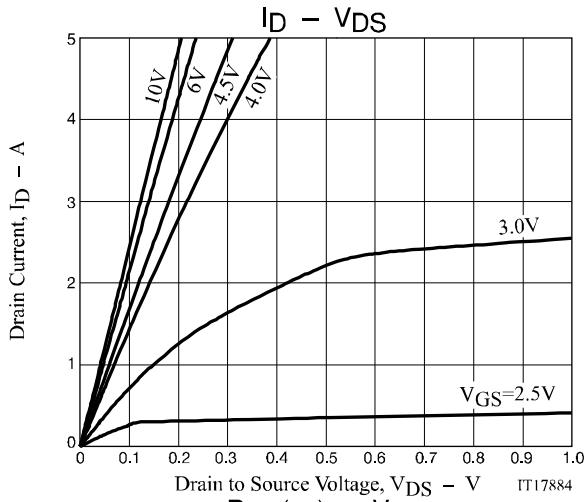

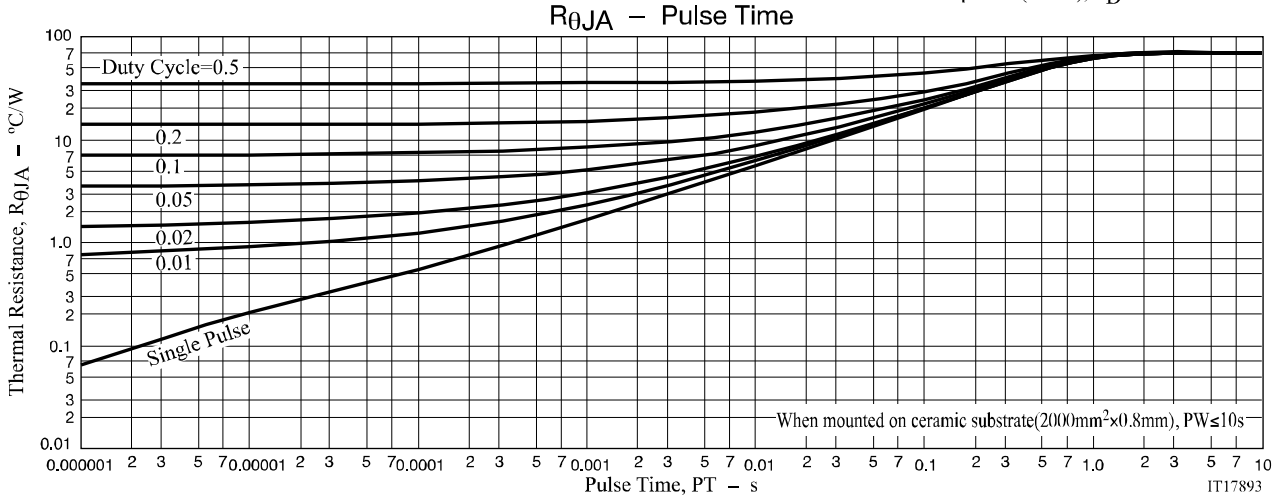
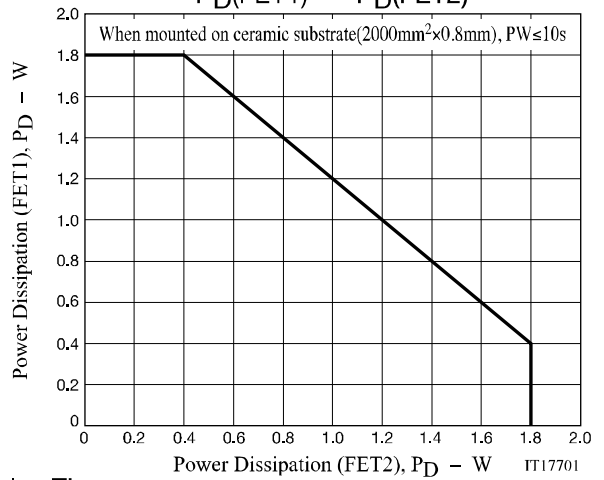
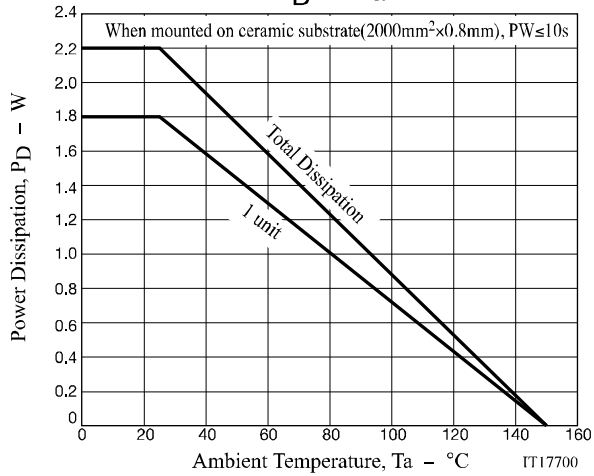
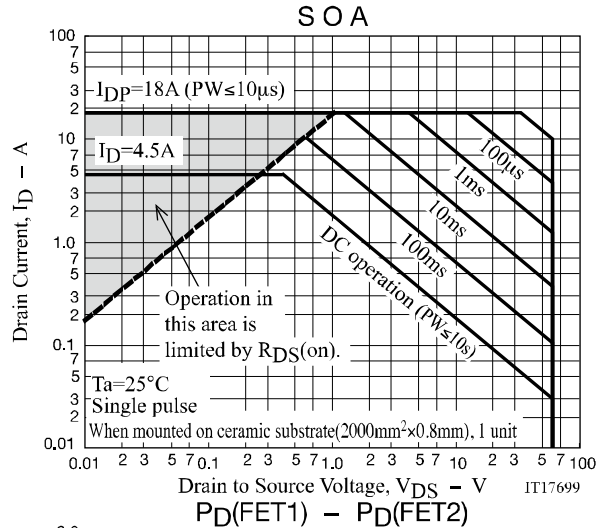
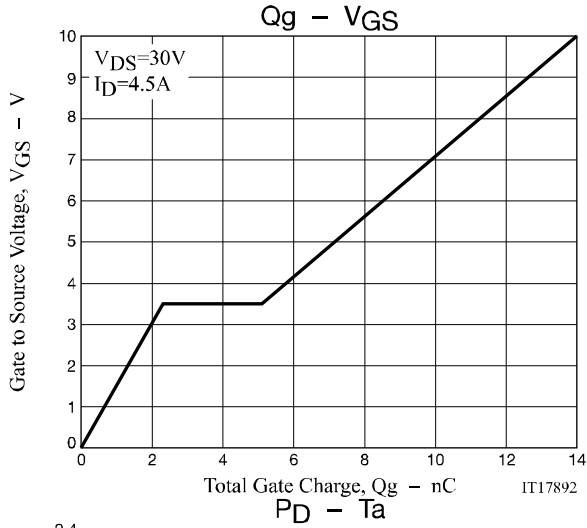

Package Dimensions

FW297-TL-2W

SOIC-8

CASE 751CR

ISSUE O

Unit : mm

- 1: Source1
- 2: Gate1
- 3: Source2
- 4: Gate2
- 5: Drain2
- 6: Drain2
- 7: Drain1
- 8: Drain1

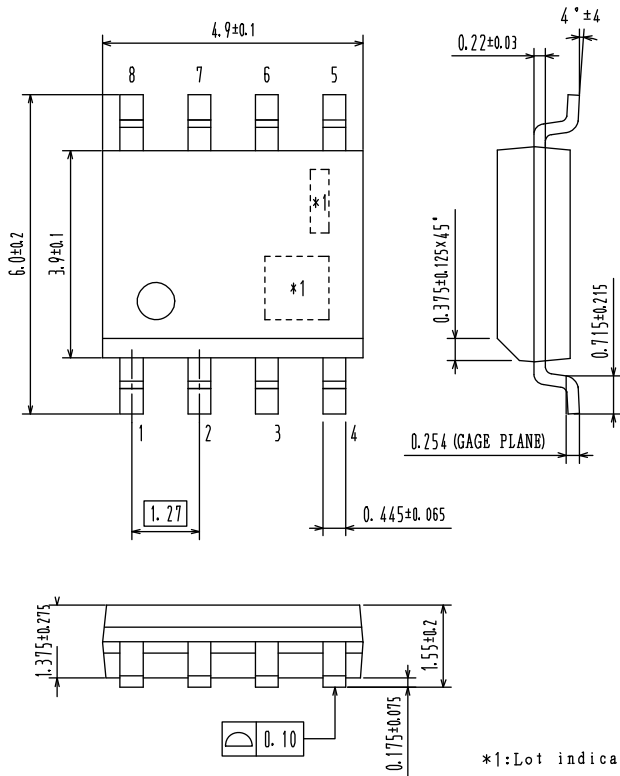

Recommended Soldering Footprint

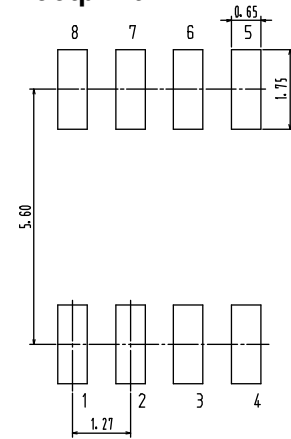

*1: Lot indication

ORDERING INFORMATION

| Device | Package | Shipping | Note |
|-------------|------------------------|--------------------------|--------------------------|
| FW297-TL-2W | SOIC8 SC-87, SOT-96 | 2,500 pcs. / Tape & Reel | Pb-Free and Halogen Free |

† For information on tape and reel specifications, including part orientation and tape sizes, please refer to our Tape and Reel Packaging Specifications Brochure, BRD8011/D. http://www.onsemi.com/pub_link/Collateral/BRD8011-D.PDF

Note on usage : Since the FW297 is a MOSFET product, please avoid using this device in the vicinity of highly charged objects.

ON Semiconductor and the ON logo are registered trademarks of Semiconductor Components Industries, LLC (SCILLC) or its subsidiaries in the United States and/or other countries. SCILLC owns the rights to a number of patents, trademarks, copyrights, trade secrets, and other intellectual property. A listing of SCILLC's product/patent coverage may be accessed at www.onsemi.com/site/pdf/Patent-Marking.pdf. SCILLC reserves the right to make changes without further notice to any products herein. SCILLC makes no warranty, representation or guarantee regarding the suitability of its products for any particular purpose, nor does SCILLC assume any liability arising out of the application or use of any product or circuit, and specifically disclaims any and all liability, including without limitation special, consequential or incidental damages. "Typical" parameters which may be provided in SCILLC data sheets and/or specifications can and do vary in different applications and actual performance may vary over time. All operating parameters, including "Typicals" must be validated for each customer application by customer's technical experts. SCILLC does not convey any license under its patent rights nor the rights of others. SCILLC products are not designed, intended, or authorized for use as components in systems intended for surgical implant into the body, or other applications intended to support or sustain life, or for any other application in which the failure of the SCILLC product could create a situation where personal injury or death may occur. Should Buyer purchase or use SCILLC products for any such unintended or unauthorized application, Buyer shall indemnify and hold SCILLC and its officers, employees, subsidiaries, affiliates, and distributors harmless against all claims, costs, damages, and expenses, and reasonable attorney fees arising out of, directly or indirectly, any claim of personal injury or death associated with such unintended or unauthorized use, even if such claim alleges that SCILLC was negligent regarding the design or manufacture of the part. SCILLC is an Equal Opportunity/Affirmative Action Employer. This literature is subject to all applicable copyright laws and is not for resale in any manner.

Looking for pricing, stock, or lifecycle information?

Click below to explore more details on WIN SOURCE:

- ⊖ [View FW297-TL-2W on WIN SOURCE](#)
- ⊖ [ON Semiconductor](#) Information

Optimize Your Supply Chain with WIN SOURCE Solutions

- ✓ Global Sourcing Solution
- ✓ Obsolete Management
- ✓ Cost Control Management
- ✓ Shortage Management
- ✓ Alternative Solution
- ✓ Excess Inventory Management