



**THE DATASHEET OF
CLS62NP-220NC**



Type: CLS62
◆ Product Description

- 7.3×7.1mm Max.(L×W), 2.5mm Max. Height.
- Inductance Range: 10 μ H~39mH, Rated current range: 37mA~700mA
- In addition to the typical versions of parameters shown here, custom designs are available to meet your exact requirements.

◆ Feature

- Magnetically shielded construction.
- Ideally used in power supply of DSC, DVC, Note PC .
- RoHS Compliance

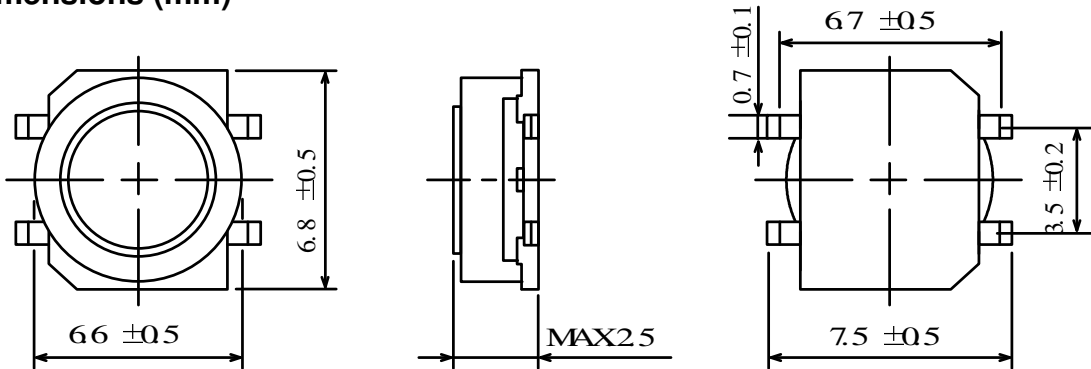
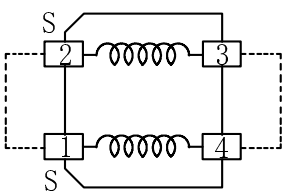
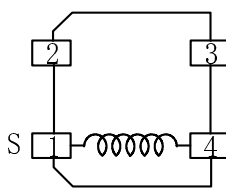

◆ Dimensions (mm)

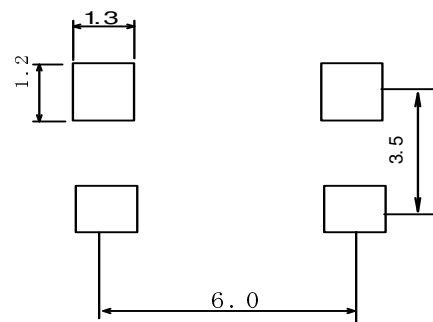
◆ Schematics (Bottom)

 $10 \mu \text{ H} \sim 22 \mu \text{ H}$
 $270 \mu \text{ H} \sim 390 \mu \text{ H}$

 $27 \mu \text{ H} \sim 220 \mu \text{ H}$
 $470 \mu \text{ H} \sim 3.9\text{mH}$

“ S ” indicates winding start.

◆ Land Pattern (mm)

Looking for pricing, stock, or lifecycle information?

Click below to explore more details on WIN SOURCE:

-  [View CLS62NP-220NC on WIN SOURCE](#)
-  [Sumida America Components Inc. Information](#)

Optimize Your Supply Chain with WIN SOURCE Solutions

-  Global Sourcing Solution
-  Obsolete Management
-  Cost Control Management
-  Shortage Management
-  Alternative Solution
-  Excess Inventory Management