

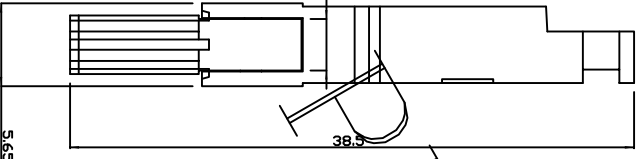

**THE DATASHEET OF  
HM2C06D2C010N9LF**

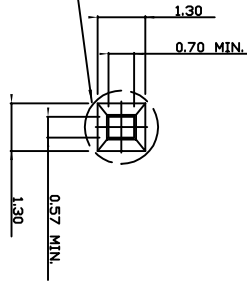

05 06 07 08 09 10 11 12 13 14 15 16 17 18 19 20 21 22 23 24 25 26 27 28 29 30



MAX. CABLE Ø 2.5 MM MAX.

WIRE SIZE MARKING

DATE CODE

REV.	DATE	DESCRIPTION	BY	CHK'D
1	20-12-12	INITIAL DIMENSION EXISTING	ML	
2	22-12-16	REVISION	CL	

**PERFORMANCE CHARACTERISTICS:**

- VOLTAGE RATING : 250 VAC.
- CURRENT RATING : 10 A AT 70°C.
- INSULATION RESISTANCE : 10<sup>9</sup> MO MIN.AFTER TEST.
- DIELECTRIC WITHSTANDING VOLTAGE : 1000 V.
- CONTACT RESISTANCE : 20 mΩ MAX. AFTER TEST.
- OPERATING T° : -55°C TO +125°C.
- INSERTION FORCE : 0.75 N MAX. PER CONTACT.
- WITHDRAWAL FORCE : 0.15 N MIN. PER CONTACT.

**MATERIALS:**

- TERMINAL BLOCK : GLASS REINFORCED THERMOPLASTIC UL94-V0.
- COVER : POLYAMIDE-NYLON.
- CONTACTS : PHOSPHOR BRONZE.
- PLATING : Z1 : 0.40 μ AU MIN. OVER NI IN CONTACT AREA)  
PURE SN ON IDC-TERMINAL.
- N9 : 0.75 μ AU MIN. OVER NI IN CONTACT AREA)  
PURE SN ON IDC-TERMINAL.
- EB : 2.00 μ AU MIN. OVER NI IN CONTACT AREA)  
PURE SN ON IDC-TERMINAL.

**WIRE CHARACTERISTICS:**

INSULATION DIAMETER 1.20 MM MAX.

**PART NUMBERS:**

- HM2C06D0C010--LF CONNECTOR FOR WIRE SIZE AVG28,AVG30
- HM2C06D2C010--LF CONNECTOR FOR WIRE SIZE AVG26

**MARKING:**

PARTNUMBER	WIRE SIZE MARKING
HM2C06D0C010--LF	AVG28/30
HM2C06D2C010--LF	AVG26

**NOTE:**

1. THIS PRODUCT MEETS EUROPEAN UNION DIRECTIVES IN AND OTHER COUNTRY REGULATIONS AS DESCRIBED IN GS-22-008.
2. THE PRODUCT IS NOT INTENDED TO BE EXPOSED TO A MANUFACTURING SOLDER PROCESS.

APPR.	DATE	1-ML	2X5 PIS. HM2 CABLE CONNECTOR WITH HOOD
1DEC	40.2	1DEC	
2DEC	40.1	2DEC	
DRAWN BY: RYAN/RYAN			
CHECKED BY: [Signature]			
PREPARED BY: [Signature]			
PRINTEG BY: [Signature]			
SCALE: 4/1			
FCI			
A FCI HECHTEL N.V. A SPONSORING & 28M KEDELN			
EPM 191-KD-S02-08-C			
BS D 202064.002 B			
P (R) (E) (C) (F) (I) (S) (A) (C) (E) (S) (I) (O) (N)			

RELEASED



THIS IS A U.S. GOVERNMENT WORK. IT IS NOT TO BE REPRODUCED, STORED, REPRODUCED, TRANSMITTED, OR DISTRIBUTED IN ANY MANNER WITHOUT THE WRITTEN PERMISSION OF THE GOVERNMENT.

PDM Release

STATUS Released

## Looking for pricing, stock, or lifecycle information?

Click below to explore more details on WIN SOURCE:

-  [View HM2C06D2C010N9LF on WIN SOURCE](#)
-  [Amphenol FCI Information](#)

## Optimize Your Supply Chain with WIN SOURCE Solutions

-  Global Sourcing Solution
-  Obsolete Management
-  Cost Control Management
-  Shortage Management
-  Alternative Solution
-  Excess Inventory Management