

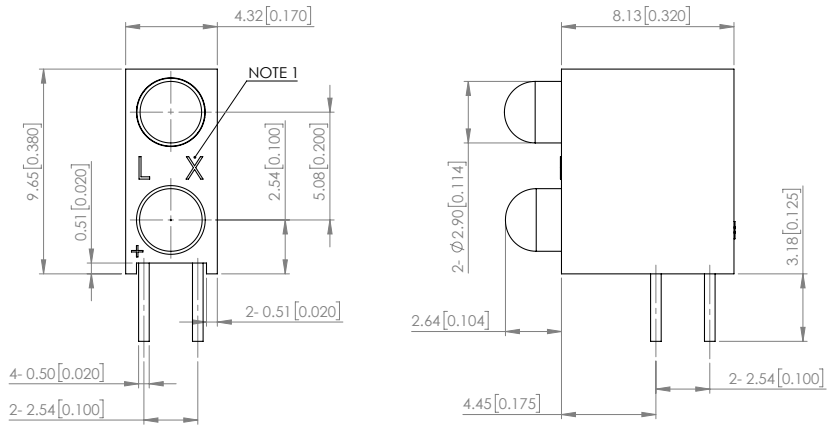

**THE DATASHEET OF
SSF-LXH240GGD**





PART NUMBER		SSF-LXH240GGD	REV	I
REV	E.C.N. NUMBER AND REVISION COMMENTS		DATE	
A	CHG'D LEAD LENGTHS.		8.9.93	
B	CHG'D LEAD LENGTHS.		8.27.93	
C	CHG'D HOLDER BOTTOM & SAFE OP. SPECS.		8.19.94	
D	UPDATED SPECS.		11.29.94	
E	CHG'D STAND-OFF TO 4 FOOD CONSTR.		1.9.95	
F	E.C.N. #10100		10.9.95	
G	E.C.N. #10104		2.6.96	
H	E.C.N. #10BRDR. & REDRAWN.		3.5.01	
I	ECN-Lumex201700040		8.1.17	

ELECTRO-OPTICAL CHARACTERISTIC TA=25°C

PARAMETER	MIN	TYP	MAX	UNITS	TEST COND
PEAK WAELENGHT	-	565	-	nm	If=20mA
FORWARD VOLTAGE	-	2.2	2.6	Vf	If=20mA
REVERSE VOLTAGE	-	-	5	Vr	Ir=100uA
LUMINOUS INTENSITY	-	40	-	mcd	If=20mA
VIEWING ANGLE	-	60	-	2x theta/2	-
EMITTED COLOR	GREEN				
EPOXY LENS FINISH	GREEN DIFFUSED				

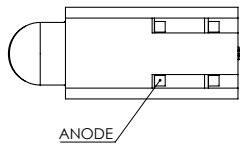
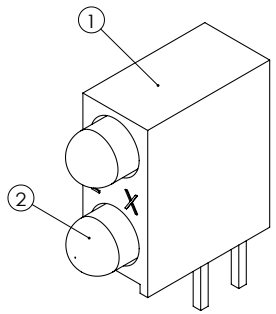

NOTE:
1."L X" OR "LUMEX"

ABSOLUTE MAXIMUM RATINGS TA=25°C

PARAMETER	MAX	UNITS
PEAK FORWARD CURRENT*	150	mA
FORWARD CURRENT	25	mA
POWER DISIPATION	105	mW
STORAGE TEMPERATURE	-40 TO +85	°C
OPERATING TEMPERATURE	-40 TO +85	°C
SOLDERING TEMP.	3 SEC. MAX @ 260	°C

* t<10us
** 2.00mm FROM BODY

ITEM NO.	PARTS	QTY.	DESCRIPTION
1	SSH-LXH240 HOLDER	1	BLACK NYLON 94V-0
2	SSL-LX3044GD LED	2	-

LUMEX
Creating LED and LCD Solutions Together™
425 N. GARY AVE.
CAROL STREAM, IL 60188
PHONE : 800-278-5666
FAX : 830-315-2150
WEB : WWW.LUMEX.COM

9.65(L)*4.32(W)*10.77(H)mm, T-3mm RIGHT ANGLE FAULT INDICATOR LED, DUAL 565nm GREEN LEDS, GREEN DIFFUSED.
THE SPECIFICATIONS MAY CHANGE AT ANY TIME WITHOUT NOTICE DUE TO NEW MATERIALS OR PRODUCT IMPROVEMENT.
CONFIDENTIAL INFORMATION
THE INFORMATION CONTAINED IN THIS DOCUMENT IS THE PROPERTY OF LUMEX INC. EXCEPT AS SPECIFICALLY AUTHORIZED IN WRITING BY LUMEX INC., THE HOLDER OF THIS DOCUMENT SHALL KEEP ALL INFORMATION CONTAINED HEREIN CONFIDENTIAL AND SHALL PROTECT SAME IN WHOLE OR IN PART FROM DISCLOSURE AND DISSEMINATION TO ALL THIRD PARTIES.

DATE : 2017.08.01 DRAWN BY : C.C.
PAGE : 1 OF 1 CHKD BY : G.Y.
SCALE : NTF APRVD BY : E.C.
UNIT : mm [INCH]

*UNLESS OTHERWISE SPECIFIED TOLERANCES PER DECIMAL PRECISION ARE: X=±1 (±0.039), X.X=±0.5 (±0.020), X.XX=±0.25 (±0.010), X.XXX=±0.127 (±0.005), LEAD SIZE=±0.05 (±0.002), LEAD LENGTH=±0.75 (±0.030), MIN=^{+0.00}/_{-0.00} DECIMAL PRECISION MAX = ^{+0.00}/_{-0.00} DECIMAL PRECISION

Looking for pricing, stock, or lifecycle information?

Click below to explore more details on WIN SOURCE:

- ⊖ [View SSF-LXH240GGD on WIN SOURCE](#)
- ⊖ [Lumex Opto/Components Inc. Information](#)

Optimize Your Supply Chain with WIN SOURCE Solutions

- ✓ Global Sourcing Solution
- ✓ Obsolete Management
- ✓ Cost Control Management
- ✓ Shortage Management
- ✓ Alternative Solution
- ✓ Excess Inventory Management