

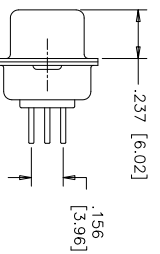

**THE DATASHEET OF
17EHD015PAA132**



REVISIONS			
REV	ECN, ERN NO.	DATE	APPRD.
B	PRODUCT DRAWING (EAR 14658)	MAY4/18	K.L.



TERMINATION-MTG. OPTION 1.30
VERTICAL MOUNT,
#4-40 UNC THREADED
THROUGH STANDOFFS

TERMINATION-MTG. OPTION 1.32
VERTICAL MOUNT,
#4-40 UNC STANDOFFS
WITH BOARDLOCKS

TERMINATION-MTG. OPTION 2.30
VERTICAL MOUNT, #4-40 UNC
HEX JACK SOCKETS,
STANDOFFS

TERMINATION-MTG. OPTION 2.32
VERTICAL MOUNT, #4-40 UNC
HEX JACK SOCKETS,
STANDOFFS WITH BOARDLOCKS

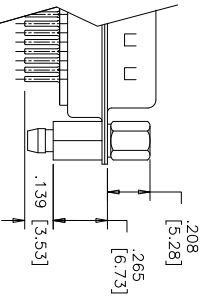
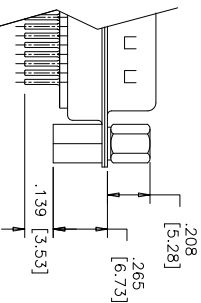
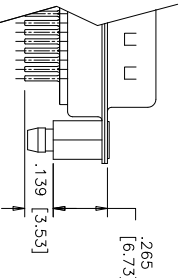
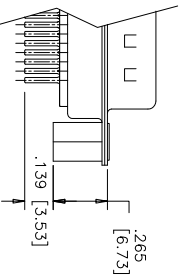

024 [0.61]
CB TAIL

0 [2.29] TYP.
3 [1.14] TYP.

LOCATE HOLES
POSITION
DIMENSIONS ARE
BASIC

ORDERING CODE:
PART NUMBER: 1 7 E H D - 0 1 5 P X X - X 3 X
SERIES _____
NUMBER OF CONTACTS _____
STYLE _____
P=PIN

TERMINATION-MOUNTING OPTIONS
030=VERTICAL MOUNT, ϕ .120 [3.05] THROUGH HOLE
130=VERTICAL MOUNT, #4-40 UNC STANDOFFS
132=VERTICAL MOUNT, #4-40 UNC STANDOFFS
WITH BOARDLOCKS
230=VERTICAL MOUNT, #4-40 UNC HEX JACK
SOCKETS, STANDOFFS
232=VERTICAL MOUNT, #4-40 UNC HEX JACK
SOCKETS, STANDOFFS WITH BOARDLOCKS

CONTACT PLATING OPTIONS
AA=ENGAGEMENT AREA 3 μ " [0.08 MICRONS] GOLD FLASH
CH=ENGAGEMENT AREA 15 μ " [0.38 MICRONS] GOLD
AM=ENGAGEMENT AREA 30 μ " [0.76 MICRONS] GOLD

ELECTRICAL DATA:
CURRENT RATING: 3 AMP
CONTACT RESISTANCE: 15 MILLIOHMS MAX.
INSULATION RESISTANCE: 3000 MEGOHMS MIN.
DIELECTRIC WITHSTANDING VOLTAGE: 1000 VAC rms
OPERATING TEMPERATURE: -55°C TO +105°C

NYLON, GLASS
TY RATING:
NG (SEE ORDERING CODE) OVER
L ON ENGAGEMENT AREA WITH
MATE TIN ON CONTACT

COMPLIANT

FOR ANY PURPOSE OR USED FOR MANUFACTURING
ON FROM AMPHENOL CANADA CORP.

DRAWN	E. CHEN	DATE	JUN/9/06
DESIGNED	K. LAMBIE		JUL/26/06
CHECKED			
I. E. APPRD.			
O. A. APPRD.			
DWG. APPRD.			
ENG. REL. NO.			
REF.	EAR 12956	DWG. DRAWING NO.	
DIMENSIONS ARE IN INCHES			
SCALE	2/1	WT.	SURF.
SHEET 1 OF 1			REV. B



Amphenol Canada Corp.

17EHD SERIES HIGH DENSITY D-SUB
CONNECTOR, 15 SIZE PIN, VERTICAL PCB
MOUNT CONTACTS, PLATING & MOUNTING
OPTIONS, ROHS COMPLIANT

B C D E F

Looking for pricing, stock, or lifecycle information?

Click below to explore more details on WIN SOURCE:

-  [View 17EHD015PAA132 on WIN SOURCE](#)
-  [Amphenol Commercial Products Information](#)

Optimize Your Supply Chain with WIN SOURCE Solutions

-  Global Sourcing Solution
-  Obsolete Management
-  Cost Control Management
-  Shortage Management
-  Alternative Solution
-  Excess Inventory Management