



THE DATASHEET OF
95-850-160M050



NOTES:

- 1. MATERIALS AND FINISHES:
 HD-BNC STR CRIMP PLUG - 34-1017-300
 CABLE - BELDEN 1694A
- 2. ELECTRICAL:
 A. IMPEDANCE: 75 OHM

- 3. PACKAGING:
 A. QUANTITY: SINGLE PACK
 B. MARKING: BAG TO BE MARKED
 "AMPHENOL RF, 95-850-160XXXX, AND DATE CODE"

THIRD ANGLE PROJ.

REVISIONS

REV	DESCRIPTION	DATE	ECO	APPR
A	RELEASE TO MFG	5/15/15	50370	NR/BCG

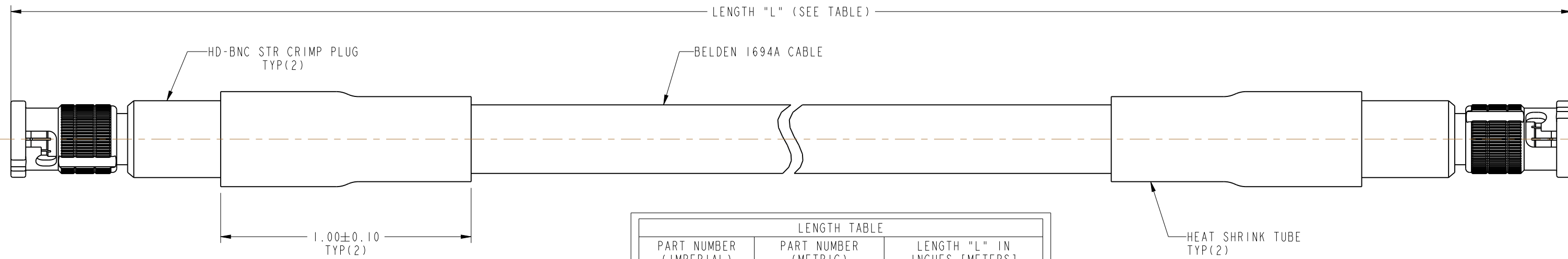

LENGTH TABLE		
PART NUMBER (IMPERIAL)	PART NUMBER (METRIC)	LENGTH "L" IN INCHES [METERS]
95-850-160-006	-	6.00 [0.152]
	95-850-160M025	9.84 [0.250]
95-850-160-012	-	12.00 [0.305]
95-850-160-018	-	18.00 [0.457]
-	95-850-160M050	19.69 [0.500]
95-850-160-024	-	24.00 [0.610]
-	95-850-160M075	29.53 [0.750]
95-850-160-036	-	36.00 [0.914]
-	95-850-160M100	39.37 [1.000]
95-850-160-048	-	48.00 [1.219]
-	95-850-160M125	49.21 [1.250]
-	95-850-160M150	59.06 [1.500]
95-850-160-060	-	60.00 [1.524]
95-850-160-072	-	72.00 [1.829]
-	95-850-160M200	78.74 [2.000]
-	95-850-160M300	118.11 [3.000]
95-850-160-120	-	120.00 [3.048]
95-850-160-180	-	180.00 [4.572]
	95-850-160M500	196.85 [5.000]
95-850-160-300	-	300.00 [7.620]
-	95-850-160M10L	393.70 [10.000]
95-850-160L050	-	600.00 [15.240]
-	95-850-160M20L	787.40 [20.000]
95-850-160L075	-	900.00 [22.860]
-	95-850-160M30L	1181.10 [30.000]
95-850-160L100	-	1200.00 [30.480]

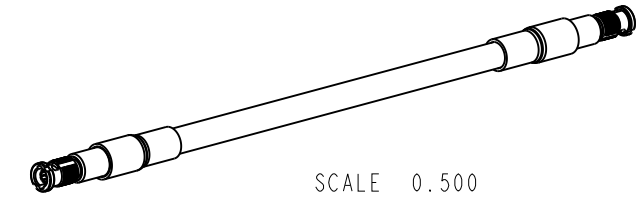



DESIGN REQUIREMENTS:			
<input checked="" type="checkbox"/> FREQUENCY DC TO 3 GHz	<input checked="" type="checkbox"/> CONTINUITY	<input type="checkbox"/> VSWR: _____ MAX	<input checked="" type="checkbox"/> HI-POT : 500 VRMS
<input type="checkbox"/> INS. LOSS _____ dB MIN	<input type="checkbox"/> OTHER		

CUSTOMER OUTLINE DRAWING
 ALL OTHER SHEETS ARE FOR INTERNAL USE ONLY

UNLESS OTHERWISE SPECIFIED, DIMENSIONS ARE IN INCHES AND TOLERANCES ARE: 2 PLACE DECIMAL 3 PLACE DECIMAL ANGLES ±.015 (0,381 mm) ±.005 (0,127 mm) ± 1°	MATERIAL	DRAWN	DATE	TITLE HD-BNC STR CRIMP PLUG TO HD-BNC STR CRIMP PLUG, USING BELDEN 1694A CABLE, VARIOUS LENGTH SCALE: 2.5:1.0 SHEET 2 OF 2		Amphenol RF www.amphenolrf.com
	SEE NOTES	KARTHIK R	09-Dec-14			
NOTICE - These drawings, specifications, or other data (1) are, and remain the property of Amphenol corp. (2) must be returned upon request; and (3) are confidential and not to be disclosed to any person other than those to whom they are given by Amphenol Corp. the furnishing of these drawings, specifications, or other data by Amphenol Corp., or to any other person to anyone for any purpose is not to be regarded by implication or otherwise in any manner licensing, granting rights to permitting such holder or any other person to manufacture, use or sell any product, process or design, patented or otherwise, that may in any way be related to or disclosed by said drawings, specifications, or other data.	REFERENCE	ENGINEER	DATE	DWG SIZE		DRAWING NO.95-850-160XXXX ITEM NO.95-850-160XXXX PART NO.95-850-160XXXX
	EAR # 6513	KARTHIK R	09-Dec-14	B		
	CONFIGURATION LEVEL: In Work	APPROVED	DATE	REV		
FINISH		K. CAPOZZI	5/7/15	A		

Looking for pricing, stock, or lifecycle information?

Click below to explore more details on WIN SOURCE:

-  [View 95-850-160M050 on WIN SOURCE](#)
-  [Amphenol-RF Division Information](#)

Optimize Your Supply Chain with WIN SOURCE Solutions

-  Global Sourcing Solution
-  Obsolete Management
-  Cost Control Management
-  Shortage Management
-  Alternative Solution
-  Excess Inventory Management