



## Fuse Strips for Diesel Vehicles Rated 36V

RoHS



Non-housed fuse strips for Diesel vehicles.  
Current rating 25A - 150A, 36 VDC. 90° fork type lugs.

Sicherungsstreifen ohne Gehäuse für Dieselfahrzeuge.  
Nennstrom 25A bis 150A, 36 VDC. 90°-Anschluss in Gabelform.

### Dimensions in mm / Maße in mm

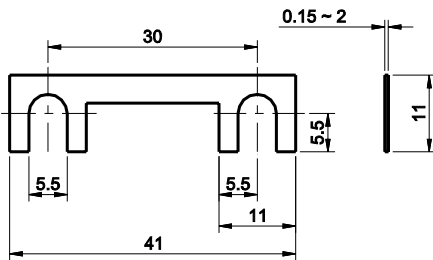

Part Number Artikel-Nr.	Current Rating Nennstrom	Typ. Voltage Drop Typ. Spannungsfall
156.5610.525_	25 A*	70 mV
156.5610.530_	30 A	70 mV
156.5610.540_	40 A*	70 mV
156.5610.550_	50 A	70 mV
156.5610.560_	60 A*	70 mV
156.5610.570_	70 A*	70 mV
156.5610.580_	80 A	70 mV
156.5610.610_	100 A	70 mV
156.5610.611_	120 A*	70 mV
156.5610.612_	125 A*	70 mV
156.5610.615_	150 A*	70 mV

\*Not mentioned in the standards  
Corresponding holder see Section "Fuse Holders."

### Specifications

DIN 72581/2

**Metal parts:** Zinc-alloy  
**Packaging:**

Series Serien	Pack Size Stückzahl
156.5610.xxx1	100
156.5610.xxx2	2000

### Pre-arcing Time - limits / Schmelzeit-Grenzwerte DIN

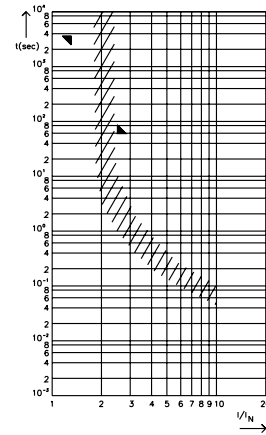

FI = 1.00 (max. operating current: 1.0 x I<sub>rat</sub> at 23°C)

### Time-Current Characteristics / Schmelzeit-Grenzwerte

% of Rating % des Nennstromes	Opening Time Min / Max (s) Schmelzcharakteristik Min / Max (s)
130	3,600 s / -
250	- / 60 s

## Looking for pricing, stock, or lifecycle information?

Click below to explore more details on WIN SOURCE:

 [View 156.5610.6151 on WIN SOURCE](#)

 [Littelfuse Inc. Information](#)

## Optimize Your Supply Chain with WIN SOURCE Solutions

-  Global Sourcing Solution
-  Obsolete Management
-  Cost Control Management
-  Shortage Management
-  Alternative Solution
-  Excess Inventory Management