



**THE DATASHEET OF**  
**4612**



“Stay Connected” with



Liquid Tight Cordgrips

a PennEngineering® Company

# Heyco® -Tite Brass Liquid Tight Cordgrips

## Straight-Thru, Metric Hubs

The Ultimate in Liquid Tight Strain Relief Protection



CABLE DIA. RANGE				PART NO.	THREAD SIZE	UL or RA	PART DIMENSIONS								
Minimum		Maximum					A		B		C		D		
in.	mm.	in.	mm.				Clearance Hole Dia.	in.	mm.	Max. O.A. Length	in.	mm.	Thread Length	in.	mm.

Standard Thread																		
.079	2,0	.098	2,5	<b>4500</b>	M6 x 1	cULUS	.236	6,0	.79	20,0	.32	8,0	.32	8,0				
.098	2,5	.118	3,0	<b>4501</b>														
.118	3,0	.138	3,5	<b>4502</b>														
.098	2,5	.138	3,5	<b>4503</b>	M8 x 1,25	cULUS	.315	8,0	.94	24,0	.39	10,0	.43	11,0				
.138	3,5	.197	5,0	<b>4504</b>														
.118	3,0	.157	4,0	<b>4505</b>	M10 x 1,5	cULUS	.394	10,0	.98	25,0	.39	10,0	.51	13,0				
.157	4,0	.236	6,0	<b>4506</b>														
.138	3,5	.197	5,0	<b>4507</b>	M12 x 1,5	cULUS	.472	12,0	1.06	27,0	.39	10,0	.59	15,0				
.197	5,0	.256	6,5	<b>4508</b>														
.256	6,5	.315	8,0	<b>4509</b>														
.138	3,5	.177	4,5	<b>4510</b>	M16 x 1,5	cULUS	.630	16,0	1.18	30,0	.39	10,0	.71	18,0				
.177	4,5	.236	6,0	<b>4511</b>														
.236	6,0	.315	8,0	<b>4512</b>														
.315	8,0	.413	10,5	<b>4513</b>	M16 x 1,5	cULUS	.630	16,0	1.26	32,0								
.236	6,0	.315	8,0	<b>4514</b>	M20 x 1,5	cULUS	.787	20,0	1.22	31,0	.39	10,0	.94	24,0				
.315	8,0	.433	11,0	<b>4515</b>														
.433	11,0	.591	15,0	<b>4516</b>	M20 x 1,5	cULUS	.787	20,0	1.30	33,0								
.374	9,5	.492	12,5	<b>4517</b>	M25 x 1,5	cULUS	.984	25,0	1.42	36,0								
.492	12,5	.630	16,0	<b>4518</b>	M25 x 1,5	cULUS	.984	25,0	1.50	38,0	.43	11,0	1.18	30,0				
.630	16,0	.807	20,5	<b>4519</b>	M25 x 1,5	cULUS	.984	25,0	1.54	39,0								
.551	14,0	.669	17,0	<b>4520</b>	M32 x 1,5	cULUS	1.260	32,0	1.61	41,0	.51	13,0	1.42	36,0				
.669	17,0	.827	21,0	<b>4521</b>														
.827	21,0	1.003	25,5	<b>4522</b>														
.787	20,0	.945	24,0	<b>4523</b>	M40 x 1,5	cULUS	1.574	40,0	1.73	44,0	.51	13,0	1.81	46,0				
.945	24,0	1.122	28,5	<b>4524</b>														
1.122	28,5	1.299	33,0	<b>4525</b>														
1.142	29,0	1.299	33,0	<b>4526</b>	M50 x 1,5	cULUS	1.968	50,0	1.89	48,0	.55	14,0	2.17	55,0				
1.299	33,0	1.457	37,0	<b>4527</b>														
1.457	37,0	1.654	42,0	<b>4528</b>														

Standard Thread, High Temperature*																
.630	16,0	.807	20,5	<b>4612</b>	M25 x 1,5	cULUS	.984	25,0	1.54	39,0	.43	11,0	1.18	30,0		

Short Thread																		
.079	2,0	.098	2,5	<b>14500</b>	M6 x 1	cULUS	.236	6,0	.67	17,0	.20	5,0	.32	8,0				
.098	2,5	.118	3,0	<b>14501</b>														
.118	3,0	.138	3,5	<b>14502</b>														
.098	2,5	.138	3,5	<b>14503</b>	M8 x 1,25	cULUS	.315	8,0	.75	19,0	.20	5,0	.43	11,0				
.138	3,5	.197	5,0	<b>14504</b>														
.118	3,0	.157	4,0	<b>14505</b>	M10 x 1,5	cULUS	.394	10,0	.79	20,0	.20	5,0	.51	13,0				
.157	4,0	.236	6,0	<b>14506</b>														
.138	3,5	.197	5,0	<b>14507</b>	M12 x 1,5	cULUS	.472	12,0	.87	22,0	.20	5,0	.59	15,0				
.197	5,0	.256	6,5	<b>14508</b>														
.256	6,5	.315	8,0	<b>14509</b>														
.138	3,5	.177	4,5	<b>14510</b>	M16 x 1,5	cULUS	.630	16,0	.98	25,0	.20	5,0	.71	18,0				
.177	4,5	.236	6,0	<b>14511</b>														
.236	6,0	.315	8,0	<b>14512</b>														
.315	8,0	.413	10,5	<b>14513</b>	M16 x 1,5	cULUS	.630	16,0	1.06	27,0								
.236	6,0	.315	8,0	<b>14514</b>	M20 x 1,5	cULUS	.787	20,0	1.06	27,0	.24	6,0	.94	24,0				
.315	8,0	.433	11,0	<b>14515</b>														
.433	11,0	.591	15,0	<b>14516</b>	M20 x 1,5	cULUS	.787	20,0	1.14	29,0								
.374	9,5	.492	12,5	<b>14517</b>	M25 x 1,5	cULUS	.984	25,0	1.26	32,0								
.492	12,5	.630	16,0	<b>14518</b>	M25 x 1,5	cULUS	.984	25,0	1.34	34,0	.28	7,0	1.18	30,0				
.630	16,0	.807	20,5	<b>14519</b>	M25 x 1,5	cULUS	.984	25,0	1.38	35,0								
.551	14,0	.669	17,0	<b>14520</b>	M32 x 1,5	cULUS	1.260	32,0	1.42	36,0	.31	8,0	1.42	36,0				
.669	17,0	.827	21,0	<b>14521</b>														
.827	21,0	1.003	25,5	<b>14522</b>														

Short Thread, High Temperature*																
.240	6,1	.413	10,5	<b>4696</b>	M16 x 1,5	cULUS	.629	16,0	1.06	27,0	.20	5,0	.71	18,0		
.315	8,0	.591	15,0	<b>4699</b>	M20 x 1,5	cULUS	.787	20,0	1.14	29,0	.24	6,0	.94	24,0		

- Nickel plated brass construction for superior protection of flexible cables.
- Nickel-plated finish over brass provides excellent corrosion resistance and durability.
- IP 68 rated.
- For use in clearance or threaded holes.
- Meets the New European standard EN 50262 version A for metric cordgrips.
- Long metric threads provide additional threads for easy locknut assembly.
- Multiple sizes for flexible cord diameters ranging from .079" (2,0 mm) to 1.654" (42,0 mm).
- We recommend using the smallest cordgrip that accommodates your cable size.
- Sealing gland is molded in Thermoplastic Polymer Elastomer (TPE) Material.
- Locknuts not included. For metal locknut specifications or to order locknuts separately, see page 3-48.
- See page 3-35 for Quick Specs.
- DFARS Compliant

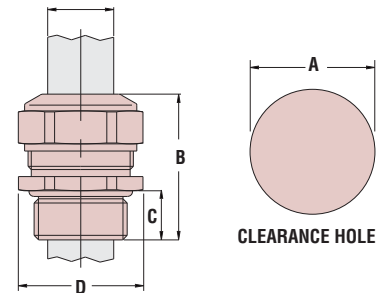

\* Special sealing gland rated to 200°C (392°F). Consult Heyco for other High Temperature rated sizes.

## Looking for pricing, stock, or lifecycle information?

Click below to explore more details on WIN SOURCE:

-  [View 4612 on WIN SOURCE](#)
-  [Heyco Products Corporation](#) Information

## Optimize Your Supply Chain with WIN SOURCE Solutions

-  Global Sourcing Solution
-  Obsolete Management
-  Cost Control Management
-  Shortage Management
-  Alternative Solution
-  Excess Inventory Management