



**THE DATASHEET OF
KLKD015.HXR**



Midget 10x38mm Fuses

FLQ Series

500 V ac • Time-Delay • 1/10–30 A



Description

The FLQ series 500 V fuses are designed to provide supplemental overcurrent protection of control power transformers, solenoids, and circuits with high in-rush currents. They also provide excellent supplemental protection of small motors. These time-delay fuses can carry an overload several times the normal load for a short period of time without blowing. The FLQ fuses are non-indicating and may be used with an indicating fuse block to identify a blown fuse. Note that UL and CSA 500 V ratings permit use on 480 V circuits.

Features & Benefits

| FEATURES | BENEFITS |
|------------------------------|---|
| 10x38 mm size | Common dimensions used in a variety of applications |
| Time-delay | Allows for temporary current surge for a short period of time without blowing |
| POWR-GARD® technology | Ensures quality backup overcurrent protection |

Applications

- Control circuit transformers
- Solenoids
- Circuits with high in-rush currents
- Small motors

Midget 10x38mm Fuses

FLQ Series

Specifications

| | |
|-----------------------------|--|
| Voltage Rating | Ac: 500 V ac or less Dc: 300 V |
| Interrupting Ratings | Ac: 10 kA rms symmetrical Dc: 10 kA self-certified |
| Ampere Range | $\frac{1}{10}$ –30 A |
| Applicable Standards | Ac: UL Listed (File: E10480) CSA Certified (File: LR29862) Dc: Littelfuse self-certified |
| Environmental | RoHS Compliant |
| Material | Body: Paper: $\frac{1}{10}$ A–5 A Melamine: 5 $\frac{1}{10}$ A–30 A Caps: Copper Alloy (Nickel plated) |
| Country of Origin | Mexico |

Certification & Compliance

| | |
|-------------|--|
| UL | UL Listed (File: E10480) |
| CSA | CSA Certified (File: LR29862) |
| CE | EU_DOC-FLQ_210701 |
| RoHS | RoHS 2 Directive 2011/65/EU; Directive (EU) 2015/863 |

Accessories

Littelfuse LPSM dead-front series fuse holder
Littelfuse L60030M open-face series fuse holder

Ordering Information

Ferrule Version

| AMP RATING | VOLTAGE (V AC) | INTERRUPTING RATING (KA) | | CATALOG NUMBER | PRODUCT MARKING | ORDERING NUMBER | UPC | AGENCY APPROVALS | |
|----------------|----------------|--------------------------|----|----------------|----------------------|-----------------|-------------|------------------|-----|
| | | AC | DC | | | | | UL | CSA |
| $\frac{1}{10}$ | 500 | 10 | 10 | FLQ.100 | FLQ $\frac{1}{10}$ A | 0FLQ.100T | 07945816011 | • | • |
| $\frac{1}{8}$ | 500 | 10 | 10 | FLQ.125 | FLQ $\frac{1}{8}$ A | 0FLQ.125T | 07945816012 | • | • |
| $\frac{1}{4}$ | 500 | 10 | 10 | FLQ.150 | FLQ $\frac{1}{4}$ A | 0FLQ.150T | 07945816013 | • | • |
| $\frac{3}{16}$ | 500 | 10 | 10 | FLQ.187 | FLQ $\frac{3}{16}$ A | 0FLQ.187T | 07945816017 | • | • |
| $\frac{1}{4}$ | 500 | 10 | 10 | FLQ.200 | FLQ $\frac{1}{4}$ A | 0FLQ.200T | 07945816018 | • | • |
| $\frac{3}{8}$ | 500 | 10 | 10 | FLQ.250 | FLQ $\frac{3}{8}$ A | 0FLQ.250T | 07945816019 | • | • |
| $\frac{1}{2}$ | 500 | 10 | 10 | FLQ.300 | FLQ $\frac{1}{2}$ A | 0FLQ.300T | 07945800089 | • | • |
| $\frac{3}{4}$ | 500 | 10 | 10 | FLQ.400 | FLQ $\frac{3}{4}$ A | 0FLQ.400T | 07945816023 | • | • |
| 1 | 500 | 10 | 10 | FLQ.500 | FLQ 1A | 0FLQ.500T | 07945816024 | • | • |
| $1\frac{1}{4}$ | 500 | 10 | 10 | FLQ.600 | FLQ $1\frac{1}{4}$ A | 0FLQ.600T | 07945800090 | • | • |
| $1\frac{1}{2}$ | 500 | 10 | 10 | FLQ.800 | FLQ $1\frac{1}{2}$ A | 0FLQ.800T | 07945800091 | • | • |
| 2 | 500 | 10 | 10 | FLQ001 | FLQ 2A | 0FLQ001.T | 07945816031 | • | • |
| $2\frac{1}{2}$ | 500 | 10 | 10 | FLQ1.12 | FLQ $2\frac{1}{2}$ A | 0FLQ1.12T | 07945816032 | • | • |
| 3 | 500 | 10 | 10 | FLQ1.25 | FLQ 3A | 0FLQ1.25T | 07945816034 | • | • |

Midget 10x38mm Fuses

FLQ Series

Ordering Information

Ferrule Version

| AMP RATING | VOLTAGE (V AC) | INTERRUPTING RATING (KA) | | CATALOG NUMBER | PRODUCT MARKING | ORDERING NUMBER | UPC | AGENCY APPROVALS | |
|------------|----------------|--------------------------|----|----------------|-----------------|-----------------|-------------|------------------|-----|
| | | AC | DC | | | | | UL | CSA |
| 1 ½ | 500 | 10 | 10 | FLQ01.5 | FLQ 1-½A | OFLQ01.5T | 07945816037 | • | • |
| 1 ⅝ | 500 | 10 | 10 | FLQ01.6 | FLQ 1-⅝A | OFLQ01.6T | 07945816038 | • | • |
| 2 | 500 | 10 | 10 | FLQ002 | FLQ 2A | OFLQ002.T | 07945816041 | • | • |
| 2 ¼ | 500 | 10 | 10 | FLQ2.25 | FLQ 2-¼A | OFLQ2.25T | 07945816042 | • | • |
| 2 ½ | 500 | 10 | 10 | FLQ02.5 | FLQ 2-½A | OFLQ02.5T | 07945816043 | • | • |
| 3 | 500 | 10 | 10 | FLQ003 | FLQ 3A | OFLQ003.T | 07945816047 | • | • |
| 3 ⅝ | 500 | 10 | 10 | FLQ03.2 | FLQ 3-⅝A | OFLQ03.2T | 07945816049 | • | • |
| 3 ½ | 500 | 10 | 10 | FLQ03.5 | FLQ 3-½A | OFLQ03.5T | 07945816051 | • | • |
| 4 | 500 | 10 | 10 | FLQ004 | FLQ 4A | OFLQ004.T | 07945816053 | • | • |
| 4 ½ | 500 | 10 | 10 | FLQ04.5 | FLQ 4-½A | OFLQ04.5T | 07945816054 | • | • |
| 5 | 500 | 10 | 10 | FLQ005 | FLQ 5A | OFLQ005.T | 07945816055 | • | • |
| 5 ⅝ | 500 | 10 | 10 | FLQ05.6 | FLQ 5-⅝A | OFLQ05.6T | 07945816056 | • | • |
| 6 | 500 | 10 | 10 | FLQ006 | FLQ 6A | OFLQ006.T | 07945816058 | • | • |
| 6 ¼ | 500 | 10 | 10 | FLQ6.25 | FLQ 6-¼A | OFLQ6.25T | 07945816059 | • | • |
| 7 | 500 | 10 | 10 | FLQ007 | FLQ 7A | OFLQ007.T | 07945816061 | • | • |
| 8 | 500 | 10 | 10 | FLQ008 | FLQ 8A | OFLQ008.T | 07945816063 | • | • |
| 9 | 500 | 10 | 10 | FLQ009 | FLQ 9A | OFLQ009.T | 07945816064 | • | • |
| 10 | 500 | 10 | 10 | FLQ010 | FLQ 10A | OFLQ010.T | 07945816065 | • | • |
| 12 | 500 | 10 | 10 | FLQ012 | FLQ 12A | OFLQ012.T | 07945816066 | • | • |
| 14 | 500 | 10 | 10 | FLQ014 | FLQ 14A | OFLQ014.T | 07945816067 | • | • |
| 15 | 500 | 10 | 10 | FLQ015 | FLQ 15A | OFLQ015.T | 07945816068 | • | • |
| 20 | 500 | 10 | 10 | FLQ020 | FLQ 20A | OFLQ020.T | 07945816071 | • | • |
| 25 | 500 | 10 | 10 | FLQ025 | FLQ 25A | OFLQ025.T | 07945816072 | • | • |
| 30 | 500 | 10 | 10 | FLQ030 | FLQ 30A | OFLQ030.T | 07945816073 | • | • |

Ordering Information

PCB Mount 1-Tab Version

| AMP RATING | VOLTAGE (V AC) | INTERRUPTING RATING (KA) | | CATALOG NUMBER | PRODUCT MARKING | ORDERING NUMBER | UPC | AGENCY APPROVALS | |
|---------------------------------|----------------|--------------------------|----|----------------|---|-----------------|-------------|------------------|-----|
| | | AC | DC | | | | | UL | CSA |
| 1 ⁵ / ₁₀₀ | 500 | 10 | 10 | FLQ.150R | FLQ 1 ⁵ / ₁₀₀ A-R | OFLQ.150HXR | 07945894950 | • | • |
| ⅓ ₁₆ | 500 | 10 | 10 | FLQ.187R | FLQ ⅓ ₁₆ A-R | OFLQ.187HXR | 07945894951 | • | • |
| ⅓ ₁₀ | 500 | 10 | 10 | FLQ.200R | FLQ ⅓ ₁₀ A-R | OFLQ.200HXR | 07945894952 | • | • |
| ¼ | 500 | 10 | 10 | FLQ.250R | FLQ ¼A-R | OFLQ.250HXR | 07945894953 | • | • |
| ⅓ ₁₀ | 500 | 10 | 10 | FLQ.300R | FLQ ⅓ ₁₀ A-R | OFLQ.300HXR | 07945894954 | • | • |
| ⅓ ₁₀ | 500 | 10 | 10 | FLQ.400R | FLQ ⅓ ₁₀ A-R | OFLQ.400HXR | 07945894955 | • | • |
| ½ | 500 | 10 | 10 | FLQ.500R | FLQ ½A-R | OFLQ.500HXR | 07945894956 | • | • |
| ⅔ ₁₀ | 500 | 10 | 10 | FLQ.600R | FLQ ⅔ ₁₀ A-R | OFLQ.600HXR | 07945894957 | • | • |
| ⅔ ₁₀ | 500 | 10 | 10 | FLQ.800R | FLQ ⅔ ₁₀ A-R | OFLQ.800HXR | 07945894958 | • | • |

Midget 10x38mm Fuses

FLQ Series

Ordering Information

PCB Mount 1-Tab Version

| AMP RATING | VOLTAGE (V AC) | INTERRUPTING RATING (KA) | | CATALOG NUMBER | PRODUCT MARKING | ORDERING NUMBER | UPC | AGENCY APPROVALS | |
|------------|----------------|--------------------------|----|----------------|-----------------|-----------------|-------------|------------------|-----|
| | | AC | DC | | | | | UL | CSA |
| 1 | 500 | 10 | 10 | FLQ001R | FLQ 1A-R | OFLQ001.HXR | 07945894959 | • | • |
| 1 1/8 | 500 | 10 | 10 | FLQ1.12R | FLQ 1 1/8A-R | OFLQ1.12HXR | 07945894981 | • | • |
| 1 1/4 | 500 | 10 | 10 | FLQ1.25R | FLQ 1 1/4A-R | OFLQ1.25HXR | 07945894982 | • | • |
| 1 1/2 | 500 | 10 | 10 | FLQ01.5R | FLQ 1 1/2A-R | OFLQ01.5HXR | 07945894967 | • | • |
| 1 3/10 | 500 | 10 | 10 | FLQ01.6R | FLQ 1 3/10A-R | OFLQ01.6HXR | 07945894968 | • | • |
| 2 | 500 | 10 | 10 | FLQ002R | FLQ 2A-R | OFLQ002.HXR | 07945894960 | • | • |
| 2 1/4 | 500 | 10 | 10 | FLQ2.25R | FLQ 2 1/4A-R | OFLQ2.25HXR | 07945894983 | • | • |
| 2 1/2 | 500 | 10 | 10 | FLQ02.5R | FLQ 2 1/2A-R | OFLQ02.5HXR | 07945894973 | • | • |
| 3 | 500 | 10 | 10 | FLQ003R | FLQ 3A-R | OFLQ003.HXR | 07945894961 | • | • |
| 3 3/10 | 500 | 10 | 10 | FLQ03.2R | FLQ 3 3/10A-R | OFLQ03.2HXR | 07945894976 | • | • |
| 3 1/2 | 500 | 10 | 10 | FLQ03.5R | FLQ 3 1/2A-R | OFLQ03.5HXR | 07945894977 | • | • |
| 4 | 500 | 10 | 10 | FLQ004R | FLQ 4A-R | OFLQ004.HXR | 07945894962 | • | • |
| 4 1/2 | 500 | 10 | 10 | FLQ04.5R | FLQ 4 1/2A-R | OFLQ04.5HXR | 07945894979 | • | • |
| 5 | 500 | 10 | 10 | FLQ005R | FLQ 5A-R | OFLQ005.HXR | 07945894963 | • | • |
| 5 5/10 | 500 | 10 | 10 | FLQ05.6R | FLQ 5 5/10A-R | OFLQ05.6HXR | 07945894980 | • | • |
| 6 1/4 | 500 | 10 | 10 | FLQ6.25R | FLQ 6 1/4A-R | OFLQ6.25HXR | 07945894984 | • | • |
| 7 | 500 | 10 | 10 | FLQ007R | FLQ 7A-R | OFLQ007.HXR | 07945894964 | • | • |
| 8 | 500 | 10 | 10 | FLQ008R | FLQ 8A-R | OFLQ008.HXR | 07945894965 | • | • |
| 9 | 500 | 10 | 10 | FLQ009R | FLQ 9A-R | OFLQ009.HXR | 07945894966 | • | • |
| 10 | 500 | 10 | 10 | FLQ010R | FLQ 10A-R | OFLQ010.HXR | 07945894969 | • | • |
| 12 | 500 | 10 | 10 | FLQ012R | FLQ 12A-R | OFLQ012.HXR | 07945807768 | • | • |
| 14 | 500 | 10 | 10 | FLQ014R | FLQ 14A-R | OFLQ014.HXR | 07945894971 | • | • |
| 15 | 500 | 10 | 10 | FLQ015R | FLQ 15A-R | OFLQ015.HXR | 07945894972 | • | • |
| 20 | 500 | 10 | 10 | FLQ020R | FLQ 20A-R | OFLQ020.HXR | 07945894974 | • | • |
| 25 | 500 | 10 | 10 | FLQ025R | FLQ 25A-R | OFLQ025.HXR | 07945894975 | • | • |
| 30 | 500 | 10 | 10 | FLQ030R | FLQ 30A-R | OFLQ030.HXR | 07945894978 | • | • |

Midget 10x38mm Fuses

FLQ Series

Dimensions Millimeters (inches)

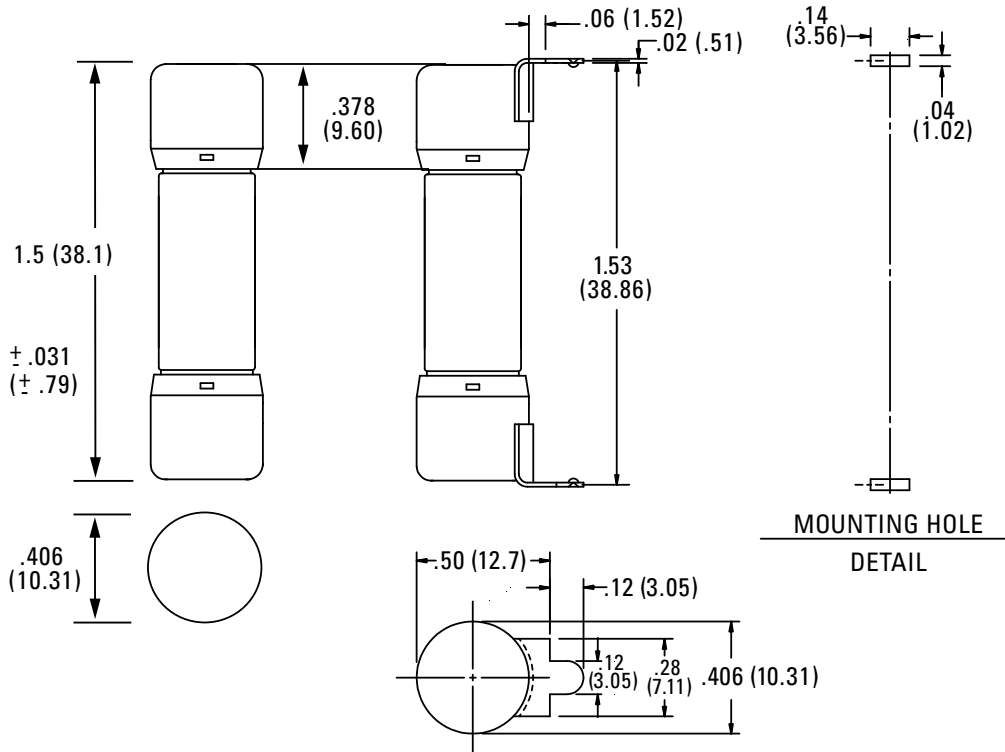

Temperature Derating Curve

Ambient temperature: temperature of air immediately surrounding fuse

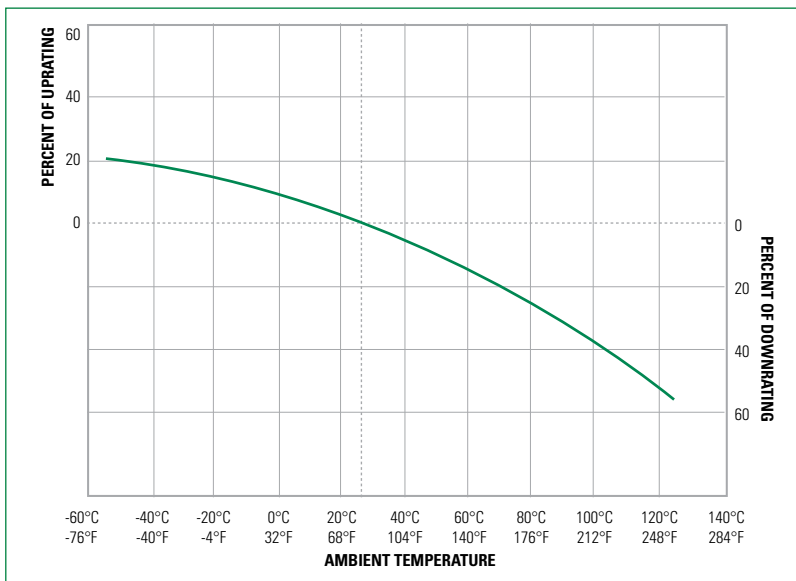

Midget 10x38mm Fuses

FLQ Series

Time Current Curves

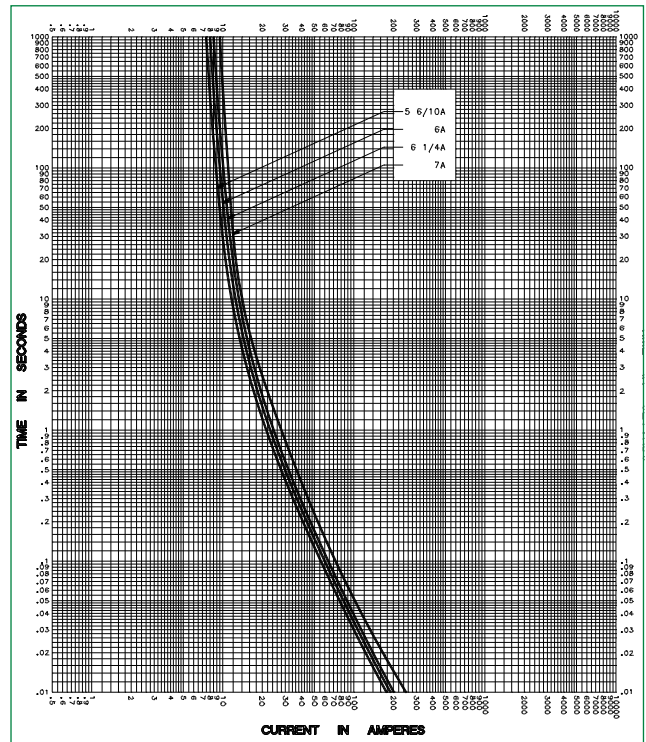
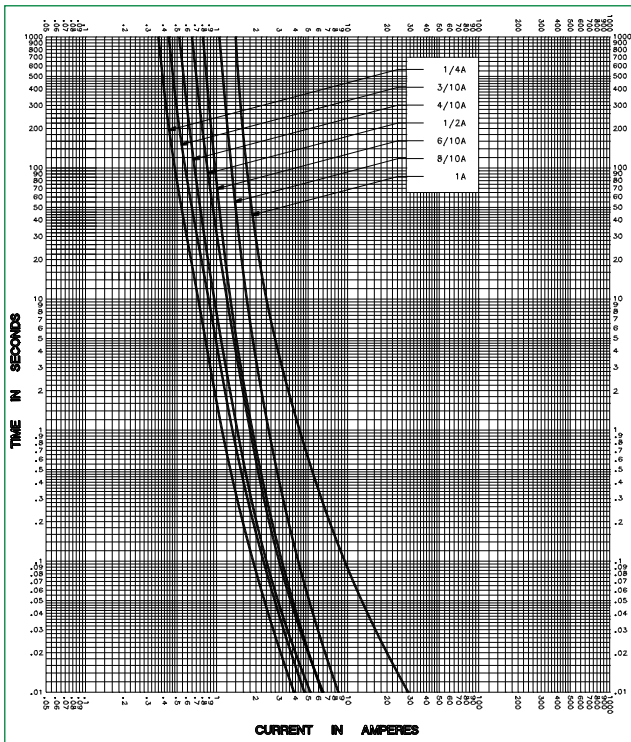
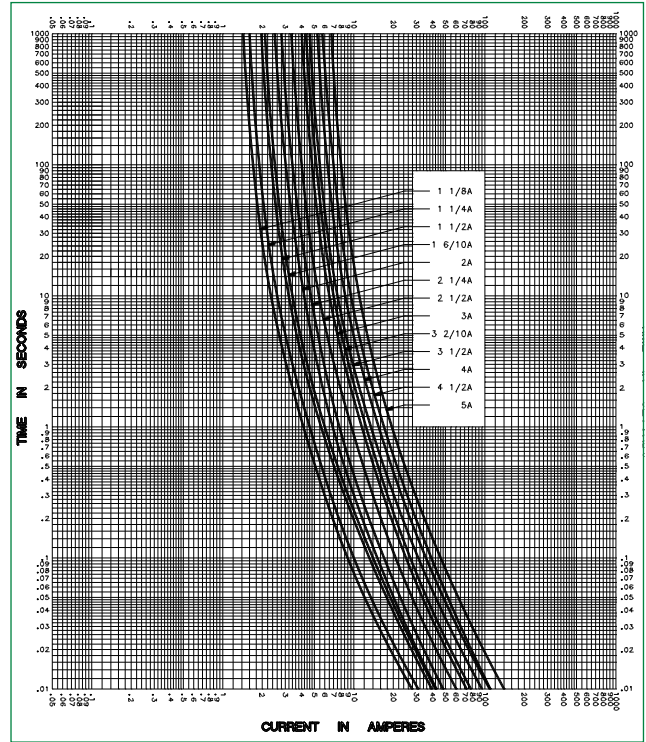
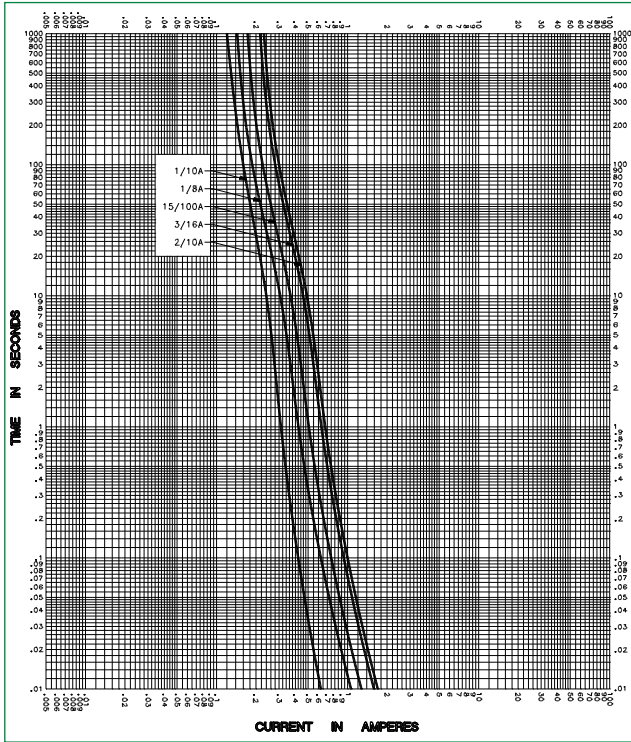

Midget 10x38mm Fuses

FLQ Series

Time Current Curves

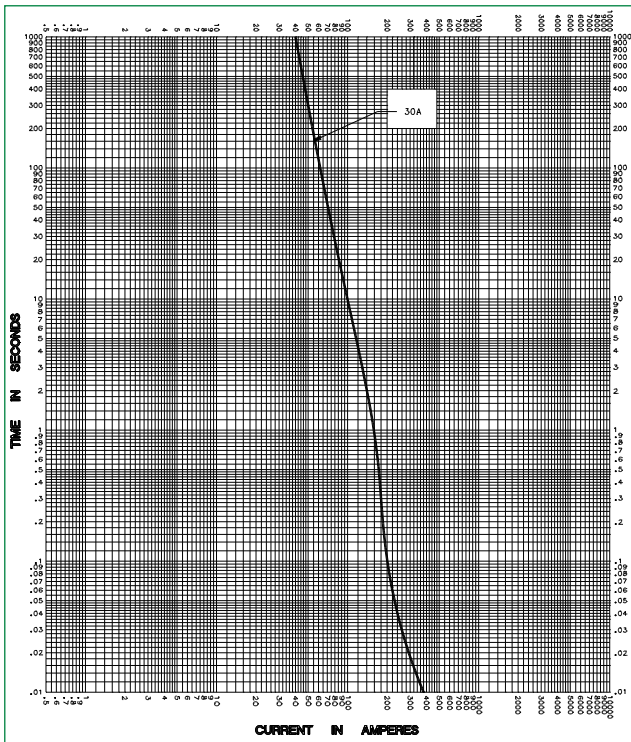
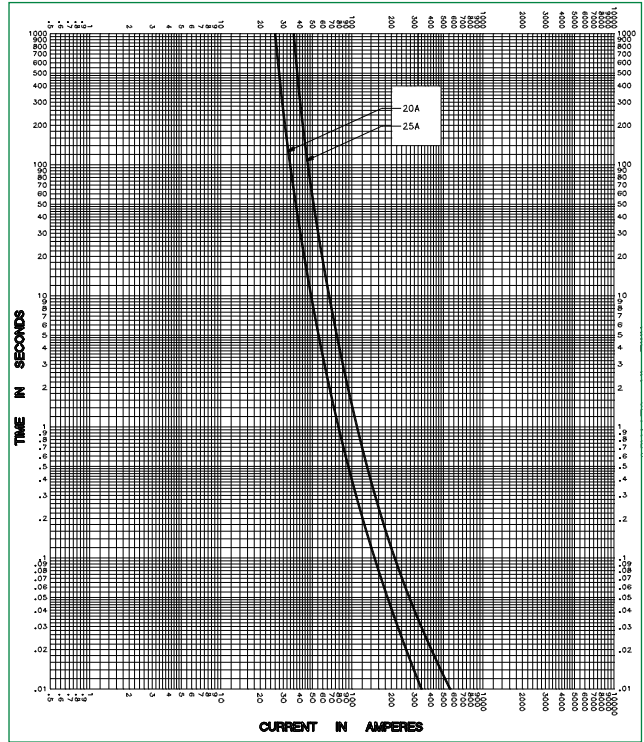
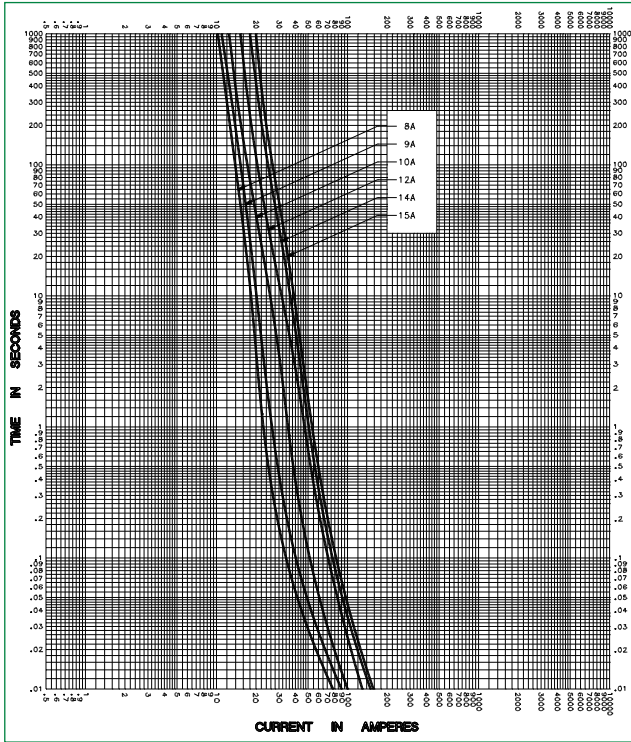

Disclaimer Notice – Information furnished is believed to be accurate and reliable. However, users should independently evaluate the suitability of and test each product selected for their own applications. Littelfuse products are not designed for, and may not be used in, all applications. Read complete Disclaimer Notice at www.littelfuse.com/product-disclaimer.

Looking for pricing, stock, or lifecycle information?

Click below to explore more details on WIN SOURCE:

 [View KLKD015.HXR on WIN SOURCE](#)

 [Littelfuse Inc. Information](#)

Optimize Your Supply Chain with WIN SOURCE Solutions

-  Global Sourcing Solution
-  Obsolete Management
-  Cost Control Management
-  Shortage Management
-  Alternative Solution
-  Excess Inventory Management