



THE DATASHEET OF S2



REVISION FOR DWG # 1PB-S1-4

REV	CH.NO.	DESCRIPTION	DATE	REVISED BY
-	-	ORIGINAL DESIGN	11/15/2007	PHILIPP E.

**S1**

Normally Open Silver

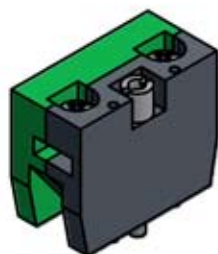
**S3**

Normally Open Gold Plated

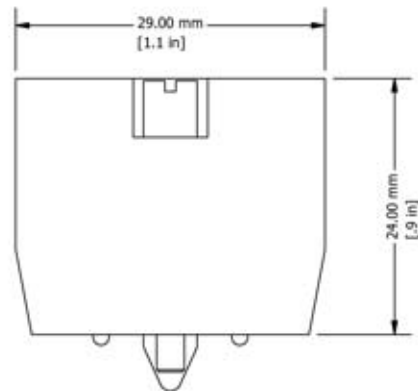
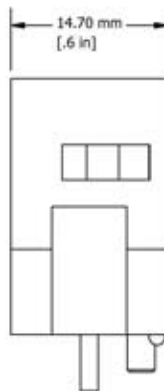
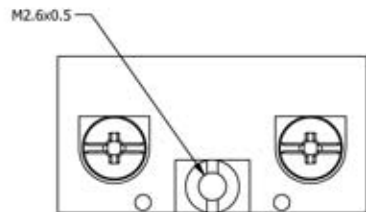
**S2**

Normally Closed Silver

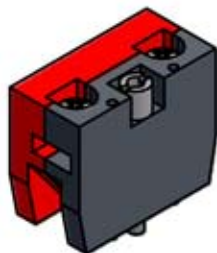
**S4**

Normally Closed Gold Plated

UNLESS OTHERWISE SPECIFIED:

- ALL DIMENSIONS ARE IN MILLIMETERS
- THIRD ANGLE PROJECTION

M
E
T
R
I
C

This Drawing is the property of

35 Royal Road
 Flemington, NJ 08822-6000
 (908) 806-9400
 Fax (908) 806-9400

AND IS A CONFIDENTIAL
 DISCLOSURE WITHOUT
 CONSIDERATION OTHER THAN THE
 BORROWER'S AGREEMENT THAT IT
 SHALL NOT BE REPRODUCED,
 COPIED, LENT OR DISPOSED OF
 DIRECTLY OR INDIRECTLY NOR
 USED FOR ANY PURPOSE OTHER
 THAN THAT FOR WHICH IT IS
 SPECIFICALLY FURNISHED.

TITLE **22 mm Push Button Switch Contacts Panel Mount Types S1, S2, S3, S4**

DRAWN BY:
Philipp Ernstberger

11/15/2007

CHECKED BY:
Laszlo Gyorgypal

11/15/2007

RELEASED BY:
Laszlo Gyorgypal

11/15/2007

DRAWING NO.:

1PB-S1-4

REV.:

-



SCALE: -

SHEET: 1

OF: 1

Looking for pricing, stock, or lifecycle information?

Click below to explore more details on WIN SOURCE:

-  [View S2](#) on WIN SOURCE
-  [Altech corporation](#) Information

Optimize Your Supply Chain with WIN SOURCE Solutions

-  Global Sourcing Solution
-  Obsolete Management
-  Cost Control Management
-  Shortage Management
-  Alternative Solution
-  Excess Inventory Management