



**THE DATASHEET OF
VLF5010ST-3R3M1R4**



SMD Inductors(Coils) For Power Line(Wound, Magnetic Shielded)

Conformity to RoHS Directive

VLF Series VLF5010S

FEATURES

- Miniature size
Mount area: 4.6×4.8mm
Height: 1.0mm max.
- Generic use for portable DC to DC converter line.
- High magnetic shield construction should actualize high resolution for EMC protection.
- Available for automatic mounting in tape and reel package.
- The products do not contain lead and support lead-free soldering.

APPLICATIONS

DVCs, DSCs, PDAs, LCD displays, cellular phones, HDDs, etc.

SHAPES AND DIMENSIONS

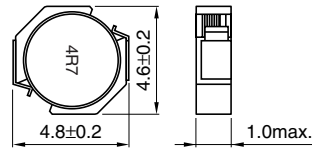

Dimensions in mm

RECOMMENDED PC BOARD PATTERN

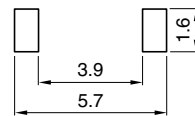

Dimensions in mm

ELECTRICAL CHARACTERISTICS

Part No.	Inductance (μH)	Inductance tolerance(%)	Test frequency (MHz)	DC resistance(Ω)		Rated current(A)*	
				max.	typ.	Based on inductance change max.	Based on temperature rise typ.
VLF5010ST-1R0N2R5	1	±30	1	0.054	0.045	2.7	2.5
VLF5010ST-2R2M2R0	2.2	±20	1	0.077	0.064	2	2
VLF5010ST-3R3M1R4	3.3	±20	1	0.16	0.13	1.6	1.4
VLF5010ST-4R7M1R3	4.7	±20	1	0.18	0.15	1.4	1.3
VLF5010ST-6R8M1R1	6.8	±20	1	0.24	0.2	1.1	1.2
VLF5010ST-100MR94	10	±20	1	0.37	0.31	1	0.94

* Rated current: Value obtained when current flows and the temperature has risen to 40°C or when DC current flows and the nominal value of inductance has fallen by 30%, whichever is smaller.

- Operating temperature range: -40 to +105°C (Including self-temperature rise)

TYPICAL ELECTRICAL CHARACTERISTICS

INDUCTANCE vs. DC SUPERPOSITION CHARACTERISTICS

VLF5010ST-1R0N2R5

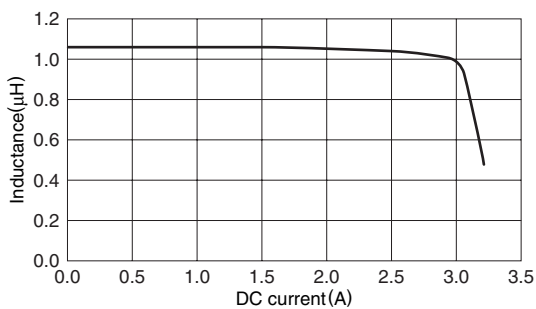

VLF5010ST-2R2M2R0

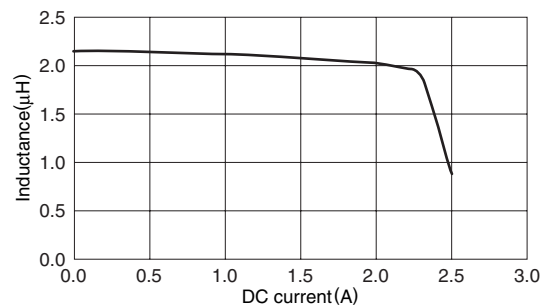

• Conformity to RoHS Directive: This means that, in conformity with EU Directive 2002/95/EC, lead, cadmium, mercury, hexavalent chromium, and specific bromine-based flame retardants, PBB and PBDE, have not been used, except for exempted applications.

• All specifications are subject to change without notice.

TYPICAL ELECTRICAL CHARACTERISTICS
INDUCTANCE vs. DC SUPERPOSITION CHARACTERISTICS
VLF5010ST-3R3M1R4

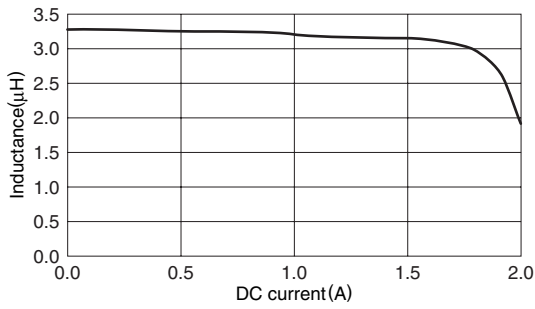

VLF5010ST-4R7M1R3

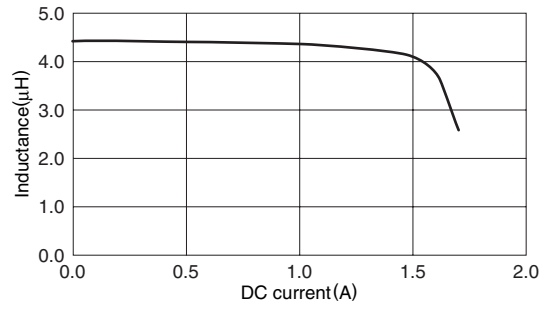

VLF5010ST-6R8M1R1

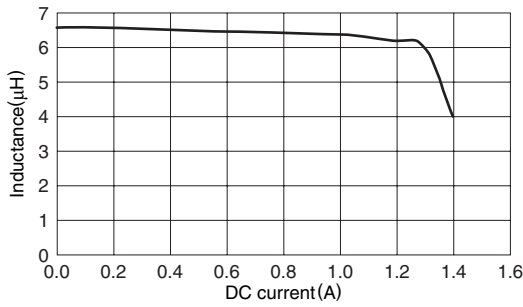

VLF5010ST-100MR94

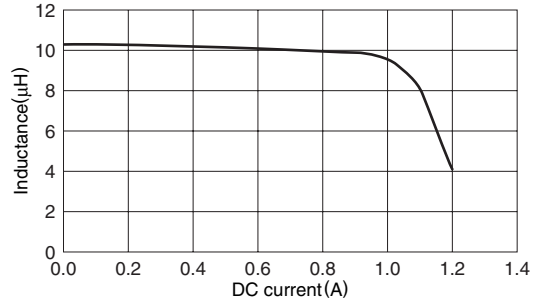

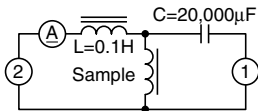

TEST CIRCUIT



1: LCR meter 4285A f=1MHz
 2: DC constant current

Looking for pricing, stock, or lifecycle information?

Click below to explore more details on WIN SOURCE:

-  [View VLF5010ST-3R3M1R4 on WIN SOURCE](#)
-  [TDK Corporation Information](#)

Optimize Your Supply Chain with WIN SOURCE Solutions

-  Global Sourcing Solution
-  Obsolete Management
-  Cost Control Management
-  Shortage Management
-  Alternative Solution
-  Excess Inventory Management