



**THE DATASHEET OF  
IPP110N20NAAKSA1**



**OptiMOS™3 Power-Transistor**
**Features**

- N-channel, normal level
- Excellent gate charge x  $R_{DS(on)}$  product (FOM)
- Very low on-resistance  $R_{DS(on)}$
- 175 °C operating temperature
- Pb-free lead plating; RoHS compliant
- Qualified according to AEC Q101
- Halogen-free according to IEC61249-2-21
- Ideal for high-frequency switching and synchronous rectification

**Product Summary**

|                          |      |            |
|--------------------------|------|------------|
| $V_{DS}$                 | 200  | V          |
| $R_{DS(on),max}$ (TO263) | 10.7 | m $\Omega$ |
| $I_D$                    | 88   | A          |

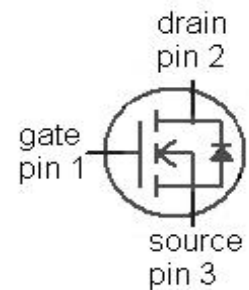

| Type    | IPB107N20NA | IPP110N20NA |
|---------|-------------|-------------|
|         |             |             |
| Package | PG-TO263-3  | PG-TO220-3  |
| Marking | 107N20NA    | 110N20NA    |

**Maximum ratings, at  $T_j=25\text{ °C}$ , unless otherwise specified**

| Parameter                           | Symbol         | Conditions                           | Value       | Unit        |
|-------------------------------------|----------------|--------------------------------------|-------------|-------------|
| Continuous drain current            | $I_D$          | $T_C=25\text{ °C}$                   | 88          | A           |
|                                     |                | $T_C=100\text{ °C}$                  | 63          |             |
| Pulsed drain current <sup>1)</sup>  | $I_{D,pulse}$  | $T_C=25\text{ °C}$                   | 352         |             |
| Avalanche energy, single pulse      | $E_{AS}$       | $I_D=80\text{ A}, R_{GS}=25\ \Omega$ | 560         | mJ          |
| Reverse diode $dv/dt$               | $dv/dt$        |                                      | 10          | kV/ $\mu$ s |
| Gate source voltage                 | $V_{GS}$       |                                      | $\pm 20$    | V           |
| Power dissipation                   | $P_{tot}$      | $T_C=25\text{ °C}$                   | 300         | W           |
| Operating and storage temperature   | $T_j, T_{stg}$ |                                      | -55 ... 175 | °C          |
| IEC climatic category; DIN IEC 68-1 |                |                                      | 55/175/56   |             |

<sup>1)</sup> See figure 3

| Parameter | Symbol | Conditions | Values |      |      | Unit |
|-----------|--------|------------|--------|------|------|------|
|           |        |            | min.   | typ. | max. |      |

**Thermal characteristics**

|  |            |  |   |   |     |     |
|--|------------|--|---|---|-----|-----|
| Thermal resistance, junction - case    | $R_{thJC}$ |  | - | - | 0.5 | K/W |
| Thermal resistance, junction - ambient | $R_{thJA}$ | minimal footprint                            | - | - | 62  |     |
|  |            | 6 cm <sup>2</sup> cooling area <sup>2)</sup> | - | - | 40  |     |

**Electrical characteristics, at  $T_j=25\text{ °C}$ , unless otherwise specified**
**Static characteristics**

|                                  |               |   |     |     |      |               |
|----------------------------------|---------------|---|-----|-----|------|---------------|
| Drain-source breakdown voltage   | $V_{(BR)DSS}$ | $V_{GS}=0\text{ V}, I_D=1\text{ mA}$                        | 200 | -   | -    | V             |
| Gate threshold voltage           | $V_{GS(th)}$  | $V_{DS}=V_{GS}, I_D=270\text{ }\mu\text{A}$                 | 2   | 3   | 4    |               |
| Zero gate voltage drain current  | $I_{DSS}$     | $V_{DS}=160\text{ V}, V_{GS}=0\text{ V}, T_j=25\text{ °C}$  | -   | 0.1 | 1    | $\mu\text{A}$ |
|                                  |               | $V_{DS}=160\text{ V}, V_{GS}=0\text{ V}, T_j=125\text{ °C}$ | -   | 10  | 100  |               |
| Gate-source leakage current      | $I_{GSS}$     | $V_{GS}=20\text{ V}, V_{DS}=0\text{ V}$                     | -   | 1   | 100  | nA            |
| Drain-source on-state resistance | $R_{DS(on)}$  | $V_{GS}=10\text{ V}, I_D=88\text{ A},$<br>(TO220)           | -   | 9.9 | 11   | m $\Omega$    |
|                                  |               | $V_{GS}=10\text{ V}, I_D=88\text{ A},$<br>(TO263)           | -   | 9.6 | 10.7 |               |

<sup>2)</sup> Device on 40 mm x 40 mm x 1.5 mm epoxy PCB FR4 with 6 cm<sup>2</sup> (one layer, 70  $\mu\text{m}$  thick) copper area for drain connection. PCB is vertical in still air.

| Parameter | Symbol | Conditions | Values |      |      | Unit |
|-----------|--------|------------|--------|------|------|------|
|           |        |            | min.   | typ. | max. |      |

**Dynamic characteristic<sup>4)</sup>**

|                              |              |   |   |      |      |    |
|------------------------------|--------------|---|---|------|------|----|
| Input capacitance            | $C_{iss}$    | $V_{GS}=0\text{ V}, V_{DS}=100\text{ V},$<br>$f=1\text{ MHz}$                         | - | 5340 | 7100 | pF |
| Output capacitance           | $C_{oss}$    |   | - | 401  | 533  |    |
| Reverse transfer capacitance | $C_{rss}$    |   | - | 5    | -    |    |
| Turn-on delay time           | $t_{d(on)}$  | $V_{DD}=100\text{ V},$<br>$V_{GS}=10\text{ V}, I_D=44\text{ A},$<br>$R_G=1.6\ \Omega$ | - | 18   | -    | ns |
| Rise time                    | $t_r$        |   | - | 26   | -    |    |
| Turn-off delay time          | $t_{d(off)}$ |   | - | 41   | -    |    |
| Fall time                    | $t_f$        |   | - | 11   | -    |    |

**Gate Charge Characteristics<sup>3)</sup>**

|                       |               |   |   |     |     |    |
|-----------------------|---------------|---|---|-----|-----|----|
| Gate to source charge | $Q_{gs}$      | $V_{DD}=100\text{ V}, I_D=44\text{ A},$<br>$V_{GS}=0\text{ to }10\text{ V}$ | - | 23  | -   | nC |
| Gate to drain charge  | $Q_{gd}$      |   | - | 8   | -   |    |
| Switching charge      | $Q_{sw}$      |   | - | 15  | -   |    |
| Gate charge total     | $Q_g$         |   | - | 65  | 87  |    |
| Gate plateau voltage  | $V_{plateau}$ |   | - | 4.4 | -   | V  |
| Output charge         | $Q_{oss}$     | $V_{DD}=100\text{ V}, V_{GS}=0\text{ V}$                                    | - | 162 | 216 | nC |

**Reverse Diode<sup>4)</sup>**

|                                  |               |  |   |     |     |    |
|----------------------------------|---------------|--|---|-----|-----|----|
| Diode continuous forward current | $I_S$         | $T_C=25\text{ }^\circ\text{C}$   | - | -   | 88  | A  |
| Diode pulse current              | $I_{S,pulse}$ |  | - | -   | 352 |    |
| Diode forward voltage            | $V_{SD}$      | $V_{GS}=0\text{ V}, I_F=88\text{ A},$<br>$T_j=25\text{ }^\circ\text{C}$    | - | 1   | 1.2 | V  |
| Reverse recovery time            | $t_{rr}$      | $V_R=100\text{ V}, I_F=44\text{ A},$<br>$di_F/dt=100\text{ A}/\mu\text{s}$ | - | 142 | -   | ns |
| Reverse recovery charge          | $Q_{rr}$      |  | - | 640 | -   | nC |

<sup>3)</sup> See figure 16 for gate charge parameter definition

<sup>4)</sup> Not subjected to production test - verified by design/characterization

**1 Power dissipation**

$P_{tot}=f(T_C)$

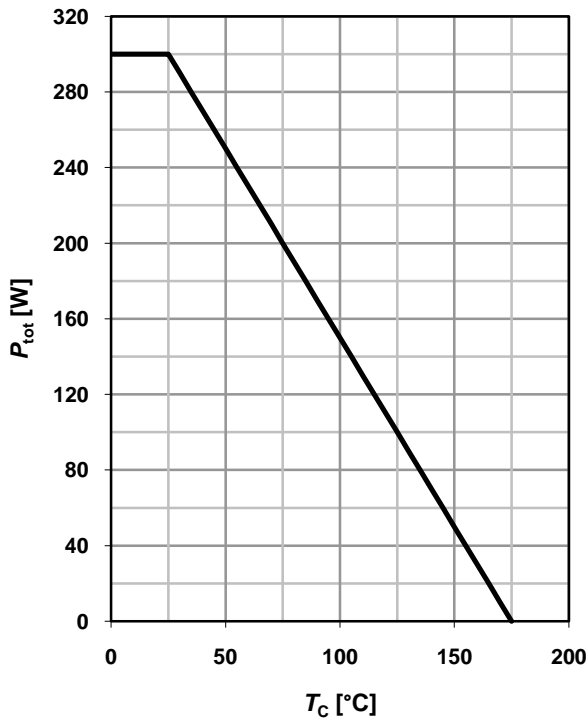

**2 Drain current**

$I_D=f(T_C); V_{GS} \geq 10\text{ V}$

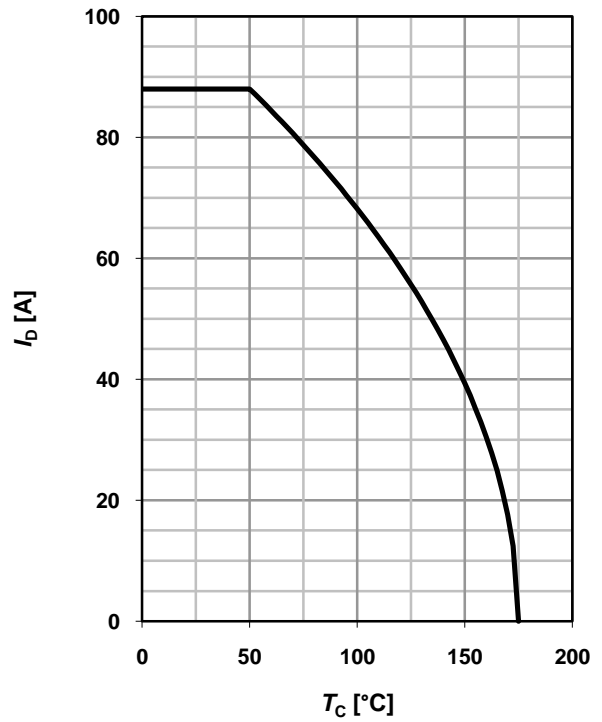

**3 Safe operating area**

$I_D=f(V_{DS}); T_C=25\text{ °C}; D=0$

parameter:  $t_p$

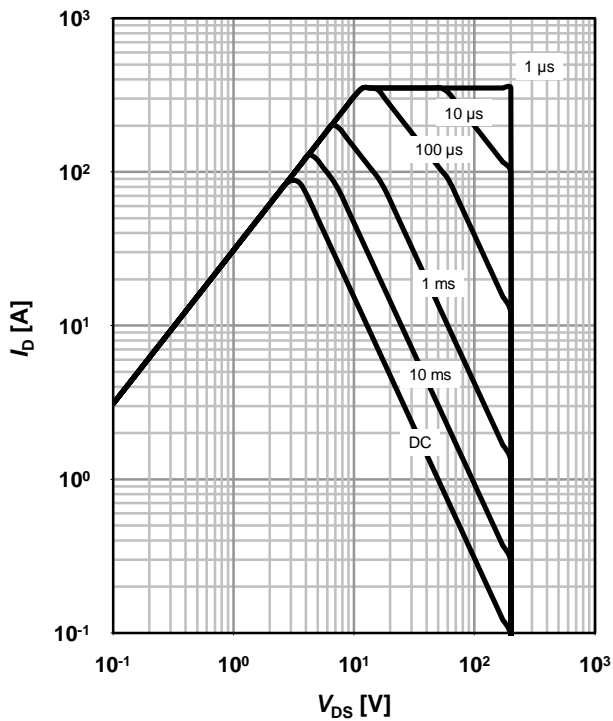

**4 Max. transient thermal impedance**

$Z_{thJC}=f(t_p)$

parameter:  $D=t_p/T$

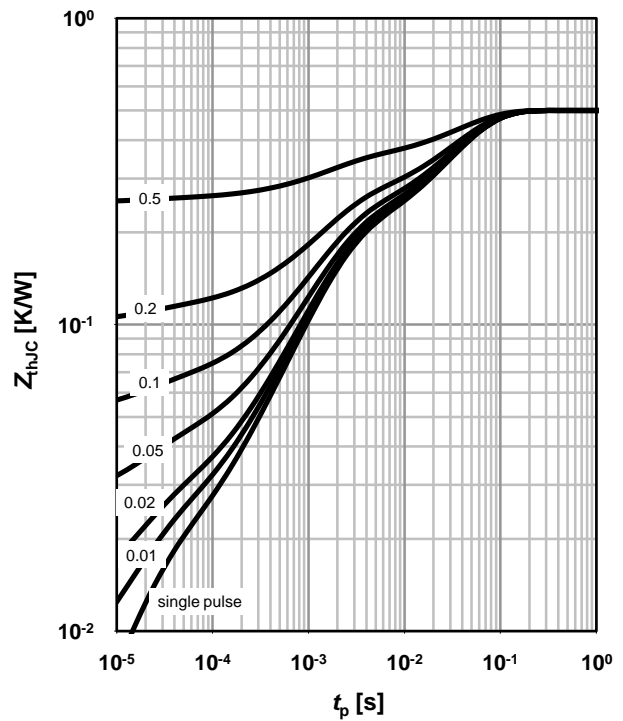

**5 Typ. output characteristics**

$I_D = f(V_{DS}); T_j = 25\text{ °C}$

parameter:  $V_{GS}$

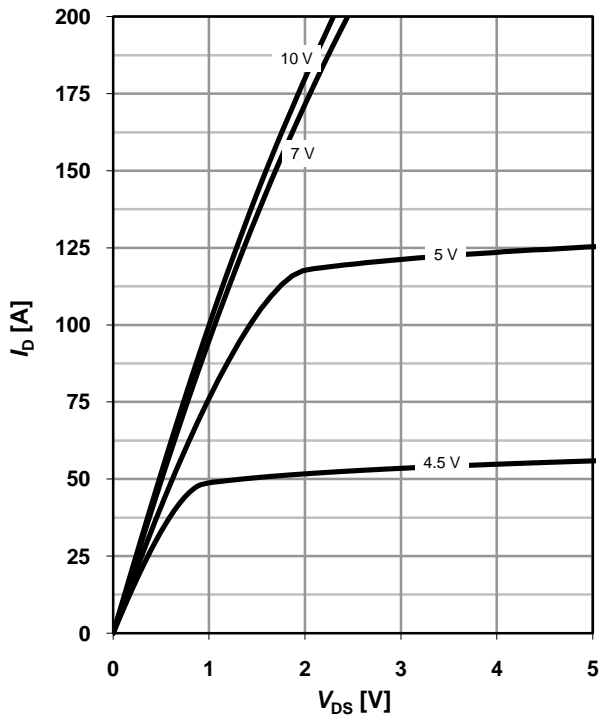

**6 Typ. drain-source on resistance**

$R_{DS(on)} = f(I_D); T_j = 25\text{ °C}$

parameter:  $V_{GS}$

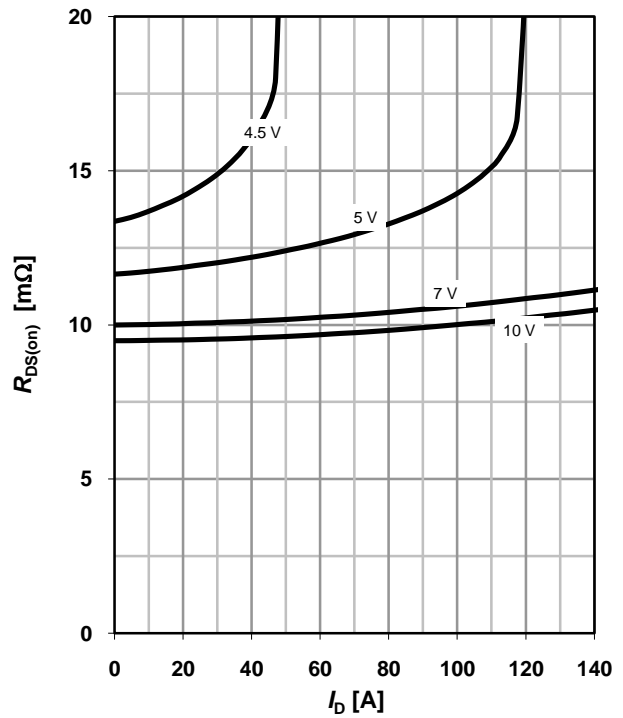

**7 Typ. transfer characteristics**

$I_D = f(V_{GS}); |V_{DS}| > 2|I_D|R_{DS(on)max}$

parameter:  $T_j$

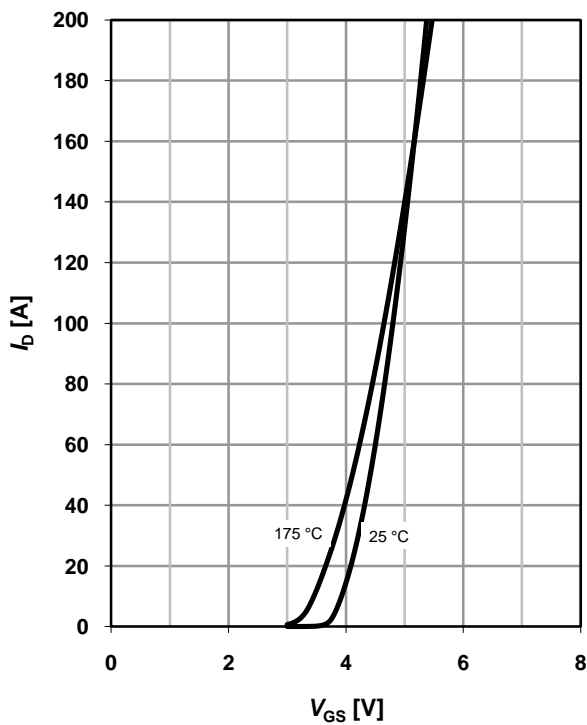

**8 Typ. forward transconductance**

$g_{fs} = f(I_D); T_j = 25\text{ °C}$

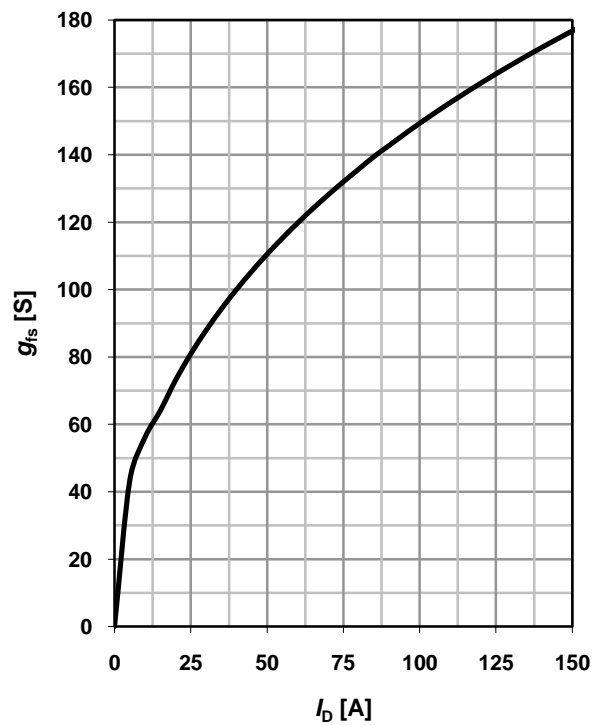

**9 Drain-source on-state resistance**

$R_{DS(on)}=f(T_j); I_D=88\text{ A}; V_{GS}=10\text{ V}$

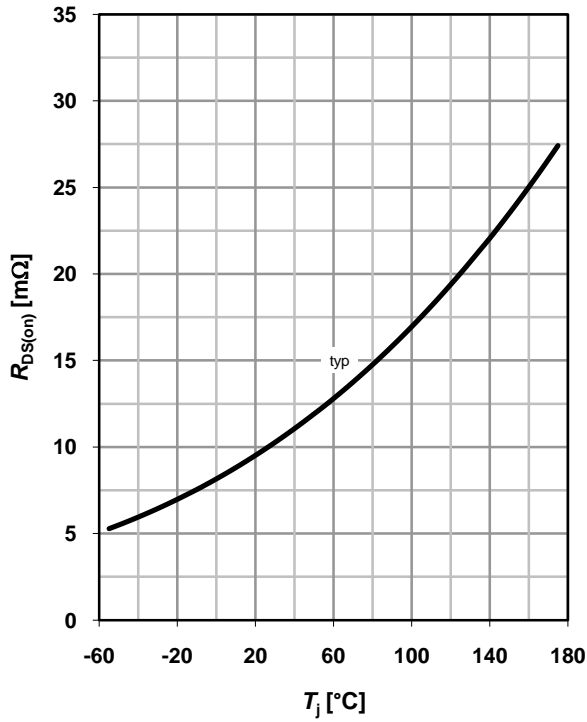

**10 Typ. gate threshold voltage**

$V_{GS(th)}=f(T_j); V_{GS}=V_{DS}$

parameter:  $I_D$

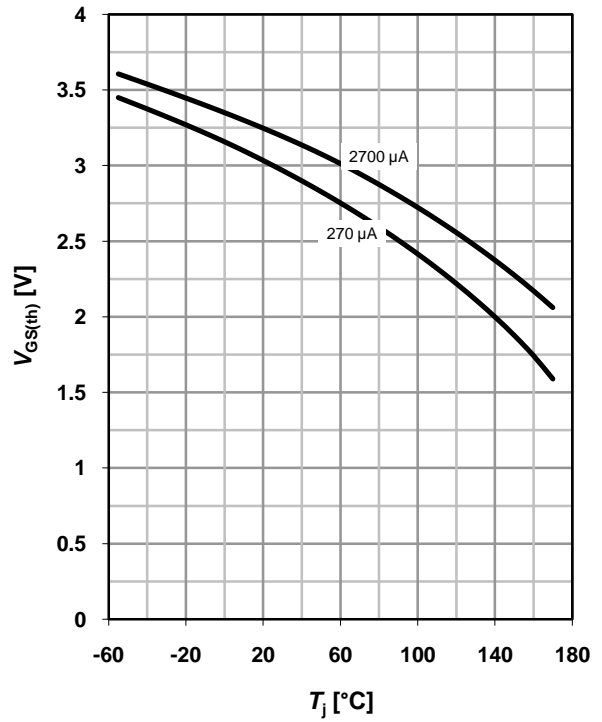

**11 Typ. capacitances**

$C=f(V_{DS}); V_{GS}=0\text{ V}; f=1\text{ MHz}$

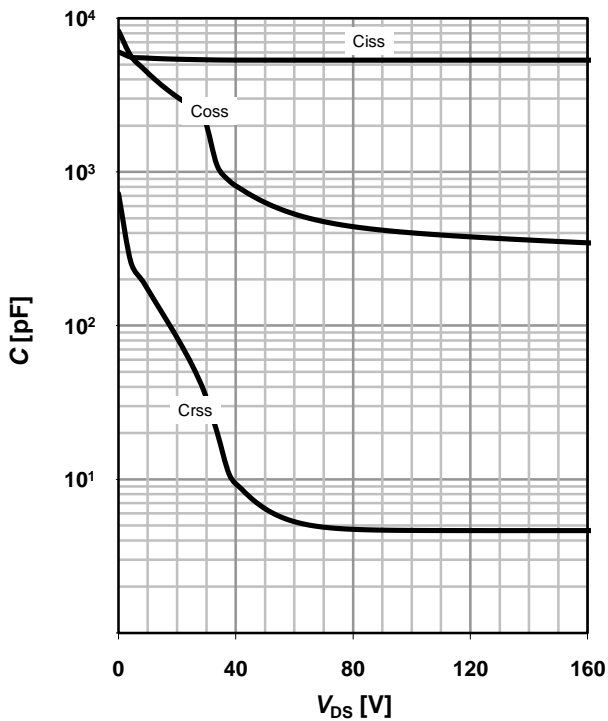

**12 Forward characteristics of reverse diode**

$I_F=f(V_{SD})$

parameter:  $T_j$

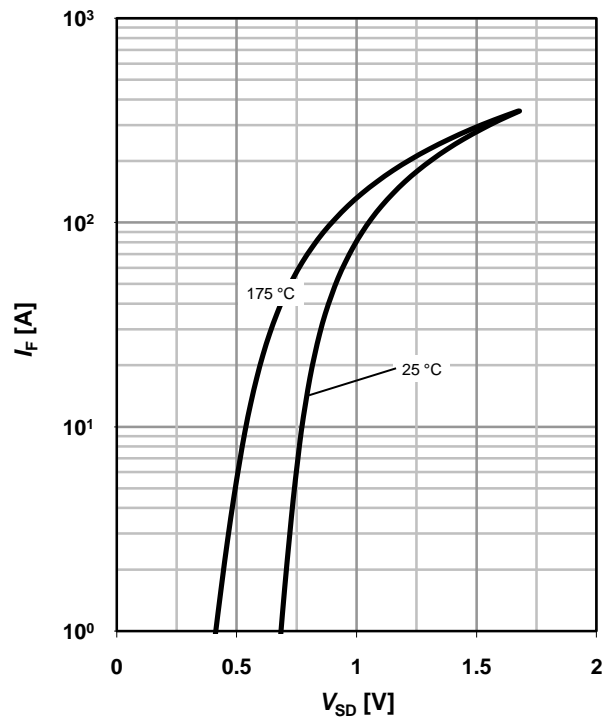

**13 Avalanche characteristics**

$I_{AS}=f(t_{AV}); R_{GS}=25 \Omega$

parameter:  $T_{j(\text{start})}$

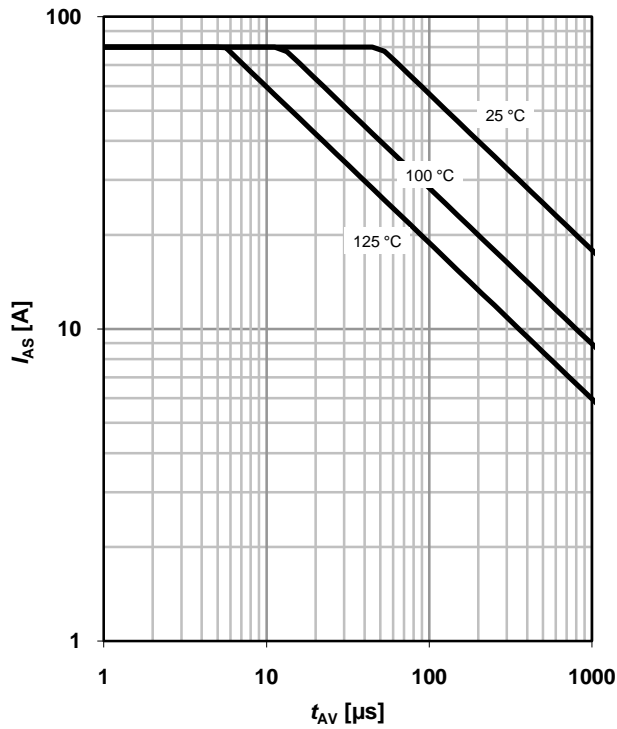

**14 Typ. gate charge**

$V_{GS}=f(Q_{\text{gate}}); I_D=44 \text{ A pulsed}$

parameter:  $V_{DD}$

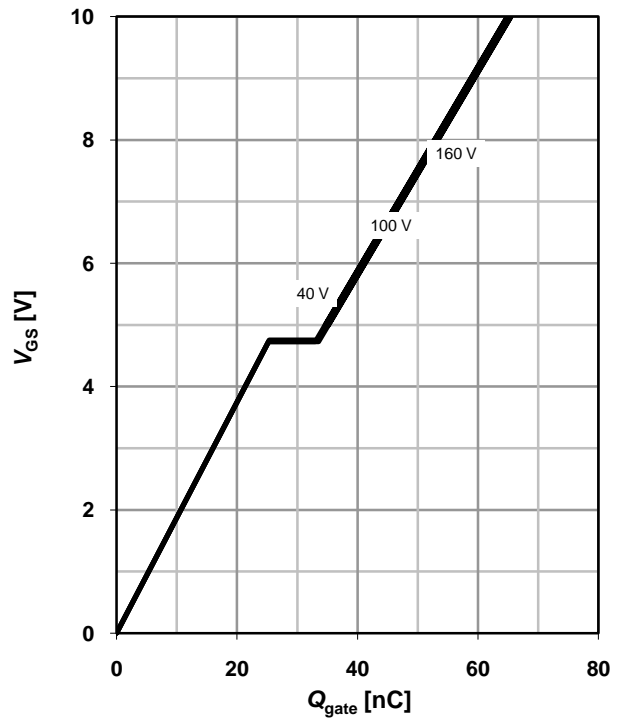

**15 Drain-source breakdown voltage**

$V_{BR(DSS)}=f(T_j); I_D=1 \text{ mA}$

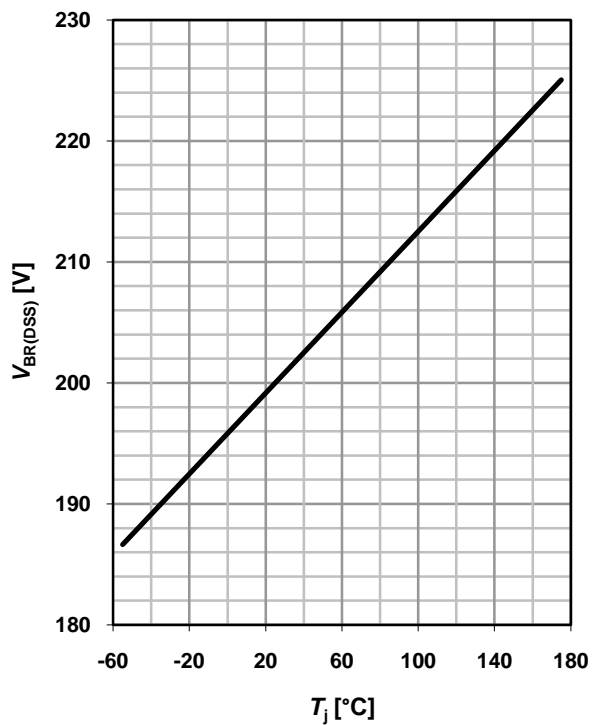

**16 Gate charge waveforms**

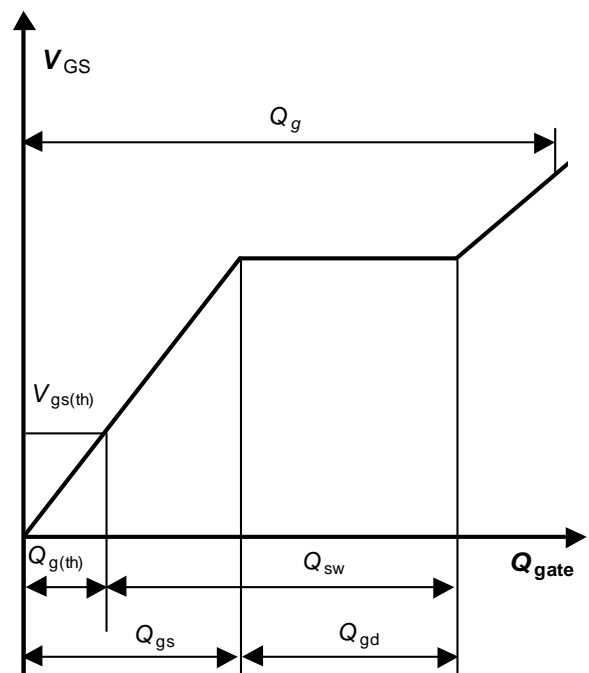

PG-TO220-3: Outline

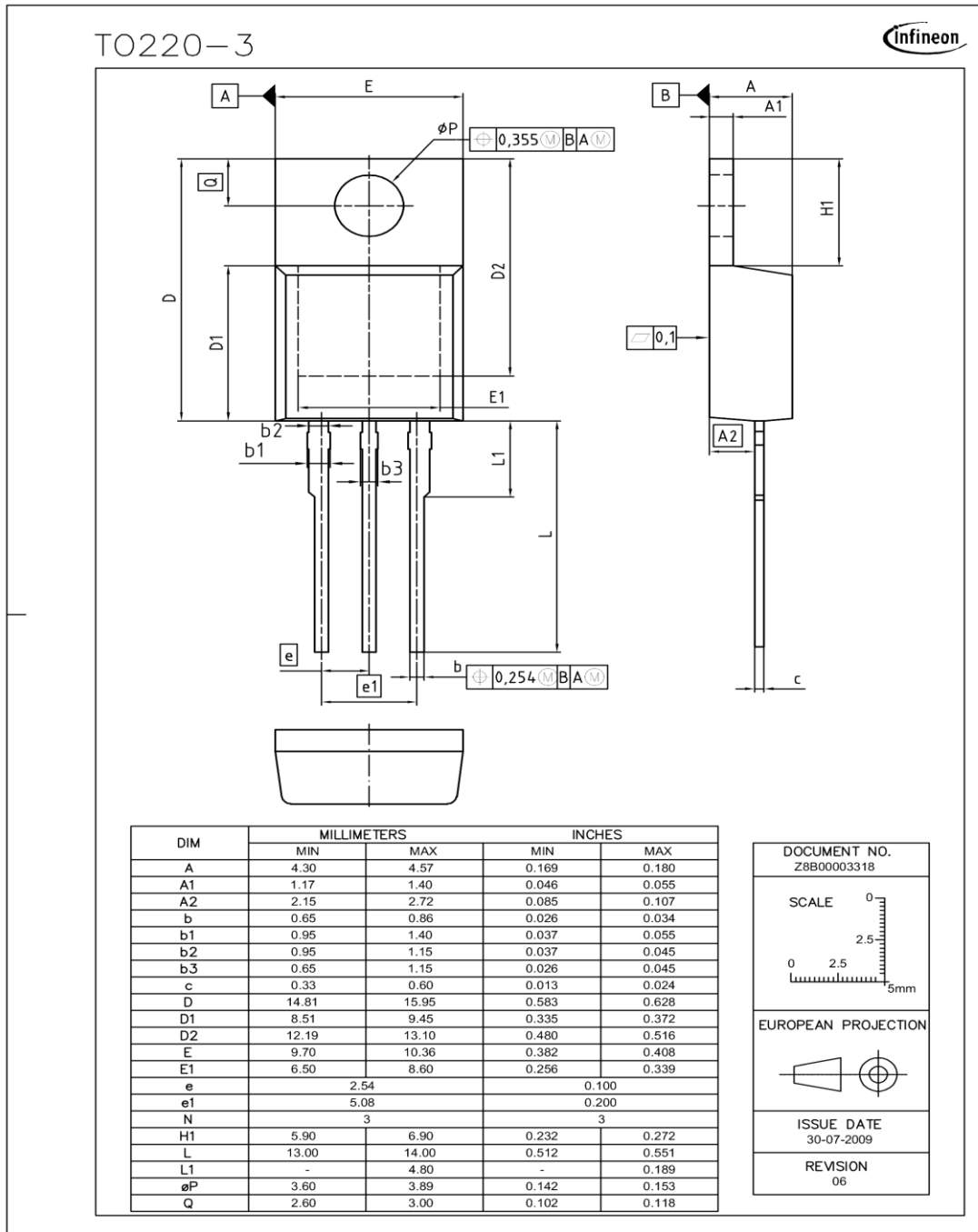

PG-TO263-3: Outline

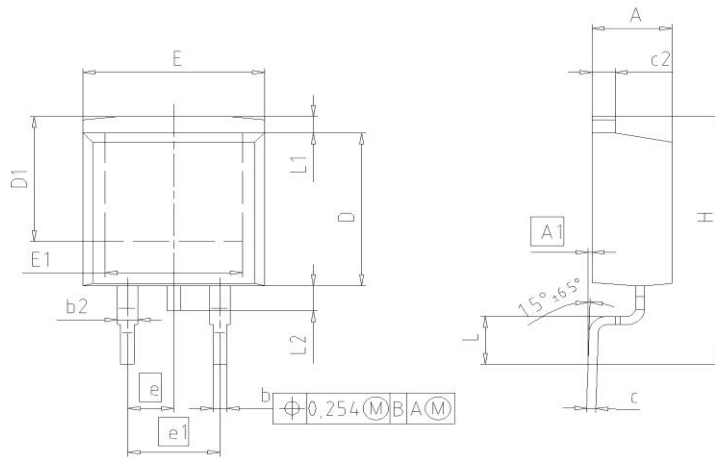

**FOOTPRINT**

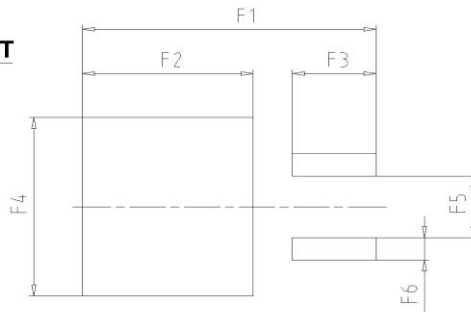

| DIM | MILLIMETERS |       | INCHES |       |
|-----|-------------|-------|--------|-------|
|     | MIN         | MAX   | MIN    | MAX   |
| A   | 4.30        | 4.57  | 0.169  | 0.180 |
| A1  | 0.00        | 0.25  | 0.000  | 0.010 |
| b   | 0.65        | 0.85  | 0.026  | 0.033 |
| b2  | 0.95        | 1.15  | 0.037  | 0.045 |
| c   | 0.33        | 0.65  | 0.013  | 0.026 |
| c2  | 1.17        | 1.40  | 0.046  | 0.055 |
| D   | 8.51        | 9.45  | 0.335  | 0.372 |
| D1  | 7.10        | 7.90  | 0.280  | 0.311 |
| E   | 9.80        | 10.31 | 0.386  | 0.406 |
| E1  | 6.50        | 8.60  | 0.256  | 0.339 |
| e   | 2.54        |       | 0.100  |       |
| e1  | 5.08        |       | 0.200  |       |
| N   | 2           |       | 2      |       |
| H   | 14.61       | 15.88 | 0.575  | 0.625 |
| L   | 2.29        | 3.00  | 0.090  | 0.118 |
| L1  | 0.70        | 1.60  | 0.028  | 0.063 |
| L2  | 1.00        | 1.78  | 0.039  | 0.070 |
| F1  | 16.05       | 16.25 | 0.632  | 0.640 |
| F2  | 9.30        | 9.50  | 0.366  | 0.374 |
| F3  | 4.50        | 4.70  | 0.177  | 0.185 |
| F4  | 10.70       | 10.90 | 0.421  | 0.429 |
| F5  | 3.65        | 3.85  | 0.144  | 0.152 |
| F6  | 1.25        | 1.45  | 0.049  | 0.057 |

**DOCUMENT NO.**  
Z8B00003324

**SCALE**

**EUROPEAN PROJECTION**

**ISSUE DATE**  
30-08-2007

**REVISION**  
01

**Published by**  
**Infineon Technologies AG**  
**81726 Munich, Germany**  
**© 2011 Infineon Technologies AG**  
**All Rights Reserved.**

**Legal Disclaimer**

The information given in this document shall in no event be regarded as a guarantee of conditions or characteristics. With respect to any examples or hints given herein, any typical values stated herein and/or any information regarding the application of the device, Infineon Technologies hereby disclaims any and all warranties and liabilities of any kind, including without limitation, warranties of non-infringement of intellectual property rights of any third party.



**Information**

For further information on technology, delivery terms and conditions and prices, please contact the nearest Infineon Technologies Office ([www.infineon.com](http://www.infineon.com)).



on the types in question, please contact the nearest Infineon Technologies Office. Infineon Technologies components may be used in life-support devices or systems only with the express written approval of Infineon Technologies, if a failure of such components can reasonably be expected to cause the failure of that life-support device or system or to affect the safety or effectiveness of that device or system. Life support devices or systems are intended to be implanted in the human body or to support and/or maintain and sustain and/or protect human life. If they fail, it is reasonable to assume that the health of the user or other persons may be endangered.

## Looking for pricing, stock, or lifecycle information?

Click below to explore more details on WIN SOURCE:

-  [View IPP110N20NAAKSA1](#) on WIN SOURCE
-  [Infineon Technologies](#) Information

## Optimize Your Supply Chain with WIN SOURCE Solutions

-  Global Sourcing Solution
-  Obsolete Management
-  Cost Control Management
-  Shortage Management
-  Alternative Solution
-  Excess Inventory Management