



**THE DATASHEET OF  
MMBZ5236BW**



ZENER DIODE

**FEATURES:**

- Planar Die Construction
- 200mW Power Dissipation on FR-4 PCB
- General purpose, Medium Current
- Ideally Suited for Automated Assembly
- P/N suffix V means AEC-Q101 qualified, e.g:MMBZ5221BWV
- P/N suffix V means Halogen-free

Marking: see table on page2 The first code

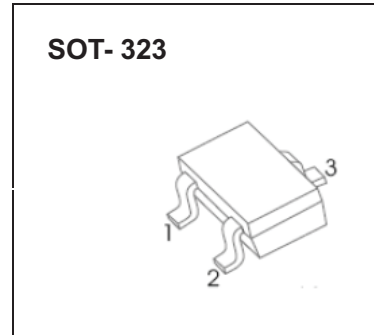
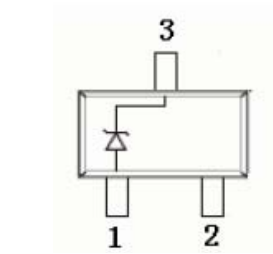

**Maximum Ratings(T<sub>a</sub>= 25°C unless otherwise specified)**

| Characteristic                              | Symbol           | Value      | Unit |
|---|------------------|------------|------|
| Forward Voltage @ I <sub>F</sub> = 10mA     | V <sub>F</sub>   | 0.9        | V    |
| Power Dissipation                           | P <sub>D</sub>   | 200        | mW   |
| Thermal Resistance, Junction to Ambient Air | R <sub>θJA</sub> | 625        | °C/W |
| Junction Temperature                        | T <sub>j</sub>   | -55 ~ +150 | °C   |
| Storage Temperature Range                   | T <sub>stg</sub> | -55 ~ +150 | °C   |

## ELECTRICAL CHARACTERISTICS $T_a=25^{\circ}\text{C}$ unless otherwise specified

| Type Number | Marking Code | Zener Voltage Range (Note 1) |         |         | Test Current | Maximum Zener Impedance (Note 2) |                                   | Maximum Reverse Leakage Current (Note 1) |         |
|-------------|--------------|------------------------------|---------|---------|--------------|----------------------------------|-----------------------------------|--|---------|
|             |              | $V_z @ I_{zT}$               |         |         | $I_{zT}$     | $Z_{zT} @ I_{zT}$                | $Z_{zK} @ I_{zK} = 0.25\text{mA}$ | $I_R$                                    | @ $V_R$ |
|             |              | Nom (V)                      | Min (V) | Max (V) | mA           | $\Omega$                         |                                   | $\mu\text{A}$                            | V       |
| MMBZ5221BW  | KC1          | 2.4                          | 2.28    | 2.52    | 20           | 30                               | 1200                              | 100                                      | 1.0     |
| MMBZ5222BW  | KC2          | 2.5                          | 2.38    | 2.63    | 20           | 30                               | 1250                              | 100                                      | 1.0     |
| MMBZ5223BW  | KC3          | 2.7                          | 2.57    | 2.84    | 20           | 30                               | 1300                              | 75                                       | 1.0     |
| MMBZ5225BW  | KC5          | 3.0                          | 2.85    | 3.15    | 20           | 30                               | 1600                              | 50                                       | 1.0     |
| MMBZ5226BW  | KG1          | 3.3                          | 3.14    | 3.47    | 20           | 28                               | 1600                              | 25                                       | 1.0     |
| MMBZ5227BW  | KG2          | 3.6                          | 3.42    | 3.78    | 20           | 24                               | 1700                              | 15                                       | 1.0     |
| MMBZ5228BW  | KG3          | 3.9                          | 3.71    | 4.10    | 20           | 23                               | 1900                              | 10                                       | 1.0     |
| MMBZ5229BW  | KG4          | 4.3                          | 4.09    | 4.52    | 20           | 22                               | 2000                              | 5.0                                      | 1.0     |
| MMBZ5230BW  | KG5          | 4.7                          | 4.47    | 4.94    | 20           | 19                               | 1900                              | 5.0                                      | 2.0     |
| MMBZ5231BW  | KE1          | 5.1                          | 4.85    | 5.36    | 20           | 17                               | 1600                              | 5.0                                      | 2.0     |
| MMBZ5232BW  | KE2          | 5.6                          | 5.32    | 5.88    | 20           | 11                               | 1600                              | 5.0                                      | 3.0     |
| MMBZ5233BW  | KE3          | 6.0                          | 5.70    | 6.30    | 20           | 7                                | 1600                              | 5.0                                      | 3.5     |
| MMBZ5234BW  | KE4          | 6.2                          | 5.89    | 6.51    | 20           | 7                                | 1000                              | 5.0                                      | 4.0     |
| MMBZ5235BW  | KE5          | 6.8                          | 6.46    | 7.14    | 20           | 5                                | 750                               | 3.0                                      | 5.0     |
| MMBZ5236BW  | KF1          | 7.5                          | 7.13    | 7.88    | 20           | 6                                | 500                               | 3.0                                      | 6.0     |
| MMBZ5237BW  | KF2          | 8.2                          | 7.79    | 8.61    | 20           | 8                                | 500                               | 3.0                                      | 6.5     |
| MMBZ5238BW  | KF3          | 8.7                          | 8.27    | 9.14    | 20           | 8                                | 600                               | 3.0                                      | 6.5     |
| MMBZ5239BW  | KF4          | 9.1                          | 8.65    | 9.56    | 20           | 10                               | 600                               | 3.0                                      | 7.0     |
| MMBZ5240BW  | KF5          | 10                           | 9.50    | 10.50   | 20           | 17                               | 600                               | 3.0                                      | 8.0     |
| MMBZ5241BW  | KH1          | 11                           | 10.45   | 11.55   | 20           | 22                               | 600                               | 2.0                                      | 8.4     |
| MMBZ5242BW  | KH2          | 12                           | 11.40   | 12.60   | 20           | 30                               | 600                               | 1.0                                      | 9.1     |
| MMBZ5243BW  | KH3          | 13                           | 12.35   | 13.65   | 9.5          | 13                               | 600                               | 0.5                                      | 9.9     |
| MMBZ5244BW  | KH4          | 14                           | 13.30   | 14.70   | 9.0          | 15                               | 600                               | 0.1                                      | 10      |
| MMBZ5245BW  | KH5          | 15                           | 14.25   | 15.75   | 8.5          | 16                               | 600                               | 0.1                                      | 11      |
| MMBZ5246BW  | KJ1          | 16                           | 15.20   | 16.80   | 7.8          | 17                               | 600                               | 0.1                                      | 12      |
| MMBA5247BW  | KJ2          | 17                           | 16.15   | 17.85   | 7.4          | 19                               | 600                               | 0.1                                      | 13      |
| MMBZ5248BW  | KJ3          | 18                           | 17.10   | 18.90   | 7.0          | 21                               | 600                               | 0.1                                      | 14      |
| MMBZ5249BW  | KJ4          | 19                           | 18.05   | 19.95   | 6.6          | 23                               | 600                               | 0.1                                      | 14      |
| MMBZ5250BW  | KJ5          | 20                           | 19.00   | 21.00   | 6.2          | 25                               | 600                               | 0.1                                      | 15      |
| MMBZ5251BW  | KK1          | 22                           | 20.90   | 23.10   | 5.6          | 29                               | 600                               | 0.1                                      | 17      |
| MMBZ5252BW  | KK2          | 24                           | 22.80   | 25.20   | 5.2          | 33                               | 600                               | 0.1                                      | 18      |
| MMBZ5253BW  | KK3          | 25                           | 23.75   | 26.25   | 5.0          | 35                               | 600                               | 0.1                                      | 19      |
| MMBZ5254BW  | KK4          | 27                           | 25.65   | 28.35   | 5.0          | 41                               | 600                               | 0.1                                      | 21      |
| MMBZ5255BW  | KK5          | 28                           | 26.60   | 29.40   | 4.5          | 44                               | 600                               | 0.1                                      | 21      |
| MMBZ5256BW  | KM1          | 30                           | 28.50   | 31.50   | 4.2          | 49                               | 600                               | 0.1                                      | 23      |
| MMBZ5257BW  | KM2          | 33                           | 31.35   | 34.65   | 3.8          | 58                               | 700                               | 0.1                                      | 25      |
| MMBZ5258BW  | KM3          | 36                           | 34.20   | 37.80   | 3.4          | 70                               | 700                               | 0.1                                      | 27      |
| MMBZ5259BW  | KM4          | 39                           | 37.05   | 40.95   | 3.2          | 80                               | 800                               | 0.1                                      | 30      |

Notes: 1. Short duration test pulse used to minimize self-heating effect.  
2.  $f = 1\text{KHz}$ .

# RATING AND CHARACTERISTICS CURVES (MMBZ5221BW THRU MMBZ5259BW)

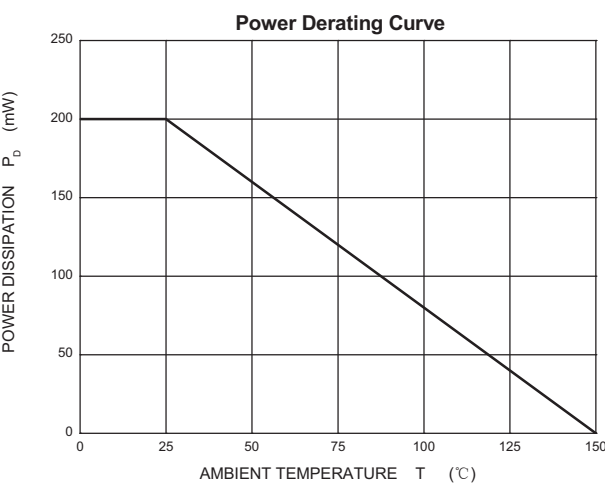
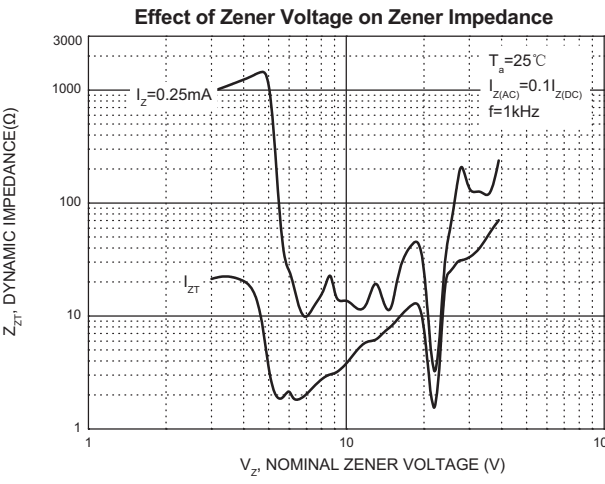
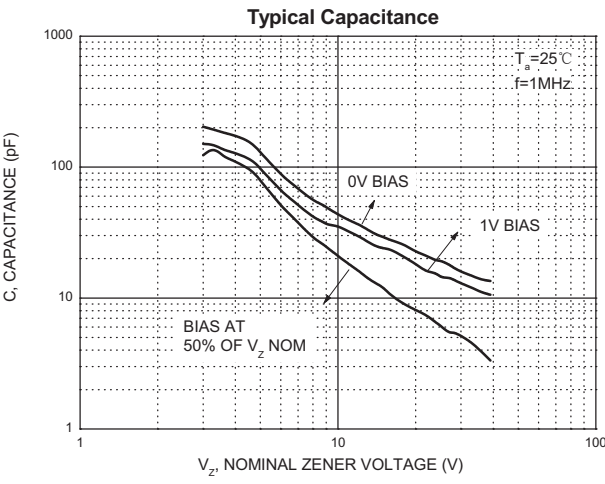
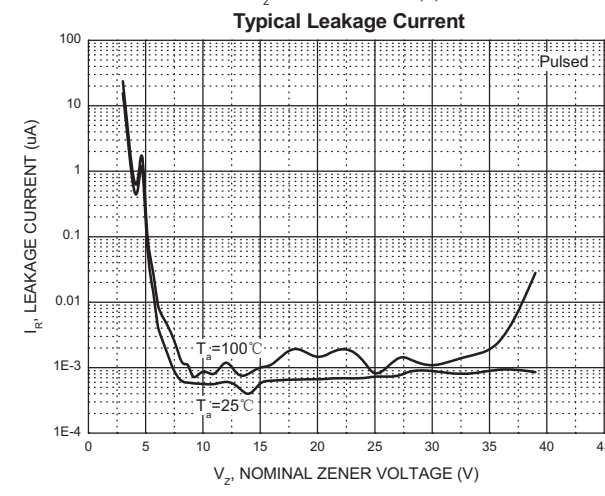
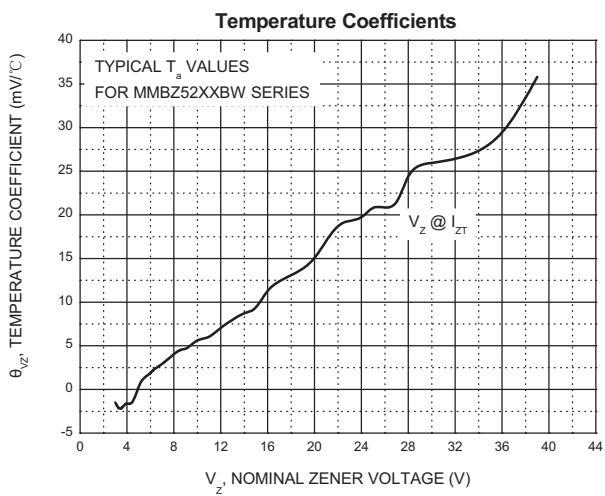
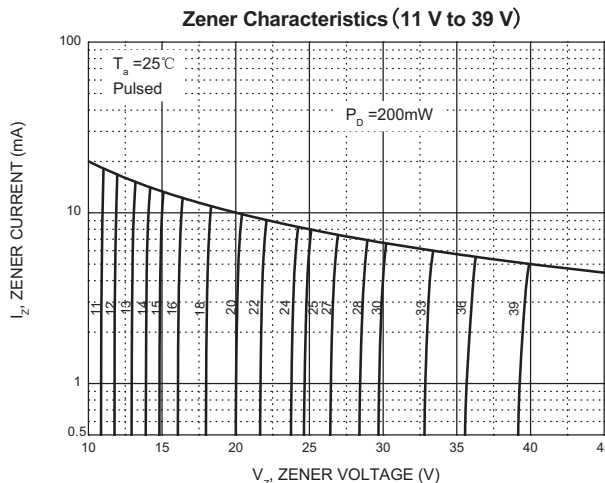
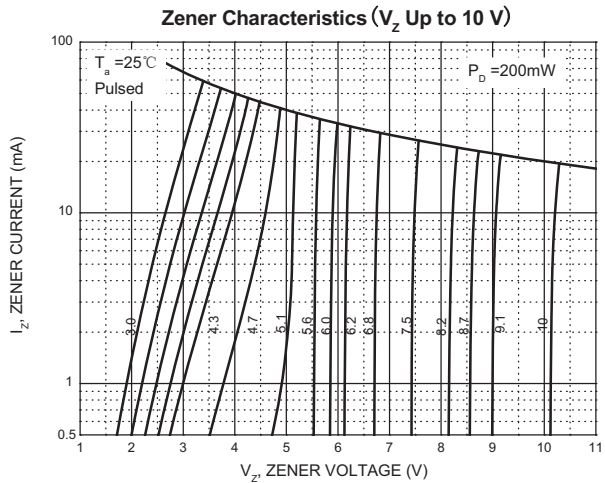

## SOT-323 Package Outline Dimensions

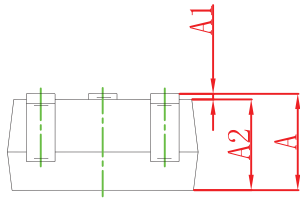
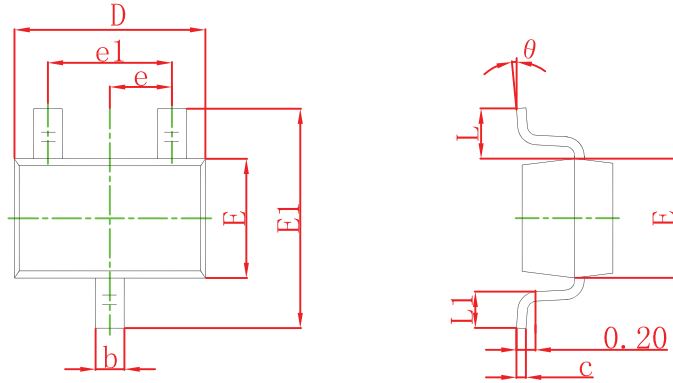

| Symbol   | Dimensions In Millimeters |       | Dimensions In Inches |       |
|----------|---------------------------|-------|----------------------|-------|
|          | Min                       | Max   | Min                  | Max   |
| A        | 0.900                     | 1.100 | 0.035                | 0.043 |
| A1       | 0.000                     | 0.100 | 0.000                | 0.004 |
| A2       | 0.900                     | 1.000 | 0.035                | 0.039 |
| b        | 0.200                     | 0.400 | 0.008                | 0.016 |
| c        | 0.080                     | 0.150 | 0.003                | 0.006 |
| D        | 2.000                     | 2.200 | 0.079                | 0.087 |
| E        | 1.150                     | 1.350 | 0.045                | 0.053 |
| E1       | 2.150                     | 2.450 | 0.085                | 0.096 |
| e        | 0.650 TYP                 |       | 0.026 TYP            |       |
| e1       | 1.200                     | 1.400 | 0.047                | 0.055 |
| L        | 0.525 REF                 |       | 0.021 REF            |       |
| L1       | 0.260                     | 0.460 | 0.010                | 0.018 |
| $\theta$ | 0°                        | 8°    | 0°                   | 8°    |

## SOT-323 Suggested Pad Layout

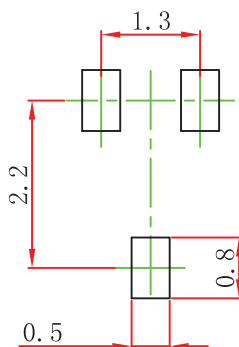

- Note:
1. Controlling dimension: in millimeters.
  2. General tolerance:  $\pm 0.05$  mm.
  3. The pad layout is for reference purposes only.

# SOT-323 Tape and Reel

## SOT-323 Embossed Carrier Tape

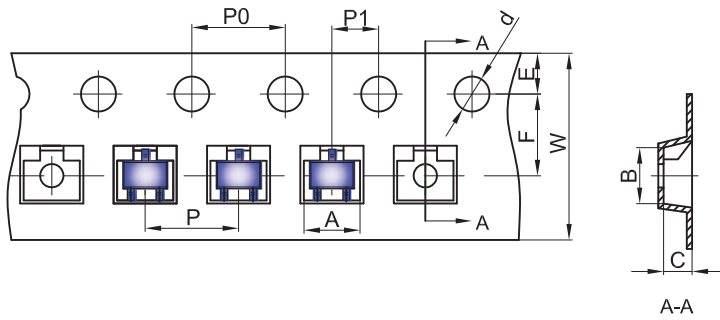

**Packaging Description:**  
 SOT-323 parts are shipped in tape. The carrier tape is made from a dissipative (carbon filled) polycarbonate resin. The cover tape is a multilayer film (Heat Activated Adhesive in nature) primarily composed of polyester film, adhesive layer, sealant, and anti-static sprayed agent. These reeled parts in standard option are shipped with 3,000 units per 7" or 17.8cm diameter reel. The reels are clear in color and is made of polystyrene plastic (anti-static coated).

| Dimensions are in millimeter |      |      |      |       |      |      |      |      |      |      |
|------------------------------|------|------|------|-------|------|------|------|------|------|------|
| Pkg type                     | A    | B    | C    | d     | E    | F    | P0   | P    | P1   | W    |
| SOT-323                      | 2.25 | 2.55 | 1.19 | Ø1.55 | 1.75 | 3.50 | 4.00 | 4.00 | 2.00 | 8.00 |

## SOT-323 Tape Leader and Trailer

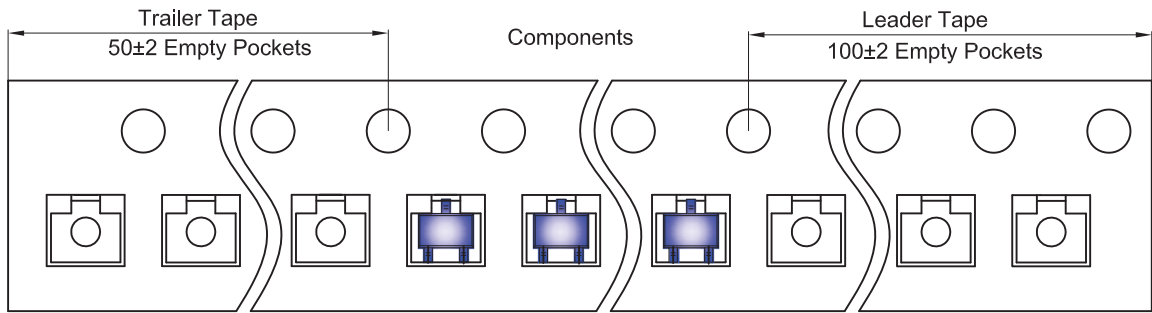

## SOT-323 Reel

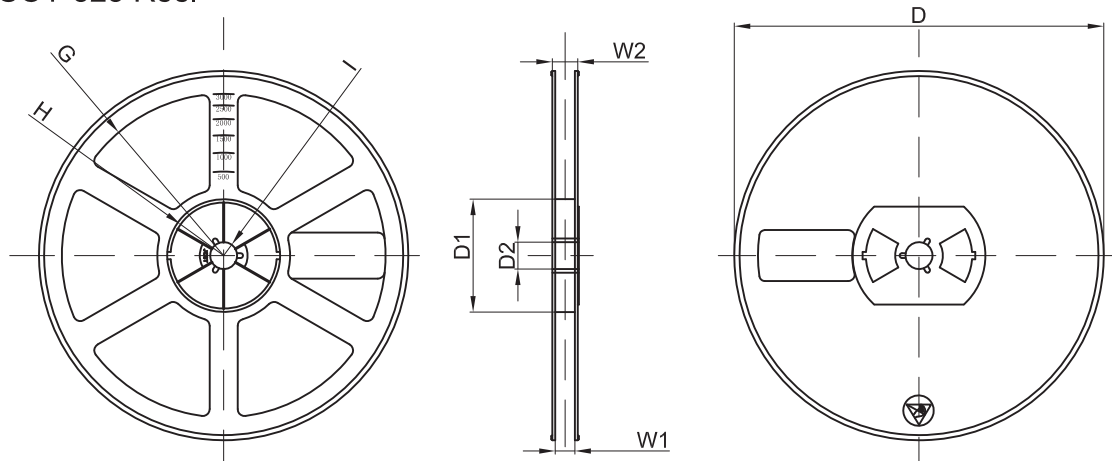

| Dimensions are in millimeter |         |       |       |        |        |       |      |       |
|------------------------------|---------|-------|-------|--------|--------|-------|------|-------|
| Reel Option                  | D       | D1    | D2    | G      | H      | I     | W1   | W2    |
| 7" Dia                       | Ø178.00 | 54.40 | 13.00 | R78.00 | R25.60 | R6.50 | 9.50 | 12.30 |

| REEL     | Reel Size | Box        | Box Size(mm) | Carton      | Carton Size(mm) | G.W.(kg) |
|----------|-----------|------------|--------------|-------------|-----------------|----------|
| 3000 pcs | 7 inch    | 45,000 pcs | 203×203×195  | 180,000 pcs | 438×438×220     |          |

## DISCLAIMER NOTICE

Rectron Inc reserves the right to make changes without notice to any product specification herein, to make corrections, modifications, enhancements or other changes. Rectron Inc or anyone on its behalf assumes no responsibility or liability for any errors or inaccuracies. Data sheet specifications and its information contained are intended to provide a product description only. "Typical" parameters which may be included on RECTRON data sheets and/ or specifications can and do vary in different applications and actual performance may vary over time. Rectron Inc does not assume any liability arising out of the application or use of any product or circuit.

Rectron products are not designed, intended or authorized for use in medical, life-saving implant or other applications intended for life-sustaining or other related applications where a failure or malfunction of component or circuitry may directly or indirectly cause injury or threaten a life without expressed written approval of Rectron Inc. Customers using or selling Rectron components for use in such applications do so at their own risk and shall agree to fully indemnify Rectron Inc and its subsidiaries harmless against all claims, damages and expenditures.

## Looking for pricing, stock, or lifecycle information?

Click below to explore more details on WIN SOURCE:

 [View MMBZ5236BW](#) on WIN SOURCE

 [Rectron USA](#) Information

## Optimize Your Supply Chain with WIN SOURCE Solutions

-  Global Sourcing Solution
-  Obsolete Management
-  Cost Control Management
-  Shortage Management
-  Alternative Solution
-  Excess Inventory Management